



अरुणाचल प्रदेश विश्वविद्यालय
ARUNACHAL PRADESH UNIVERSITY

PROSPECTUS

• 2026-27 •



www.apupsg.ac.in



अरुणाचलप्रदेशविश्वविद्यालय

ARUNACHAL PRADESH UNIVERSITY

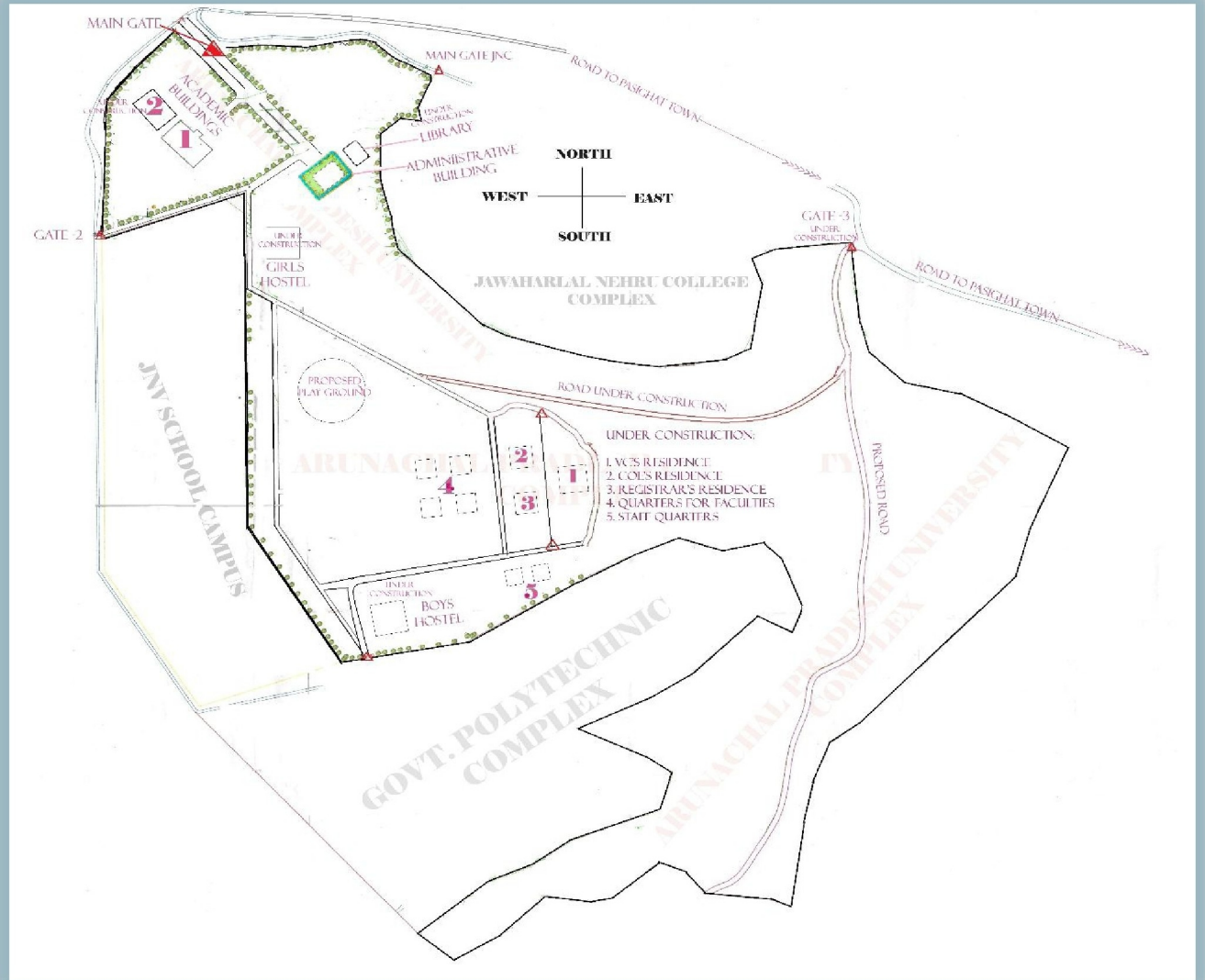

**ARUNACHAL PRADESH
UNIVERSITY MAP**

The Motto

ज्ञानम्परमंबलम्

“Knowledge is Supreme Power”

“Knowledge empowers individuals with understanding, wisdom, and the ability to overcome challenges, making it the ultimate force that drives progress and success.”

The Vision

A leading institution for excellence in knowledge, culture and human development.

The Mission

- The University shall endeavour through research, education, training and extension to play a positive role in the socio-economic development and promotion of the cultural heritage of the state of Arunachal Pradesh.
- The University shall produce a group of intellectuals who are ethically and morally high.
- The University shall give Service to society through knowledge and its proper application.

The Statutory Officers of the University



Lt. Gen. Kaiwalya Trivikram Parnaik

Chancellor & His Excellency, the Governor of Arunachal Pradesh.

Phone: 0360-2212442

Fax: 0360-22124542



Dr. Milorai Modi

Vice-Chancellor

Mobile: +91-9863709095

E-mail:vc@apupsg.ac.in



Shri Narmi Darang

Registrar

Mobile: +91-9378059530

E-mail:registrar@apupsg.ac.in



Dr Monshi Tayeng

Controller Of Examination

Mobile: +91-8732098296

E-mail:coe@apupsg.ac.in

Message from the Honourable Vice-Chancellor

Dear Prospective Students,

It gives me immense pleasure to welcome you to Arunachal Pradesh University, the first and lone State University of Arunachal Pradesh. As the first State University, we carry a special responsibility to uphold the highest standards of teaching, learning, and research. While drawing strength from the unique cultural heritage and diversity of our region, our endeavour is to create an academic environment that promotes intellectual inquiry, encourages interdisciplinary engagement, and equip our students with the knowledge, skills, and perspectives necessary to contribute meaningfully to society and the nation.



Under the aegis of our visionary Chancellor, Lt. General Kaiwalya Trivikram Parnaik, and with the committed efforts of the Registrar, the Controller of Examinations, our experienced faculty members, and dedicated staff, the University has witnessed remarkable growth since its establishment. Today, it offers academic programmes through departments such as Commerce, Computer Science, Economics, Education, English, Hindi, Mass Communication, Mathematics, Social Work, Sociology, Tribal Studies, and other emerging disciplines.

As you embark on your educational journey with us, I encourage you to make the most of the opportunities available. Engage actively in classroom discussions, research projects, seminars, extension activities, and community outreach programmes. The knowledge and experiences you gain here will not only prepare you for professional success but will also help you become responsible and compassionate citizens.

I am confident that your association with Arunachal Pradesh University will be enriching, transformative, and memorable. May your years at the University be filled with learning, discovery, achievement, and lifelong friendships that inspire you to make a positive contribution to society.

I warmly welcome you to our academic community and wish you every success in your pursuit of knowledge, excellence, and service to humanity.

A handwritten signature in black ink, appearing to be 'Milorai Modi'.

Dr. Milorai Modi
Vice Chancellor

TABLE OF CONTENTS

Particular	Page No.
The Statutory Officers of the University	
Message from the Honourable Vice Chancellor	
Introduction	1
The Objectives	1-2
Location	2
Academic calendar for the session: 2026-27	3-6
Committees and Cells	7-9
Academic Departments (Teaching Faculties, Course structure & Fee structure)	10-92
Admission to Various Academic Courses	93
Eligibility Criteria to Take Admission in Different Courses	93-94
Mode of Selection	94-95
Reservation	95
Relaxation	95
Documents to be Submitted for Admission	95-96
Verification of Students' Academic and Personal Testimonials	96-97
Remittance and Refund of Fees	97
Eligibility for Admission to Examinations	98
Examination and Evaluation (NEP)	98
Incentive marks for attendance	98-99
Continuous Evaluation and Internal Assessment	99
The Minimum Pass Mark/Back Paper and Improvement	99-101
Letter Grades and Grade Points Computation (SGPA and CGPA)	101-103
Medium of Instruction in the Examinations	104-105
Disqualification from Appearing in Examinations	105
Special Arrangement for Sick Examinees	105-106
Special Arrangement for Amanuensis (Writer/Scribe)	106
Restriction on Two Regular Courses	106
Registration and Renewal of Registration	106
Punishment for Unlawful Acts During Examinations	106
Ph. D Programmes	107-109
Anti-Ragging Declaration and Mandatory Online Registration	109-110
Anti-Tobacco Policy	110
Non-Teaching staffs of the University	111-113
List of Gazetted Holidays from the year 2025	113

Introduction:

The Arunachal Pradesh University, located in Pasighat is the lone State University of Arunachal Pradesh, which was established on 1st July 2022 under the Arunachal Pradesh University Act, 2012 (Act 5 of 2012) passed by the State Legislative Assembly of Arunachal Pradesh vide notification No. LAW/LEGN-13/2012, dated 16 April 2012.

The University is recognised under Section 2(f) of the UGC Act, 1956 by UGC vide its recognition letter F.No.9-11/2022 (CPP-I/PU), dated 21 July 2022 and is empowered to award degrees by the UGC as specified under Section 22 of the UGC Act, 1956, by conducting courses through its own departments, its constituent colleges, and/or through the affiliated colleges in regular mode with the approval of the concern Statutory Bodies and Statutory Councils, wherever it is required.

The University operates within the territorial jurisdiction of Arunachal Pradesh and is empowered to give affiliation to Higher Education Institutions (HEIs) in Arunachal Pradesh as per the Arunachal Pradesh University Act, 2012. Arunachal Pradesh University offers a postgraduate and doctoral programme across various disciplines, including commerce and social sciences.

The Objectives:

The objective of the University shall be to disseminate and advance knowledge by providing instructional and research facilities in such branches of learning as it may deem fit, and endeavour through research, education, training and extension to play a positive role in the socio-economic and cultural development of Arunachal Pradesh and in particular the objectives set up in the first Schedule of the University Act. The logo of the University carries the Sanskrit verse, “*Gyanam Paramam Balam*” meaning “*Knowledge is the Supreme Power*”. Towards this, it shall undertake:

- i. To strengthen and diversify certificate and diploma courses related to the needs of employment, and building the economy of the region on the basis of its natural resources;
- ii. To introduce relevant undergraduate courses for enhancing knowledge and skills;
- iii. To provide education and training in the various arts, crafts and skills of the region raising their quality, and improving their availability to the people;
- iv. To provide or arrange training of teachers required for such activities or institutions;
- v. To provide training and other facilities to equip persons for different categories of jobs;
- vi. To provide suitable Postgraduate courses of study;

- vii. To undertake and organise research to develop the creative potential of its people, optimal use of the resources of the territory particularly that which is related to regional development; and
- viii. To provide counselling, guidance, and facilities for helping in the placement of students.

In furtherance of the fulfilment of the above objectives and activities, the University shall function in close collaboration with the State Government and concerned institutions in the State and the country.

The above Motto, Vision, Mission, and Objectives of Arunachal Pradesh University have been prepared in tune with the Arunachal Pradesh University Act, 2012 and was approved in the First Executive Council Meeting held on 23 May 2023.

Location:

The Arunachal Pradesh University, Pasighat is located at 28° 08' N latitude and 95° 30' E longitude, on the right bank of the Siang River (Brahmaputra), Pasighat, East Siang District, Arunachal Pradesh. APU shares its boundary wall with the Jawaharlal Nehru College, the oldest college of the state, established in the year 1964, on Hill Top.

The University is well connected with all-weather roads from East, West, North, and South directions. One can reach Pasighat from Dibrugarh by the Dola-Sadiya Bridge (Bhupen Hazarika Setu), the longest bridge in India via Roing from the East, Aalo in the North, Jonai district of Assam in the South, and Basar in the West. Pasighat - the oldest city of the state is well connected to Guwahati, the capital of Assam, and Itanagar, the capital city of Arunachal Pradesh through National Highway 515. It is connected to Dibrugarh by Bogibeel Bridge over Brahmaputra via Silapathar. Within the city, there is an airport that connects Donyi-Polo Airport in Itanagar, and Lokpriya Gopinath Bordoloi International Airport in Guwahati. The nearest railway station is at Murkong Seleik, just 40 kms from Pasighat.

Pasighat is often considered as the best-connected city in the state of Arunachal Pradesh and has been declared as one of the Smart Cities of the state. Pasighat is also known as the rice bowl of Arunachal Pradesh and is famous for organic fruits and vegetable farming. Pasighat is also a tourist hub and a city of educational institutions due to its ideal location and the exceptional hospitality of the people of Pasighat. There are many hotels and inns at relatively low prices. The thick evergreen forest and the presence of the mighty Brahmaputra River, adds to the beauty of Pasighat.

ACADEMIC CALENDAR FOR THE SESSION: 2026-2027

PART-A: Academic Calendar for Odd Semester (July to December)

DATES	ACADEMIC ACTIVITY
18 June 2026 (Thursday)	Issue of Prospectus for Admission to First Semester PG courses and Opening of Online Portal for Application for Entrance.
6 July 2026 (Monday)	Last Date for Submission of Applications for Admission to First Semester PG courses (Online Mode).
10 July 2026 (Friday)	Notification of Eligible Candidates for appearing in APUCET 2026 (Admission to First Semester PG Programmes)
15 July 2026 (Wednesday)	Reopening of the University Departments after the Summer Vacation.
17 July 2026 (Friday)	Readmission and Commencement of the Classes for Intermediate Semester (Third Semester)
13-17 July 2026 (Monday - Friday)	Entrance Test (written) for Eligible Candidates for First Semester
15-18 July 2026 (Wednesday-Saturday) *Result shall be notified subject to preparation of it, department wise.	Notification of selected candidates for personal interview for First Semester.
18 - 22 July 2026 (Saturday - Wednesday) *The exact date of the interview for various depts. shall be notified after the written test in the official website.	Personal Interview Test of Selected Candidates for First Semester. *Group Discussion session of Selected candidates for few of the PG Program shall also be held prior to the Personal Interview Test.
25 July 2026 (Saturday)	Notification of Merit List for First Semester
28, 29 & 30 July 2026 (Tuesday - Thursday)	Admission of the Selected Candidates for First Semester
31 July 2026 & 3 August 2026 (Friday & Monday)	Admission of the Wait-Listed Candidates for First Semester

4 August 2026 (Tuesday)	Commencement of the Classes for First Semester
12 August 2026 (Wednesday)	Induction cum Orientation Programme for First Semester students
3 September 2026 to 16 September 2026 (Tentatively)	Selection/Election of the Student's Union Body
I: Last Week of August 2026	Internal Tests / Assignments / Departmental Seminars / Fieldwork for Odd Semesters (1 st & 3 rd)
II: Last Week of September 2026	
III: Fourth Week of October 2026	
30 October 2026	Conduction of the Convocation Ceremony
18 November 2026 (Wednesday)	Last Date for the Submission of the List of Eligible Students and Internal Assessment Marks by the University Departments to the CoE Office
20 November 2026 (Friday)	Notification of Eligible Students for Terminal Examinations
25 - 27 November 2026 (Wednesday – Friday)	Submission of the Examination Forms for Odd Semesters
2 December 2026 (Wednesday) – 23 December 2026 (Wednesday)	Conduct of the Terminal Examinations for Odd Semesters
24 December 2026 (Thursday) – 17 January 2027 (Sunday)	Winter Recess for the University Departments
On or Before 11 January 2027 (Monday)	Declaration of the Results of Odd Semester

PART-B: Academic Calendar for Even Semester (January to July)

DATES	ACADEMIC ACTIVITY
18 January 2027 (Monday)	Reopening of the University Departments after the Winter Recess
21 January 2027 (Thursday)	Commencement of the Classes for All Semesters
Third week of February 2027	Organising the University Festival (APU Fest-2027)

I: Last Week of February 2027	Internal Tests/Assignments/Departmental Seminars/Fieldwork for Even Semester
II: Last Week of March 2027	
III: Third Week of April 2027	
30 April 2027 (Friday)	Last Date for the Submission of the List of Eligible Students and Internal Assessment Marks by the University Departments to the CoE Office
3 May 2027 (Monday)	Notification of Eligible Students for Terminal Examinations
4 May 2027 (Tuesday) – 6 May 2027 (Thursday)	Submission of the Examination Forms for Even Semesters
12 May 2027 (Wednesday) – 2 June 2027 (Wednesday)	Conduct of the Terminal Examinations for Even Semester
5 June 2027 (Saturday) – 15 July 2027 (Thursday)	Summer Vacation for the University Departments
On or Before 30 June 2027 (Wednesday)	Declaration of the Results of Even Semester
16 July 2027 (Friday)	Reopening of the University Departments after the Summer Vacation

PART-C: PhD Admissions for the session 2026-27

DATES	ACADEMIC ACTIVITY
26 June 2026 (Friday)	Availability of Application Forms through online mode
17 July 2026 (Friday)	Last date for submission of applications for admission to PhD Programmes.
24 July 2026 (Friday)	Notification of Eligible candidates for admission to PhD Programmes.
24 & 25 July 2026 (Friday & Saturday)	Entrance test (written) for Eligible candidates for admission to PhD Programmes.
3 & 4 August 2026 (Monday & Tuesday)	Personal interview test of selected candidates for PhD Programmes.
5 August 2026 (Wednesday)	Notification of merit list for PhD Programmes.

10, 11 & 12 August 2026 (Monday, Tuesday & Wednesday)	Admission of selected candidates for PhD Programmes.
13 August 2026	Commencement of classes for PhD coursework.
20 November 2026 (Friday)	Notification of eligible scholars for PhD coursework examinations
25 - 27 November 2026 (Wednesday – Friday)	Submission of the Exam Forms
2 December 2026 (Wednesday) – 23 December 2026 (Wednesday)	Conduct of the PhD coursework Examinations
24 December 2026 (Thursday) – 17 January 2027 (Sunday)	Winter Recess for the University Departments

IMPORTANT CONTACTS:

1. Assistant Registrar (Academic / Examinations):

Email Id: ar.academic@apupsg.ac.in

2. Assistant Registrar (Establishment):

Email Id: nilnangkar@apupsg.ac.in

3. Academic Branch:

Phone No.: +91 9233137593

4. Examination Branch:

Phone No.: +91 9612110984

COMMITTEES AND CELLS

Sl. No.	Committee/Cell	Name of Faculty Member & Staff
1.	Ombudsperson	Prof. Khem Chand Kapoor Present Address: Professor, Department of Education, Assam Don Bosco University, Kamarkuchi, Sonapur, Assam
2.	Student Grievances Redressal Cell	Dr. Eli Doye (Chairman) Dr. Razzeko Delley (Member) Dr. Fames Linggi (Member) Dr. Rinchin Drema (Member) Dr. Kaling Moyong (Member Secretary) Ms. Tenzin Chimey (Member) Ms. Adam Paksok (Member) Ms. Yeshe Lhamu Naksang (Member)
3.	Public Information Officer (PIO) & Assistant Public Information Officer (APIO)	Mr. Likha Rinchin (PIO) Mr Anil Nangkar (APIO)
4.	Internal Complaints Committee	Dr. Ing Perme (Chairman) Dr. Rajen Miwu (Member) Dr. Prem Taba (Member) Dr. Lucindia Dupak (Member) Ms. Ngurang Mana (Member) Ms. Adam Paksok (Member) Ms. Hukter Basar (Member Secretary) Ms. Marya Jini (Student Member) Ms. Mitinam Jamoh (Student Member) Ms. Tana Yaya (Support Staff)
5.	IQAC, UGC and Annual Report	Prof. P.C. Jena (Chairman) Dr. Fames Linggi (Member) Dr. Lige Sora (Member) Dr. Yab Rajiv Camder (Member) Ms. Ngurang Mana (Member Secretary) Mr. Gemin Apum (Support Staff) Mr. Tayin Tatin (Support Staff)
6.	Purchase Committee	Dr. Fames Linggi (Chairman) Ms. Ngurang Mana (Member) Ms. Adam Paksok (Member Secretary) Mr. Solomon Taki (Support Staff)
7.	Stock Verification Committee	Mr. Likha Rinchin (Chairman) Dr. Lige Sora (Member) Mr. Anil Nangkar (Member Secretary) Mr. Buk Mitkong (Support Staff)
8.	Library Committee	Dr. Razzeko Delley (Chairman) Dr. Chiging Yamang (Member) Dr. Menuka Kadu (Member) Dr. Lucindia Dupak (Member) Dr. Tarh Ramya (Member) Mr. Anil Nangkar (Member Secretary) Ms. Minam Ngukir (Support Staff)

9.	Campus Beautification Committee	Dr. Omini Ering Ms. Isha Basar Dr. Prem Taba Ms. Adam Paksok Ms. Ngurang Mana Ms. Milonty Perme Ms. Tungam Riba	(Chairman) (Member) (Member) (Member) (Member Secretary) (Support Staff) (Support Staff)
10.	Dean of Academic Affairs	Prof. P.C. Jena	
11.	Dean of Student Welfare	Dr. Eli Doye	
12.	Anti Ragging Cell	Ms. Ngurang Mana Dr. Prem Taba Dr. Kaling Moyong Dr. Rinchin Drema Dr. Yami Melo Mr. Jumkar Nada	(Chairman) (Member) (Member) (Member) (Member Secretary) (Support Staff)
13.	Placement and Information Cell	Dr. Rajen Miwu Dr. Tarh Ramya Dr. Lekhi ChomThungon Dr. Kombong Darang Mr. Lenzing Panyang	(Chairman) (Member) (Member) (Member Secretary) (Support Staff)
14.	Outreach Programme	Dr. Menuka Kadu Dr. TerbiLoyi Dr. Prem Taba Dr. Yab Rajiv Camder Mr. Anil Nangkar Mr. Konga Yomgam Mr. Rajesh Tamang	(Chairman) (Member) (Member) (Member) (Member Secretary) (Support Staff) (Support Staff)
15.	Meetings, Conferences & Festival	Mr. Likha Rinchin Mr. Chigo Basar Mr. Marto Ronya Ms. Ringku Ratan	(Chairman) (Member) (Member Secretary) (Support Staff)
16.	Disciplinary Committee	Dr. Rajen Miwu Dr. Kaling Moyong Dr. Prem Taba Ms. Isha Basar	(Chairman) (Member) (Member) (Member Secretary)
17.	Estate and Transport Cell	Mr. Anil Nangkar Dr. Tagam Dabi Mr. Marto Ronya Mr. Gumin Apum Mr. Rinchin Tsering Mr. Bijing Saroh Mr. Roman Gamnoh	(Chairman) (Member) (Member Secretary) (Member) (Support Staff) (Support Staff) (Support Staff)
18.	Student Mentor in every Department	Dr. Yab Rajiv Camder Dr. Leki Chom Thungon Dr. Tagam Dabi Dr. Kaling Moyong Dr. Karyir Riba Dr. Linu Ronya Dr. Kombong Darang	(Commerce) (Computer Science) (Economics) (Education) (English) (Hindi) (Mass Comm.)

		Ms. Adam Paksok Ms. Ngurang Mana Dr. TerbiLoyi Ms. Isha Basar	(Mathematics) (Social Work) (Sociology) (Tribal Studies)
19.	Sport & Cultural Committee	Dr. Yab Rajiv Camder Dr. Ing Perme Dr. Kombong Darang Dr. Karyir Riba Dr. Lige Sora Ms. Yeshi Lhamu Naksang	(Chairman) (Member) (Member) (Member) (Member) (Member Secretary)
20.	PRO in prospectus	Mr. TumtoBagra Mr. Likha Rinchin Mr. Kadum Komut	(Chairman) (Member) (Support Staff)
21.	Research & Publication Cell	Dr. Razekko Delley Dr. Fames Linggi Dr. Ing Perme Mr. Likha Rinchin Ms. Hukter Basar Ms. Ringku Ratan	(Chairman) (Member) (Member) (Member Secretary) (Support Staff) (Support Staff)
22.	Media Cell	Dr. Prem Taba Dr. Yab Rajiv Camder Dr. Kombong Darang Mr. Bada Moyong	(Chairman) (Member) (Member Secretary) (Support Staff)
23.	Alumni Affairs Cell	Dr. Eli Doye Dr. TerbiLoyi Dr. Lige Sora Dr. Tarh Ramya Dr. Yab Rajiv Camder	(Chairman) (Member) (Member) (Member) (Member Secretary)
24.	Disaster Management & Campus Safety Cell	Dr. Kaling Moyong Dr. Leki Chom Thungon Dr. Lige Sora Ms. Pratiksha Kashyap Sharma	(Chairman) (Member) (Member) (Member Secretary)
25.	Green Campus & Sustainability Cell	Dr. Tagam Dabi Dr. Linu Ronya Dr. Yami Melo Dr. Tenzin Chimey Ms. Isha Basar	(Chairman) (Member) (Member) (Member) (Member Secretary)
26.	Electricity and Water Supply Committee	Mr. Anil Nangkar Mr. Buk Mitkong Mr. Kani Perme	(Estate Officer) (Support Staff) (Support Staff)
27.	Website Development Committee	Mr. TumtoBagra Dr. Kombong Darang Mr. Kadum Komut	(Chairman) (Member Secretary) (Support Staff)

Academic Departments:

Arunachal Pradesh University in Pasighat hosts a range of postgraduate departments that cater to diverse academic interests and professional aspirations. These departments are designed to provide advanced education, promote research, and foster innovation across various fields.

Postgraduate programmes are regulated by and designed according to the “**National Education Policy 2020**” of the Ministry of Education, Government of India, “Curriculum and Credit Framework for Postgraduate Programmes”, “National Higher Education Qualifications Framework”, and “Guidelines for Multiple Entry and Exit in Academic Programmes offered in Higher Education Institutions” of the University Grants Commission.

Outline

There will be flexibility in the postgraduate programmes offered by the University, *viz.*:

1. Two-Year master’s degree course for those who completed a three-year bachelor’s degree;
2. There will be an exit option after completion of one year, i.e., two consecutive semesters, in a two-year programme as a Postgraduate Diploma in a concerned discipline;
3. One-Year master’s degree course for those who obtained a four-year bachelor’s with honours/research.
4. There will also be provisions for integrated five-year bachelor’s/master’s programmes depending on the capability of the academic department(s).

Note: - Students who have Back Papers and are Late Collegiate, following Choice-Based Credit System (CBCS) i.e. those who took their first semester admission in the year 2023 should refer to the University Prospectus of the session 2024-25.

Department of Commerce

The Department of Commerce, Arunachal Pradesh University is dedicated to provide a high-quality education fostering research in the field of Commerce and Business Studies. Established to prepare students for the dynamic and competitive business environment, the department offers Post-graduate (M.com) and Doctoral (Ph.D.) programmes.

The curriculum is designed to cover essential areas such as Accounting and Finance, Marketing, Human Resource and Entrepreneurship. Emphasis is placed on Practical Knowledge and Skills, with coursework that includes Case studies, Workshops, Industrial Visits and Projects.

Faculty Members:

Sl. No.	Name of Faculty	Designation
1.	Dr. Rajen Miwu (M.Com,MA,Ph.D)	Associate Professor & HoD
2.	Dr. Chiging Yamang (M.Com., B.Ed., M.Phil., Ph.D.)	Assistant Professor
3.	Dr. Yab Rajiv Camder (M.Com., M.Phil., Ph.D., DCA)	Assistant Professor
4.	Ms. Tenzin Chimey (M.Com (Gold Medalist), M.Phil, B.Ed)	Assistant Professor

1. COURSE STRUCTURE

Course Structure for **Postgraduate Diploma Programme, One-Year/Two-Year Postgraduate Programme (With Research), One-Year/Two-Year Postgraduate Programme (With Coursework and Research), and One-Year/Two-Year Postgraduate Programme (With Coursework)** in Department of Commerce (Exit Option after First Year of Two Semesters with 40 credits).

Model – I

(Postgraduate Diploma in Commerce/One-Year Master in Commerce (With Research)/Two-Year Master in Commerce (With Research))

SEMESTER I								
Course Code	Course Title	Credit Distribution				Marks		
		L	T	P	Total	IA	TE	Total
COM/MJ/501	Advance Financial Management	3	1	0	4	25	75	100
COM/MJ/502	Business Statistics & Research Method	3	1	0	4	25	75	100
COM/MJ/503	Managerial Economics	3	1	0	4	25	75	100
COM/MJ/504	Marketing Management	3	1	0	4	25	75	100
COM/MJ/505	Principle of Management	3	1	0	4	25	75	100
** Skill Enhancement Course (SEC)								

Total		20	500					
SEMESTER II								
Course Code	Course Title	Credit Distribution				Marks		
		L	T	P	Total	IA	TE	Total
COM/MJ/551	Corporate Governance, Ethics and Social Responsibility of Business	3	1	0	4	25	75	100
COM/MJ/552	Entrepreneurship Development	3	1	0	4	25	75	100
COM/MJ/553	Financial Planning	3	1	0	4	25	75	100
COM/MJ/554	International Business	3	1	0	4	25	75	100
COM/MJ/555*	Industrial Visit (Project Report)	1	0	3	4	25	75	100
** Skill Enhancement Course (SEC)								
Total		20		500				
<p><i>*After two weeks of Industrial visit every student is required to submit a Project Report at the end of the semester for evaluation and grading based on their observation, experiences and knowledge.</i></p> <p><i>The Project Report may be related to: - a) Accounting and Finance, b) Marketing and Consumer Behaviour, c) Entrepreneurship and Business Start-Up, d) Human Resource Management and Organisational Behaviour, and e) Any other Socio-Economic Aspect.</i></p> <p><i>A student may exit this programme and be awarded the degree, Post Graduate Diploma in Commerce, after One Year or Two Semester with the completion of courses equivalent to 40 credits. OR Entry to One-Year Master in Commerce (With Research).</i></p>								
SEMESTER III								
Course Code	Course Title	Credit		Marks				
COM/RP/659*	Research Project & Dissertation	20		500				
** Skill Enhancement Course (SEC)								
Total		20		500				
SEMESTER IV								
Course Code	Course Title	Credit		Marks				
COM/RP/699*	Research Project & Dissertation	20		500				
** Skill Enhancement Course (SEC)								
Total		20		500				

**At the end of the semester, students must present an individual dissertation of at least 20,000 words based on their chosen research topic, which will be evaluated by internal and external examiners.*

L: Lecture; T: Tutorial; P: Practical; IA: Internal Assessment; TE: Term-End/Terminal Examination

Model – II
(Postgraduate Diploma in Commerce/One-Year Master in Commerce (With Coursework and Research)/Two-Year Master in Commerce (With Coursework and Research))

SEMESTER I								
Course Code	Course Title	Credit Distribution				Marks		
		L	T	P	Total	IA	TE	Total
COM/MJ/501	Advance Financial Management	3	1	0	4	25	75	100
COM/MJ/502	Business Statistics & Research Method	3	1	0	4	25	75	100
COM/MJ/503	Managerial Economics	3	1	0	4	25	75	100
COM/MJ/504	Marketing Management	3	1	0	4	25	75	100
COM/MJ/505	Principle of Management	3	1	0	4	25	75	100
<i>** Skill Enhancement Course (SEC)</i>								
Total		20				500		
SEMESTER II								
Course Code	Course Title	Credit Distribution				Marks		
		L	T	P	Total	IA	TE	Total
COM/MJ/551	Corporate Governance, Ethics and Social Responsibility of Business	3	1	0	4	25	75	100
COM/MJ/552	Entrepreneurship Development	3	1	0	4	25	75	100
COM/MJ/553	Financial Planning	3	1	0	4	25	75	100
COM/MJ/554	International Business	3	1	0	4	25	75	100
COM/MJ/555*	Industrial Visit (Project Report)	1	0	3	4	25	75	100
<i>** Skill Enhancement Course (SEC)</i>								
Total		20				500		

*After two weeks of Industrial visit every student is required to submit a Project Report at the end of the semester for evaluation and grading based on their observation, experiences and knowledge.

The Project Report may be related to: a) Accounting and Finance, b) Marketing and Consumer Behaviour, c) Entrepreneurship and Business Start-Up, d) Human Resource Management and Organisational Behaviour; and e) Any other Socio-Economic Aspect.

A student may exit this programme and be awarded the degree, Post Graduate Diploma in Commerce, after One Year or Two Semester with the completion of courses equivalent to 40 credits. OR Entry to a One-Year Master in Commerce (With Coursework and Research)

SEMESTER III

Course Code	Course Title	Credit Distribution				Marks			
		L	T	P	Total	IA	TE	Total	
SPECIALISATION IN ACCOUNTING & FINANCE									
COM/DE/601	Accounting Theory & Financial Reporting	3	1	0	4	25	75	100	
COM/DE/602	Corporate Tax Planning and Management	3	1	0	4	25	75	100	
COM/DE/603	Security Analysis and Portfolio Management	3	1	0	4	25	75	100	
SPECIALISATION IN MARKETING MANAGEMENT									
COM/DE/601	Agricultural and Rural Marketing	3	1	0	4	25	75	100	
COM/DE/602	Consumer Behaviour and Market Research	3	1	0	4	25	75	100	
COM/DE/603	Product and Brand Management	3	1	0	4	25	75	100	
SPECIALISATION IN HUMAN RESOURCE MANAGEMENT									
COM/DE/601	Compensation Management	3	1	0	4	25	75	100	
COM/DE/602	Human Resource Planning & Development	3	1	0	4	25	75	100	
COM/DE/603	Labour Legislations in India	3	1	0	4	25	75	100	
MAJOR PAPER FOR ALL SPECIALISATION (Compulsory)									
COM/MJ/604	E-Commerce	3	1	0	4	25	75	100	
COM/MJ/605	Strategic Management	3	1	0	4	25	75	100	
** Skill Enhancement Course (SEC)									
Total					20		500		
SEMESTER IV									
Course Code	Course Title	Credit			Marks				

COM/RP/699*	Research Project & Dissertation	20	500
Total		20	500
<i>*At the end of the semester, students must present an individual dissertation of at least 20,000 words based on their chosen research topic, which will be evaluated by internal and external examiners.</i>			

Model – III

(Postgraduate Diploma in Commerce/One-Year Master in Commerce (With Coursework)/Two-Year Master in Commerce (With Coursework))

SEMESTER I								
Course Code	Course Title	Credit Distribution				Marks		
		L	T	P	Total	IA	TE	Total
COM/MJ/501	Advance Financial Management	3	1	0	4	25	75	100
COM/MJ/502	Business Statistics & Research Method	3	1	0	4	25	75	100
COM/MJ/503	Managerial Economics	3	1	0	4	25	75	100
COM/MJ/504	Marketing Management	3	1	0	4	25	75	100
COM/MJ/505	Principle of Management	3	1	0	4	25	75	100
<i>** Skill Enhancement Course (SEC)</i>								
Total		20				500		
SEMESTER II								
Course Code	Course Title	Credit Distribution				Marks		
		L	T	P	Total	IA	TE	Total
COM/MJ/551	Corporate Governance, Ethics and Social Responsibility of Business	3	1	0	4	25	75	100
COM/MJ/552	Entrepreneurship Development	3	1	0	4	25	75	100
COM/MJ/553	Financial Planning	3	1	0	4	25	75	100
COM/MJ/554	International Business	3	1	0	4	25	75	100
COM/MJ/555*	Industrial Visit (Project Report)	1	0	3	4	25	75	100
<i>** Skill Enhancement Course (SEC)</i>								
Total		20				500		

*After two weeks of Industrial visit every student is required to submit a Project Report at the end of the semester for evaluation and grading based on their observation, experiences and knowledge.

The Project Report may be related to: - a) Accounting and Finance, b) Marketing and Consumer Behaviour, c) Entrepreneurship and Business Start-Up, d) Human Resource Management and Organisational Behaviour, and e) Any other Socio-Economic Aspect.

A student may exit this programme and be awarded the degree, Post Graduate Diploma in Commerce, after One Year or Two Semester with the completion of courses equivalent to 40 credits. OR Entry to One-Year Master in Commerce (With Coursework)

SEMESTER III

Course Code	Course Title	Credit Distribution				Marks		
		L	T	P	Total	IA	TE	Total
SPECIALISATION IN ACCOUNTING & FINANCE								
COM/DE/601	Accounting Theory & Financial Reporting	3	1	0	4	25	75	100
COM/DE/602	Corporate Tax Planning and Management	3	1	0	4	25	75	100
COM/DE/603	Security Analysis and Portfolio Management	3	1	0	4	25	75	100
SPECIALISATION IN MARKETING MANAGEMENT								
COM/DE/601	Agricultural and Rural Marketing	3	1	0	4	25	75	100
COM/DE/602	Consumer Behaviour and Market Research	3	1	0	4	25	75	100
COM/DE/603	Product and Brand Management	3	1	0	4	25	75	100
SPECIALISATION IN HUMAN RESOURCE MANAGEMENT								
COM/DE/601	Compensation Management	3	1	0	4	25	75	100
COM/DE/602	Human Resource Planning & Development	3	1	0	4	25	75	100
COM/DE/603	Labour Legislations in India	3	1	0	4	25	75	100
MAJOR PAPER FOR ALL SPECIALISATION (Compulsory)								
COM/MJ/604	E-Commerce	3	1	0	4	25	75	100
COM/MJ/605	Strategic Management	3	1	0	4	25	75	100
** Skill Enhancement Course (SEC)								
Total					20		500	
SEMESTER IV								
Course Code	Course Title	Credit Distribution				Marks		

		L	T	L	T	L	T	L
SPECIALISATION IN ACCOUNTING & FINANCE								
COM/DE/701	Advanced Cost and Management Accounting	3	1	0	4	25	75	100
COM/DE/702	Working Capital Management	3	1	0	4	25	75	100
COM/DE/703	Strategic Financial Management	3	1	0	4	25	75	100
SPECIALISATION IN MARKETING MANAGEMENT								
COM/DE/701	Customer Relationship Management	3	1	0	4	25	75	100
COM/DE/702	Marketing of Services	3	1	0	4	25	75	100
COM/DE/703	International Marketing	3	1	0	4	25	75	100
SPECIALISATION IN HUMAN RESOURCE MANAGEMENT								
COM/DE/701	Dynamics of Industrial Relations	3	1	0	4	25	75	100
COM/DE/702	International Human Resource Management	3	1	0	4	25	75	100
COM/DE/703	Performance and Career Management	3	1	0	4	25	75	100
MAJOR PAPER FOR ALL SPECIALISATION (Compulsory)								
COM/MJ/704	Business Communication	3	1	0	4	25	75	100
COM/MJ/705	Research and Publication Ethics	3	1	0	4	25	75	100
** Skill Enhancement Course (SEC)								
Total		20			500			

L: Lecture; T: Tutorial; P: Practical; IA: Internal Assessment; TE: Term-End/Terminal Examination
Note: DE – Discipline-specific Elective.

**As a part of Innovative/ Skill development course the department is planning to initiate three specialised Clubs for Career Development, designed to support students in achieving their professional aspirations. These clubs will be categorised based on students' career interests:

Assistant Professor Club

Focus: Prepares students for academic careers by enhancing teaching, research, and presentation skills.

Activities: Workshops on teaching methodologies, research paper writing, mock lectures, and mentorship from experienced faculty.

Entrepreneurship Club

Focus: Equips aspiring entrepreneurs with the knowledge and skills to start and manage businesses successfully.

Activities: Idea pitch sessions, business plan development, case studies of successful startups, and interactions with industry leaders.

Civil Service Club

Focus: Supports students preparing for civil service exams by honing analytical, decision-making, and communication skills.

Activities: Mock interviews, group discussions, current affairs sessions, and guidance from civil servants.

These clubs will meet periodically to organise workshops, discussions, and hands-on activities that help students build expertise and confidence in their chosen fields. This initiative will foster career-oriented learning and professional growth among the students.

Fee structure for Master of Commerce

Sl.No.	Heads	Amounts (in ₹)			
		Sem. I	Sem. II	Sem. III	Sem. IV
1.	Admission Fee (Annual)	1,000		1,000	
2.	Registration Fee	400			
3.	Tuition Fee (Every Semester)	2,000	2,000	2,000	2,000
4.	Development Fee (Annual)	1,000		1,000	
5.	Identity Card Fee (Annual)	100		100	
6.	Students' Union Fee (Annual)	400		400	
7.	Games And Sports Fee (Annual)	400		400	
8.	Youth Welfare Fee (Annual)	300		300	
9.	Magazine Fee (Annual)	200		200	
10.	Continuation Fee		100		100
11.	Transportation (Bus Service) Fee	300		300	
12.	Field work Fee		1,000		
Total for Each Semester (in ₹)		6,100	3,100	5,700	2,100
13.	Caution Money (<i>to be paid one-time during the admission to First Semester</i>) *	1,000			
Grand Total (in ₹)		7,100	3,100	5,700	2,100
Total Course Fees (in ₹)		18,000/-			

*Refundable at the end of the PG Diploma/Programme.

Department of Computer Science

The Department of Computer Science at Arunachal Pradesh University offers quality education and research opportunities in modern computing disciplines. The department focuses on building strong foundations in programming, software development, data science, and emerging technologies such as artificial intelligence and cybersecurity. With an emphasis on practical learning and innovation, it prepares students to meet industry demands and pursue advanced research and professional careers.

Vision and Mission of Computer Science Department:

Vision

To be a center of excellence in computer science education and research, fostering innovation, ethical practices, and technological advancement to meet global challenges.

Mission

- To provide high-quality education in computer science with a strong foundation in theory and practical applications.
- To promote research, innovation, and entrepreneurship in emerging areas of computing.
- To equip students with industry-relevant skills and lifelong learning abilities.
- To inculcate professional ethics, teamwork, and leadership qualities.
- To contribute to societal development through technology-driven solutions. To provide strong foundational and advanced mathematical knowledge through quality teaching and learning practices.

About the Course

The Master of Computer Applications (MCA) is a postgraduate program offered by the Department of Computer Science at Arunachal Pradesh University, designed to develop skilled professionals in the field of information technology and software development. The program provides a strong foundation in programming, database management, computer networks, and software engineering, along with exposure to emerging technologies such as artificial intelligence, data science, cloud computing, and cybersecurity. The curriculum emphasizes both theoretical knowledge and practical skills through lab work, projects, and industry-oriented training. It aims to prepare students for diverse career opportunities in IT industries, research, and entrepreneurship, while also fostering problem-solving abilities, innovation, and professional ethics.

Eligibility

- Graduates from any disciplines are eligible, provided they have studied Mathematics / Statistics / Computer Science at the 10+2 or undergraduate level.
- The candidate should have obtained a minimum of 45–50% marks in the qualifying examination (relaxation for reserved categories as per University/State Government norms)
- Admission shall be based on merit and/or entrance examination as per the norms of Arunachal Pradesh University.

No. of Seats, Semester and Time Duration

- Intake Capacity: At present, the Department has an intake capacity of 20 students; however, this number is subject to revision as per the decision of the University Academic Council and State Government Policies.
- Time Duration: The program is a full-time course of two academic year.
- Semester Structure: The program is divided into four semesters, following the learning Outcome-based Curriculum Framework (LOCF).

Faculty Members:

Sl. No.	Name of Faculty	Designation
1.	Dr. Lucindia Dupak (B. E, MTech, Ph. D.)	Assistant Professor & HoD (i/c)
2.	Dr. Leki Chom Thungon (B. E, MTech, Ph. D.)	Assistant Professor

COURSE STRUCTURE

Course structure for Postgraduate Diploma Programme, One-Year/Two Year Postgraduate Programme (with Research), One- Year/Two Year Postgraduate Programme (with coursework and Research), One- Year/Two Year Postgraduate Programme (with coursework) in the Department of Computer Science.

Module-I**Postgraduate Diploma Programme, One- Year MCA in Computer Science (with Research)/ Two- Year MCA in Computer Science (with Research).**

SEMESTER I								
Course Code	Course Title	Credit Distribution				Marks		
		L	T	P	Total	IA	TE	Total
MCA/MJ/501	Programming and Problem Solving	2	1	1	4	25	75	100
MCA/MJ/502	Database Management System	2	1	1	4	25	75	100
MCA/MJ/503	Discrete Mathematics	3	1	0	4	25	75	100
MCA/MJ/504	Computer Organization and Architecture	2	1	1	4	25	75	100
MCA/MJ/505	Software Engineering	2	1	1	4	25	75	100
<i>Skill Enhancement Course (SEC)</i>								
Total		20				500		
SEMESTER II								
Course Code	Course Title	Credit Distribution				Marks		
		L	T	P	Total	IA	TE	Total
MCA/MJ/506	Computer Networks	3	1	0	4	25	75	100
MCA/MJ/507	Design and Analysis of Algorithms	3	1	0	4	25	75	100
MCA/MJ/508	Operating System	3	1	0	4	25	75	100
MCA/MJ/509	Artificial Intelligence	3	1	0	4	25	75	100
MCA/ELEC/01	Python Programming	3	1	0	4	25	75	100
MCA/ELEC/02	Cyber Security	3	1	0	4	25	75	100
MCA/ELEC/03	Block Chain Technology	0	0	4	4	25	75	100
<i>Skill Enhancement Course (SEC)</i>								
Total		20				500		
NOTE: A student has to choose any 1 elective paper from MCA/ELEC/01 to 03.								
<i>Exit option with PG Diploma after the first year of two semester with the completion of courses equivalent to 40</i>								

credits OR Entry to One-Year MCA in Computer Sciences with Research.

SEMESTER III

Course Code	Course Title	Credit	Marks
MCA/RP/601	Research Project & Dissertation	20	500

Skill Enhancement Course (SEC)

SEMESTER IV

Course Code	Course Title	Credit Distribution	Marks
MCA/RP/611	Research Project & Dissertation	20	500

Skill Enhancement Course (SEC)

Total Credit (Aggregate)

80

500

MCA in Computer Science with Research on completion of courses equal to a minimum of 40 credits

Note: L: Lecture; T: Tutorial; P: Practical; IA: Internal Assessment; TE: Term End/Terminal Examination

**At the end of the semester student must present an individual dissertation of at least 20,000 words based on their chosen research topic, which will be evaluated by internal and external examiners*

Module-II

Postgraduate Diploma Programme, One- Year MCA in Computer Science (with Coursework and Research) / Two- Year MCA in Computer Science (with Coursework and Research)

SEMESTER I

Course Code	Course Title	Credit Distribution				Marks		
		L	T	P	Total	IA	TE	Total
MCA/MJ/501	Programming and Problem Solving	2	1	1	4	25	75	100
MCA/MJ/502	Database Management System	2	1	1	4	25	75	100
MCA/MJ/503	Discrete Mathematics	3	1	0	4	25	75	100
MCA/MJ/504	Computer Organization and Architecture	2	1	1	4	25	75	100
MCA/MJ/505	Software Engineering	2	1	1	4	25	75	100

Skill Enhancement Course (SEC)

Total

20

500

SEMESTER II

Course Code	Course Title	Credit Distribution				Marks		
		L	T	P	Total	IA	TE	Total
MCA/MJ/506	Computer Networks	3	1	0	4	25	75	100
MCA/MJ/507	Design and Analysis of Algorithms	3	1	0	4	25	75	100
MCA/MJ/508	Operating System	3	1	0	4	25	75	100
MCA/MJ/509	Artificial Intelligence	3	1	0	4	25	75	100
MCA/ELEC/01	Python Programming	3	1	0	4	25	75	100
MCA/ELEC/02	Cyber Security	3	1	0	4	25	75	100
MCA/ELEC/03	Block Chain Technology	0	0	4	4	25	75	100
<i>Skill Enhancement Course (SEC)</i>								
Total		20				500		

NOTE: A student has to choose any 1 elective paper from MCA/ELEC/01 - 03.

SEMESTER III

Course Code	Course Title	Credit Distribution				Marks		
		L	T	P	Total	IA	TE	Total
MCA/MJ/510	Research and Publications Ethics	3	1	0	4	25	75	100
MCA/MJ/511	Programming and Practices	2	1	1	4	25	75	100
MCA/MJ/512	Web Technology	2	1	1	4	25	75	100
MCA/MJ/513	Theory of Computation	3	1	0	4	25	75	100
MCA/ELEC/04	Big Data & Analytics	2	1	1	4	25	75	100
MCA/ELEC/05	Cloud Computing & Internet of Things (IoT)	2	1	1	4	25	75	100
MCA/ELEC/06	Natural Language Processing (NLP)	2	1	1	4	25	75	100
MCA/ELEC/07	Internet of Things (IoT)	2	1	1	4	25	75	100
MCA/ELEC/08	Wireless Sensor Networks	2	1	1	4	25	75	100
MCA/ELEC/09	Machine Learning	2	1	1	4	25	75	100
<i>Skill Enhancement Course (SEC)</i>								
Total		20				500		

NOTE: A student has to choose any 1 elective papers from MCA/ELEC/04-09.

SEMESTER IV			
Course Code	Course Title	Credit Distribution	Marks
MCA/RP/611	Research Project & Dissertation	20	500

Module III

Postgraduate Diploma Programme, One- Year MCA in Computer Science (with Coursework)/ Two-Year MCA in Computer Science (with Coursework)

SEMESTER I								
Course Code	Course Title	Credit Distribution				Marks		
		L	T	P	Total	IA	TE	Total
MCA/MJ/501	Programming and Problem Solving	2	1	1	4	25	75	100
MCA/MJ/502	Database Management System	2	1	1	4	25	75	100
MCA/MJ/503	Discrete Mathematics	3	1	0	4	25	75	100
MCA/MJ/504	Computer Organization and Architecture	2	1	1	4	25	75	100
MCA/MJ/505	Software Engineering	2	1	1	4	25	75	100
<i>Skill Enhancement Course (SEC)</i>								
Total		20				500		
SEMESTER II								
Course Code	Course Title	Credit Distribution				Marks		
		L	T	P	Total	IA	TE	Total
MCA/MJ/506	Computer Networks	3	1	0	4	25	75	100
MCA/MJ/507	Design and Analysis of Algorithms	3	1	0	4	25	75	100
MCA/MJ/508	Operating System	3	1	0	4	25	75	100
MCA/MJ/509	Artificial Intelligence	3	1	0	4	25	75	100
MCA/ELEC/01	Python Programming	3	1	0	4	25	75	100
MCA/ELEC/02	Cyber Security	3	1	0	4	25	75	100

MCA/ELEC/03	Block Chain Technology	0	0	4	4	25	75	100
<i>Skill Enhancement Course (SEC)</i>								
Total					20		500	
<i>NOTE: A student has to choose any 1 elective paper from MCA/ELEC/01-03.</i>								
SEMESTER III								
Course Code	Course Title	Credit Distribution				Marks		
		L	T	P	Total	IA	TE	Total
MCA/MJ/510	Research and Publications Ethics	3	1	0	4	25	75	100
MCA/MJ/511	Programming and Practices	2	1	1	4	25	75	100
MCA/MJ/512	Web Technology	2	1	1	4	25	75	100
MCA/MJ/513	Theory of Computation	3	1	0	4	25	75	100
MCA/ELEC/04	Big Data & Analytics	2	1	1	4	25	75	100
MCA/ELEC/05	Cloud Computing & Internet of Things (IoT)	2	1	1	4	25	75	100
MCA/ELEC/06	Natural Language Processing (NLP)	2	1	1	4	25	75	100
MCA/ELEC/07	Internet of Things (IoT)	2	1	1	4	25	75	100
MCA/ELEC/08	Wireless Sensor Networks	2	1	1	4	25	75	100
MCA/ELEC/09	Machine Learning	2	1	1	4	25	75	100
<i>Skill Enhancement Course (SEC)</i>								
<i>NOTE: A student has to choose any 1 elective papers from MCA/ELEC/04 -09</i>								
Total					20		500	
SEMESTER IV								
Course Code	Course Title	Credit Distribution				Marks		
		L	T	P	Total	IA	TE	Total
MCA/MJ/514	Deep Learning Fundamentals	2	1	1	4	25	75	100
MCA/MJ/515	Compiler Design	3	1	0	4	25	75	100
MCA/MJ/516	Computer Graphics and Multimedia	2	1	1	4	25	75	100
MCA/ELEC/10	Android Application Development	2	1	1	4	25	75	100
MCA/ELEC/11	Graph Theory	3	1	0	4	25	75	100

MCA/ELEC/12	Pattern Recognition	2	1	1	4	25	75	100
MCA/ELEC/13	Data Warehousing and Data Mining	2	1	1	4	25	75	100
MCA/ELEC/14	Information Retrieval	2	1	1	4	25	75	100
MCA/ELEC/15	Image Processing	2	1	1	4	25	75	100
Skill Enhancement Course (SEC)								
Total		20			500			
NOTE: A student has to choose any 2 elective papers from MCA/ELEC/10 -15								

Fee structure for Master of Computer Application

Sl.No.	Heads	Amounts (in ₹)			
		Sem. I	Sem. II	Sem. III	Sem. IV
1.	Admission Fee (Annual)	1,000		1,000	
2.	Registration Fee	400			
3.	Tuition Fee (Every Semester)	3,000	3,000	3,000	3,000
4.	Development Fee (Annual)	1,000		1,000	
5.	Identity Card Fee (Annual)	100		100	
6.	Students' Union Fee (Annual)	400		400	
7.	Games And Sports Fee (Annual)	400		400	
8.	Youth Welfare Fee (Annual)	300		300	
9.	Magazine Fee (Annual)	200		200	
10.	Continuation Fee		100		100
11.	Transportation (Bus Service) Fee	300		300	
12.	Lab fee (Every Semester)	2,000	2,000	2,000	2,000
13.	Industrial visit fee (Annual)	1,500		1,500	
Total for Each Semester (in ₹)		10,600	5,100	10,200	5,100
14.	Caution Money (to be paid one-time during the admission to First Semester) *	1,000			
Grand Total (in ₹)		11,600	5,100	10,200	5,100
Total Course Fees (in ₹)		32,000/-			

*Refundable at the end of the PG Diploma/Programme.

Department of Economics

The Department of Economics is dedicated to provide a comprehensive understanding of economic theory, policies, and practices. The department offers a postgraduate programme, i.e., Master of Arts (M.A.) and Ph. D in Economics, designed to equip students with advanced analytical and research skills.

The curriculum covers a wide range of topics, including microeconomics, macroeconomics, econometrics, development economics, and public policy. Emphasis is placed on both theoretical foundations and practical applications, ensuring that students gain a robust understanding of economic principles and their real-world implications. Students get exposure of a different courses of their choice and gain knowledge of doing field work, analysing data, handling statistical software packages, presentations, writing reports and papers.

Faculty Members:

Sl. No.	Name of Faculty	Designation
1.	Dr. Fames Linggi (M.A., M.Phil., Ph.D.)	Associate Professor & HoD
2.	Dr. Tagam Dabi (M.A., M.Phil., Ph.D.)	Assistant Professor
3.	Dr. Lige Sora (M.A., M.Phil., Ph.D.)	Assistant Professor
4.	Dr. Yami Melo (M.A., M.Phil., Ph.D.)	Assistant Professor

Curriculum and Credit Framework for the PG Programme

Module - I

Course Structure for PG Diploma in ECONOMICS/One-Year M.A. in ECONOMICS with Research/Two-Year M.A. in ECONOMICS with Research

SEMESTER I								
Course Code	Course Title	Credit Distribution				Marks		
		L	T	P	Total	IA	TE	Total
ECO/MJ/501	Advanced Microeconomics Analysis	3	1	0	4	25	75	100
ECO/MJ/502	Advanced Macroeconomic Analysis	3	1	0	4	25	75	100
ECO/MJ/503	Statistics	3	1	0	4	25	75	100
ECO/MJ/504	Growth and Development	3	1	0	4	25	75	100

	Economics							
ECO/MJ/505	Research Methodology	3	1	0	4	25	75	100
<i>Skill Enhancement Course (SEC)</i>								
Total		20				500		
SEMESTER II								
Course Code	Course Title	Credit Distribution				Marks		
		L	T	P	Total	IA	TE	Total
ECO/MJ/551	Indian Economy	3	1	0	4	25	75	100
ECO/MJ-E/552	Public Economics	3	1	0	4	25	75	100
ECO/MJ-E/553	Political Economics	3	1	0	4	25	75	100
ECO/MJ-E/554	International Economics	3	1	0	4	25	75	100
ECO/MJ-E/555	Behavioural Economics	3	1	0	4	25	75	100
ECO/MJ-E/556	Financial Institutions	3	1	0	4	25	75	100
ECO/MJ-E/557	Agricultural and Rural Development	3	1	0	4	25	75	100
ECO/MJ/558	Research and Publication Ethics	1	0	3	4	25	75	100
<i>Skill Enhancement Course (SEC)</i>								
Total		20				500		
<i>Note: A student has to choose any three elective papers from ECO/MJ-E/552 to ECO/MJ-E/557.</i>								
<i>Exit option with PG Diploma after the first year or two semesters with the completion of courses equivalent to 40 credits OR Entry to One-Year M.A. in Economics with Research after completion of 4 years B.A. with Honours in Economics</i>								
SEMESTER III								
Course Code	Course Title	Credit		Marks				
ECO/RP/601	Research Project & Dissertation	20		500				
<i>Skill Enhancement Course (SEC)</i>								
SEMESTER IV								
Course Title	Course Title	Course Title		Course Title				
ECO/RP/611	Research Project & Dissertation	20		500				
<i>Skill Enhancement Course (SEC)</i>								
Total Credit (Aggregate)		80						

M.A in Economics with Research on completion of courses equal to a minimum of 40 credits

Note: L: Lecture; T: Tutorial; P: Practical; IA: Internal Assessment; TE: Term-End/Terminal Examination

**At the end of the semester, students must present an individual dissertation of at least 20,000 words based on their chosen research topic, which will be evaluated by internal and external examiners.*

Module - II
Course Structure for PG Diploma in ECONOMICS/One-Year M.A. in ECONOMICS with Coursework & Research/Two-Year M.A. in ECONOMICS with Coursework & Research

SEMESTER I								
Course Code	Course Title	Credit Distribution				Marks		
		L	T	P	Total	IA	TE	Total
ECO/MJ/501	Advanced Microeconomics Analysis	3	1	0	4	25	75	100
ECO/MJ/502	Advanced Macroeconomic Analysis	3	1	0	4	25	75	100
ECO/MJ/503	Statistics	3	1	0	4	25	75	100
ECO/MJ/504	Growth and Development Economics	3	1	0	4	25	75	100
ECO/MJ/505	Research Methodology	3	1	0	4	25	75	100
<i>Skill Enhancement Course (SEC)</i>								
Total		20				500		
SEMESTER II								
Course Code	Course Title	Credit Distribution				Marks		
		L	T	P	Total	IA	TE	Total
ECO/MJ/551	Indian Economy	3	1	0	4	25	75	100
ECO/MJ-E/552	Public Economics	3	1	0	4	25	75	100
ECO/MJ-E/553	Political Economics	3	1	0	4	25	75	100
ECO/MJ-E/554	International Economics	3	1	0	4	25	75	100
ECO/MJ-E/555	Behavioural Economics	3	1	0	4	25	75	100
ECO/MJ-E/556	Financial Institutions	3	1	0	4	25	75	100
ECO/MJ-E/557	Agricultural and Rural Development	3	1	0	4	25	75	100
ECO/MJ/558	Research and Publication Ethics	1	0	3	4	25	75	100
<i>Skill Enhancement Course (SEC)</i>								

Total		20				500		
<i>Note: A student has to choose any three elective papers from ECO/MJ-E/552 to ECO/MJ-E/557.</i>								
<i>Exit option with PG Diploma after the first year or two semesters with the completion of courses equivalent to 40 credits OR Entry to One-Year M.A. in Economics with Coursework and Research.</i>								
SEMESTER III								
Course Code	Course Title	Credit Distribution				Marks		
		L	T	P	Total	IA	TE	Total
ECO/MJ/601	Agricultural Economics	3	1	0	4	25	75	100
ECO/MJ-E/602	Industrial Economics					25	75	
ECO/MJ-E/603	Population Economics	3	1	0	4	25	75	100
ECO/MJ-E/604	Demography	3	1	0	4	25	75	100
ECO/MJ-E/605	Econometrics	3	1	0	4	25	75	100
ECO/MJ-E/606	Infrastructural Economics	3	1	0	4	25	75	100
ECO/MJ-E/607	Economy of North-East India with Special Reference to Arunachal Pradesh	3	1	0	4	25	75	100
ECO/MJ-E/608	Rural Economics	3	1	0	4	25	75	100
ECO/MJ-E/609	Advanced Mathematical Analysis	3	1	0	4	25	75	100
ECO/MJ-E/610	Labour and Informal Economics	3	1	0	4	25	75	100
<i>Skill Enhancement Course (SEC)</i>								
Total		20				500		
<i>Note: A student has to choose any four elective papers from ECO/MJ-E/602 to ECO/MJ-E/610.</i>								
SEMESTER IV								
Course Code	Course Title	Credit			Marks			
ECO/RP/699*	Research Project & Dissertation	20			500			
<i>Skill Enhancement Course (SEC)</i>								

Total	20	500
--------------	-----------	------------

Note: L: Lecture; T: Tutorial; P: Practical; IA: Internal Assessment; TE: Term-End/Terminal Examination

**At the end of the semester, students must present an individual dissertation of at least 20,000 words based on their chosen research topic, which will be evaluated by internal and external examiners.*

Module - III
Course Structure for PG Diploma in ECONOMICS/One-Year M.A. in
ECONOMICS with Coursework/Two-Year M.A. in ECONOMICS with
Coursework

SEMESTER I								
Course Code	Course Title	Credit Distribution				Marks		
		L	T	P	Total	IA	TE	Total
ECO/MJ/501	Advanced Microeconomics Analysis	3	1	0	4	25	75	100
ECO/MJ/502	Advanced Macroeconomic Analysis	3	1	0	4	25	75	100
ECO/MJ/503	Statistics	3	1	0	4	25	75	100
ECO/MJ/504	Growth and Development Economics	3	1	0	4	25	75	100
ECO/MJ/505	Research Methodology	3	1	0	4	25	75	100
<i>Skill Enhancement Course (SEC)</i>								
Total					20		500	
SEMESTER II								
Course Code	Course Title	Credit Distribution				Marks		
		L	T	P	Total	IA	TE	Total
ECO/MJ/551	Indian Economy	3	1	0	4	25	75	100
ECO/MJ-E/552	Public Economics	3	1	0	4	25	75	100
ECO/MJ-E/553	Political Economics	3	1	0	4	25	75	100
ECO/MJ-E/554	International Economics	3	1	0	4	25	75	100
ECO/MJ-E/555	Behavioural Economics	3	1	0	4	25	75	100
ECO/MJ-E/556	Financial Institutions	3	1	0	4	25	75	100
ECO/MJ-E/557	Agricultural and Rural Development	3	1	0	4	25	75	100
ECO/MJ/558	Research and Publication Ethics	1	0	3	4	25	75	100

Skill Enhancement Course (SEC)								
Total			20			500		
<i>Note: A student has to choose any three elective papers from ECO/MJ-E/552 to ECO/MJ-E/557.</i>								
<i>Exit option with PG Diploma after the first year or two semesters with the completion of courses equivalent to 40 credits OR Entry to One-Year M.A. in Economics with Coursework.</i>								
SEMESTER III								
Course Code	Course Title	Credit Distribution				Marks		
		L	T	P	Total	IA	TE	Total
ECO/MJ/601	Agricultural Economics	3	1	0	4	25	75	100
ECO/MJ-E/602	Industrial Economics	3	1	0	4	25	75	100
ECO/MJ-E/603	Population Economics	3	1	0	4	25	75	100
ECO/MJ-E/604	Demography	3	1	0	4	25	75	100
ECO/MJ-E/605	Econometrics	3	1	0	4	25	75	100
ECO/MJ-E/606	Infrastructural Economics	3	1	0	4	25	75	100
ECO/MJ-E/607	Economy of North-East India with Special Reference to Arunachal Pradesh	3	1	0	4	25	75	100
ECO/MJ-E/608	Rural Economics	3	1	0	4	25	75	100
ECO/MJ-E/609	Advanced Mathematical Analysis	3	1	0	4	25	75	100
ECO/MJ-E/610	Labour and Informal Economics	3	1	0	4	25	75	100
Skill Enhancement Course (SEC)								
Total			20			500		
<i>Note: A student has to choose any four elective papers from ECO/MJ-E/602 to ECO/MJ-E/610.</i>								
SEMESTER IV								
Course Code	Course Title	Credit Distribution				Marks		
		L	T	P	Total	IA	TE	Total
ECO/MJ-E/611	Development Economics	3	1	0	4	25	75	100
ECO/MJ-E/612	Gender and Development Economics	3	1	0	4	25	75	100
ECO/MJ-E/613	Regional Economics	3	1	0	4	25	75	100
ECO/MJ-E/614	Institutional Economics	3	1	0	4	25	75	100
ECO/MJ-E/615	Economics of Social Sector	3	1	0	4	25	75	100
ECO/MJ-E/616	Health Economics	3	1	0	4	25	75	100
ECO/MJ-E/617	Game Theory	3	1	0	4	25	75	100
ECO/MJ-E/618	Advanced Econometrics Method and Application	3	1	0	4	25	75	100
ECO/MJ-E/619	Political Economy of East and South East Asia	3	1	0	4	25	75	100
ECO/MJ-E/620	Entrepreneurial Development	3	1	0	4	25	75	100

Skill Enhancement Course (SEC)		
Total Credit (Aggregate)	40	1000
<i>Note: A student has to choose any five elective papers from ECO/MJ-E/611 to ECO/MJ-E/620.</i>		
Post-graduate degree in ECONOMICS with Coursework & Research on completion of courses equal to a minimum of 80 credits		

Note: L: Lecture; T: Tutorial; P: Practical; IA: Internal Assessment; TE: Term-End/Terminal Examination

**At the end of the semester, students must present an individual dissertation of at least 20,000 words based on their chosen research topic, which will be evaluated by internal and external examiners.*

Fee structure for Master of Arts in Economics

Sl.No.	Heads	Amounts (in ₹)			
		Sem. I	Sem. II	Sem. III	Sem. IV
1.	Admission Fee (Annual)	1,000		1,000	
2.	Registration Fee	400			
3.	Tuition Fee (Every Semester)	2,000	2,000	2,000	2,000
4.	Development Fee (Annual)	1,000		1,000	
5.	Identity Card Fee (Annual)	100		100	
6.	Students' Union Fee (Annual)	400		400	
7.	Games And Sports Fee (Annual)	400		400	
8.	Youth Welfare Fee (Annual)	300		300	
9.	Magazine Fee (Annual)	200		200	
10.	Continuation Fee		100		100
11.	Transportation (Bus Service)	300		300	
12.	Field work Fee				1,000
Total for Each Semester (in ₹)		6,100	2,100	5,700	3,100
13.	Caution Money (to be paid one-	1,000			
Grand Total (in ₹)		7,100	2,100	5,700	3,100
Total Course Fees (in ₹)		18,000/-			

**Refundable at the end of the PG Diploma/Programme.*

Department of Education

The Department of Education, established on July 1, 2022, in tandem with the inception of Arunachal Pradesh University, Pasighat, represents a dynamic and forward-looking academic unit committed to excellence in teaching, research, and community engagement. Although formally instituted at the university's foundation, the department became fully operational following its approval in the 1st Executive Council Meeting held on May 23, 2023, marking the beginning of its structured academic and administrative functions. Since then, it has rapidly evolved into a vibrant intellectual hub, fostering critical inquiry, pedagogical innovation, and interdisciplinary scholarship in the field of education. With a strong emphasis on both theoretical foundations and practical applications, the department currently offers Postgraduate (Master of Arts. in Education) and Doctoral (Doctor of Philosophy in Education) programmes designed to cultivate highly skilled educators, researchers, and policy thinkers. Its curriculum is thoughtfully crafted to address contemporary educational challenges while remaining grounded in philosophical, psychological, and sociological perspectives of education. Furthermore, the department is dedicated to promoting research that contributes to regional, national, and global educational development, particularly with sensitivity to the unique socio-cultural context of Northeast India. Through its commitment to academic rigor, inclusivity, and innovation, the Department of Education aspires to play a transformative role in shaping the future of education and knowledge production.

Vision:

The Department of Education envisions becoming a centre of excellence in teacher education, research, and policy development, committed to nurturing intellectually competent, socially responsible, and ethically grounded educators and scholars. It aspires to contribute meaningfully to the advancement of knowledge and the transformation of educational practices, with a special focus on addressing the diverse cultural, social, and developmental needs of the region and the nation. The department seeks to foster innovation, critical thinking, and lifelong learning, thereby empowering individuals to respond effectively to the evolving challenges of the global educational landscape.

Mission:

The mission of the Department of Education is to provide high-quality education through

comprehensive postgraduate and doctoral programs that integrate theoretical knowledge with practical application. It aims to promote interdisciplinary research and scholarly inquiry that addresses contemporary educational issues at local, national, and global levels. The department is dedicated to preparing competent educators, researchers, and leaders who are equipped with professional skills, ethical values, and a commitment to social justice and inclusivity. Additionally, it strives to engage with communities and stakeholders to enhance educational opportunities, contribute to policy formulation, and support sustainable development in the field of education.

Innovative Pedagogical Practices of the Department of Education:

1. **Experiential Learning:** Emphasis on learning through direct experience, including field visits, internships, and community engagement programs that connect theory with practice.
2. **Case Based Teaching:** Use of real-life educational cases to develop analytical, problem-solving, and decision-making skills among students.
3. **Blended and Flipped Learning:** Integration of digital tools and face-to-face instruction, encouraging students to engage with learning materials before class and participate in interactive sessions during class.
4. **Research Oriented Teaching:** Active involvement of students in action research, dissertations, and academic projects to foster inquiry, critical thinking, and evidence-based understanding.
5. **Collaborative Learning:** Promotion of group discussions, peer teaching, seminars, and workshops to enhance teamwork, communication, and shared learning experiences.
6. **Use of ICT in Education:** Adoption of smart classrooms, e-learning platforms, and multimedia resources to create an engaging and technology-driven learning environment.
7. **Inclusive Pedagogical Practices:** Implementation of learner-centered approaches that cater to diverse learning needs, ensuring equity, accessibility, and participation for all students.
8. **Reflective Practices:** Encouraging students to maintain journals, portfolios, and self-assessment records to develop reflective thinking and continuous self-improvement.
9. **Continuous and Comprehensive Evaluation:** Use of formative and summative assessment methods such as presentations, assignments, projects, and viva voce to ensure holistic evaluation.

10. **Interdisciplinary Approach:** Integration of knowledge from various disciplines to provide a broader perspective and address complex educational issues effectively.

Outreach and Community Activities:

1. **Educational Awareness Campaigns:** The department organizes awareness drives in nearby schools and communities to promote the importance of education, especially among rural and marginalized groups.
2. **Literacy and Numeracy Support Programmes:** Special initiatives are undertaken to support foundational learning skills among school children through remedial teaching and learning assistance.
3. **Capacity Building Workshops:** Regular training programmes and workshops are conducted for teachers, student-teachers, and community members to enhance pedagogical skills and professional competencies.
4. **Community-Based Research Projects:** Students and faculty engage in field-based research to identify local educational issues and develop context specific, practical solutions.
5. **Value Education and Life Skills Programmes:** Extension activities focusing on ethics, moral values, and life skills are organized to promote holistic personality development among learners.
6. **Environmental Awareness Initiatives:** Activities such as plantation drives, cleanliness campaigns, and sustainability awareness programmes are conducted to encourage environmental responsibility.
7. **Career Guidance and Counselling Sessions:** The department conducts guidance programmes to help students and youth make informed academic and career choices.
8. **Field Engagement and School Internship Programmes:** Students participate in school visits, internships, and teaching practice sessions to gain hands-on experience and develop professional competence.
9. **Village Surveys and Community Interaction:** Structured field visits and surveys are conducted to understand community needs and educational challenges at the grassroots level.

Collaborative Outreach Activities: The department works in collaboration with schools, NGOs, and local organizations to strengthen educational outreach and promote inclusive development.

Faculty Members:

The Department of Education is strengthened by a dedicated and highly qualified team of faculty members and support staff who collectively contribute to its academic excellence, research advancement, and institutional development. The faculty is actively engaged in innovative teaching, interdisciplinary research, curriculum enrichment, and mentoring of students at both postgraduate and doctoral levels.

Faculty Members:

Sl. No.	Name of Faculty	Designation
1.	Dr. P. C. Jena (B.A. Hons, B.Ed., M.Sc. Applied Psychology, M.A. English, M.A. Political Science, M.A., M.Phil. and Ph.D. in Education)	Professor and HoD, Dean of Academic Affairs
2.	Dr. Kaling Moyong (M.A., Ph.D.)	Assistant Professor
3.	Dr. Omini Ering (M.A., B.Ed., Ph.D.)	Assistant Professor
4.	Ms. Pratiksha Kashyap Sharma (M.A., B.Ed)	Assistant Professor

Programmes Offered:

- M.A. (Education):** A two-year postgraduate programme designed in alignment with the principles and framework of the National Education Policy (NEP) 2020, focusing on developing advanced knowledge, critical understanding, and professional competencies in the field of education.
- Ph.D. in Education:** A doctoral programme dedicated to advanced research and scholarly inquiry, with emphasis on educational foundations, policy analysis, and addressing regional as well as contemporary challenges in the field of education.

Eligibility Criteria:

1. **M.A. in Education:** Candidates seeking admission must possess a Bachelor's degree in a relevant discipline from a recognized university, fulfilling the eligibility requirements and academic standards prescribed by the university as:

1.1 Bachelor's degree with Education as a Honours/Major subject minimum of 45% marks of aggregate

1.2 Bachelor's degree with Education as a pass/minor subject minimum of 45% marks of aggregate

1.3 Bachelor's degree with B.El.Ed/B.Ed. with minimum of 45% marks of aggregate

(Relaxation of marks in admission for different reserved categories as per the state govt.'s norms)

Course Scheme:

The Department of Education has structured its curriculum in accordance with the NEP-2020 framework, offering flexible and multidisciplinary pathways to cater to diverse academic and research interests. The programme is organized into three specialized modules:

1. **Module-I:** This track emphasizes intensive coursework combined with a substantial 40-credit Research Project (Dissertation), designed for students with a strong inclination toward advanced research and academic specialization.
2. **Module-II:** A balanced approach that integrates core coursework with a 4-credit Research Project, enabling students to gain both theoretical knowledge and foundational research experience.
3. **Module-III:** A comprehensive coursework-focused track, ideal for students aiming to build strong conceptual understanding without a major research component.
4. **Core Subjects:** The curriculum includes key areas such as Education in India with a special focus on the Northeast region, Comparative Education, Philosophical and Sociological Foundations of Education, and Research Methodology. These subjects are designed to provide a holistic understanding of educational systems, theories, and practices in diverse contexts.

Mode of Evaluation:

1. **Internal Assessment (IA):** Each paper carries 20 marks allocated for continuous internal evaluation, which may include assignments, presentations, class participation, and periodic tests to ensure consistent academic engagement.
2. **Term-End Examination (TE):** A comprehensive written examination of 75 marks per paper is conducted at the end of each semester to assess students' theoretical understanding and conceptual clarity.
3. **Attendance (5 Marks):** Attendance is an integral component of evaluation and is awarded as follows:
 - 95% or above: 5 Marks
 - 90%–94%: 4 Marks
 - 85%–89%: 3 Marks
 - 80%–84%: 2 Marks
 - 75%–79%: 1 Mark
4. **Dissertation:** The Dissertation is a vital component of the academic programme in the Department of Education, designed to cultivate advanced research aptitude, critical inquiry, and scholarly writing skills among students. It serves as an opportunity for learners to engage deeply with contemporary educational issues, particularly those relevant to the regional, national, and global contexts. Under the guidance of experienced faculty supervisors, students are encouraged to identify meaningful research problems, review relevant literature, design appropriate methodologies, and undertake systematic investigation leading to original findings and evidence-based conclusions. Through this scholarly engagement, the department aims to develop reflective practitioners and research-oriented educators who can contribute effectively to educational innovation, policy discourse, and the advancement of knowledge in the field of education.

Course Structure

MODEL – I

Course Structure for One year PG Diploma in Education /One Year MA in Education with Coursework & Research/Two Years M.A. in Education with Research

SEMESTER I						
Sl. No.	Course Code	Course Title	Course Level	Marks	Credit Distributio	Total

				IA	TE	Total	L	T	P	
1.	EDU/MJ/501	Education In India with Reference to Northeast India	400	25	75	100	3	1	0	4
2.	EDU/MJ/502	Comparative Education	400	25	75	100	3	1	0	4
3.	EDU/MJ/503	Educational Technology	400	25	75	100	3	1	0	4
4.	EDU/MJ/504	Preparation of Research Synopsis and Presentation	400	25	75	100	3	1	0	4
5.	EDU/MJ/505	Research Methodology in Education-I	500	25	75	100	3	1	0	4

Skill Enhancement Course

Total	-			500		20
--------------	---	--	--	------------	--	-----------

Note: L: Lecture; T: Tutorial; P: Practical; IA: Internal Assessment; TE: Term-End/Terminal Examination

SEMESTER II

Sl. No.	Course Code	Course Title	Course Level	Marks			Credit Distributio			Total
				IA	TE	Total	L	T	P	
1.	EDU/MJ/506	Philosophical Foundations of Education	400	25	75	100	3	1	0	4
2.	EDU/MJ/507	Research Methodology in Education-II	500	25	75	100	3	1	0	4
3.	EDU/MJ/508	Tool Construction and Standardization	400	25	75	100	3	1	0	4

Departmental Electives (A student has to opt any two papers based on their interest and career goals)

4.	EDU/MJ-E/509	Educational Measurement and Evaluation	400	25	75	100	3	1	0	4
	EDU/MJ-E/510	Curriculum Planning and Development	400	25	75	100	3	1	0	4
	EDU/MJ-E/511	Guidance and Counselling in Education	400	25	75	100	3	1	0	4
	EDU/MJ-E/512	Adult and Continuing Education	400	25	75	100	3	1	0	4
	EDU/MJ-E/513	Teacher Education	400	25	75	100	3	1	0	4

Skill Enhancement Course

Total	-			500		20
--------------	---	--	--	------------	--	-----------

Note: A student has to opt for any three papers from EDU/MJ/509, EDU/MJ/510, EDU/MJ/511, EDU/MJ/512, EDU/MJ/513, EDU/MJ/514.

Exit option with PG Diploma after the first year or two semesters with the completion of courses equivalent to 40 credits OR Entry to One-Year M.A. in Education with Research

SEMESTER III & IV

Sl. No.	Course Code	Course Title	Course Level	Marks			Credit Distribution			Total
				IA	TE	Total	L	T	P	
1.	EDU/MJ/699*	Research Project (Dissertation)	500	100	400	500	0	0	40	40
Skill Enhancement Course										
Total						500				20
<i>*At the end of the semester, students must present an individual dissertation of at least 20,000 words based on their chosen research topic, which will be evaluated by internal and external examiners.</i>										
<i>M.A. in Education with Research on completion of courses equal to a minimum of 80 credits</i>										

MODEL – II**Course Structure for one year PG Diploma in Education / Two Years M.A. in Education with Coursework & Research**

SEMESTER I										
Sl. No.	Course Code	Course Title	Course Level	Marks			Credit Distribution			Total
				IA	TE	Total	L	T	P	
1.	EDU/MJ/501	Education In India with Reference to Northeast India	400	25	75	100	3	1	0	4
2.	EDU/MJ/502	Comparative Education	400	25	75	100	3	1	0	4
3.	EDU/MJ/503	Educational Technology	400	25	75	100	3	1	0	4
4.	EDU/MJ/504	Preparation of Research Synopsis and Presentation	400	25	75	100	3	1	0	4
5.	EDU/MJ/505	Research Methodology in Education-I	500	25	75	100	3	1	0	4
Skill Enhancement Course										
Total			-			500				20
Note: L: Lecture; T: Tutorial; P: Practical; IA: Internal Assessment; TE: Term-End/Terminal Examination										
SEMESTER II										
Sl. No.	Course Code	Course Title	Course Level	Marks			Credit Distribution			Total
				IA	TE	Total	L	T	P	
1.	EDU/MJ/506	Philosophical Foundations of Education	400	25	75	100	3	1	0	4
2.	EDU/MJ/507	Research Methodology in Education-II	500	25	75	100	3	1	0	4
3.	EDU/MJ/508	Tool Construction and Standardization	400	25	75	100	3	1	0	4
Departmental Electives (A student has to opt any two papers based on their interest and career goals)										
4.	EDU/MJ-E/509	Educational Measurement and Evaluation	400	25	75	100	3	1	0	4

	EDU/MJ-E/510	Curriculum Planning and Development	400	25	75	100	3	1	0	4
	EDU/MJ-E/511	Guidance and Counselling in Education	400	25	75	100	3	1	0	4
	EDU/MJ-E/512	Adult and Continuing Education	400	25	75	100	3	1	0	4
	EDU/MJ-E/513	Teacher Education	400	25	75	100	3	1	0	4

Skill Enhancement Course

Total	-			500		20
--------------	---	--	--	------------	--	-----------

Exit option with PG Diploma after the first year or two semesters with the completion of courses equivalent to 40 credits OR Entry to One-Year M.A. in Education with Research

SEMESTER III

Sl. No.	Course Code	Course Title	Course Level	Marks			Credit Distribution			Total
				IA	TE	Total	L	T	P	
1.	EDU/MJ/601	Sociological Foundations of Education	500	25	75	100	3	1	0	4
2.	EDU/MJ/602	Higher Education and Economics of Education in India	500	25	75	100	3	1	0	4
3.	EDU/MJ/603*	Engaging with Community	500	25	75	100	0	1	3	4
4.	EDU/MJ/604	Psychological Foundations of Education	500	25	75	100	3	1	0	4
5.	EDU/MJ/605	Educational Planning, Administration and Leadership	500	25	75	100	3	1	0	4

Skill Enhancement Course

Total	-			500		20
--------------	---	--	--	------------	--	-----------

**Students, in groups, will conduct a five-day field visit to an identified rural or tribal site in Arunachal Pradesh to observe, experience, and understand the local education system, community life, and socio-cultural dynamics. Each student must submit a Field Report at the end of the semester for evaluation and grading.*

SEMESTER IV

Sl. No.	Course Code	Course Title	Course Level	Marks			Credit Distribution			Total
				IA	TE	Total	L	T	P	
1.	EDU/MJ/700*	Research Project (Dissertation)	500	100	400	500	0	0	20	4

Skill Enhancement Course

Total				500		20
--------------	--	--	--	------------	--	-----------

**At the end of the semester, students must present an individual dissertation of at least 20,000 words based on their chosen research topic, which will be evaluated by internal and external examiners.*

M.A. in Education with Course work and Research on completion of courses equal to a minimum of 80 credits

MODEL – III
(PG Diploma in Education/1-Year M.A. in Education with Coursework/2-Year M.A. in Education with Coursework)

SEMESTER I										
Sl. No.	Course Code	Course Title	Course Level	Marks			Credit Distribution			Total
				IA	TE	Total	L	T	P	
1.	EDU/MJ/501	Education In India with Reference to Northeast India	400	25	75	100	3	1	0	4
2.	EDU/MJ/502	Comparative Education	400	25	75	100	3	1	0	4
3.	EDU/MJ/503	Educational Technology	400	25	75	100	3	1	0	4
4.	EDU/MJ/504	Preparation of Research Synopsis and Presentation	400	25	75	100	3	1	0	4
5.	EDU/MJ/505	Research Methodology in Education-I	500	25	75	100	3	1	0	4
<i>Skill Enhancement Course</i>										
Total			-			500				20
<i>Note: L: Lecture; T: Tutorial; P: Practical; IA: Internal Assessment; TE: Term-End/Terminal Examination</i>										
SEMESTER II										
Sl. No.	Course Code	Course Title	Course Level	Marks			Credit Distribution			Total
				IA	TE	Total	L	T	P	
1.	EDU/MJ/506	Philosophical Foundations of Education	400	25	75	100	3	1	0	4
2.	EDU/MJ/507	Research Methodology in Education-II	500	25	75	100	3	1	0	4
3.	EDU/MJ/508	Tool Construction and Standardization	400	25	75	100	3	1	0	4
Departmental Electives (A student has to opt any two papers based on their interest and career goals)										
4.	EDU/MJ-E/509	Educational Measurement and Evaluation	400	25	75	100	3	1	0	4
	EDU/MJ-E/510	Curriculum Planning and Development	400	25	75	100	3	1	0	4
	EDU/MJ-E/511	Guidance And Counselling in Education	400	25	75	100	3	1	0	4
	EDU/MJ-E/512	Adult and Continuing Education	400	25	75	100	3	1	0	4
	EDU/MJ-E/513	Gender Studies	400	25	75	100	3	1	0	4
<i>Skill Enhancement Course</i>										
Total			-			500				20
<i>Exit option with PG Diploma after the first year or two semesters with the completion of courses equivalent to 40 credits OR Entry to One-Year M.A. in Education with Research</i>										
SEMESTER III										
Sl. No.	Course Code	Course Title	Course Level	Marks			Credit Distribution			Total

				IA	TE	Total	L	T	P	I
1.	EDU/MJ/601	Sociological Foundations of Education	500	25	75	100	3	1	0	4
2.	EDU/MJ/602	Higher Education and Economics of Education in India	500	25	75	100	3	1	0	4
3.	EDU/MJ/603*	Engaging with Community	500	25	75	100	0	1	3	4
4.	EDU/MJ/604	Psychological Foundations of Education	500	25	75	100	3	1	0	4
5.	EDU/MJ/605	Educational Planning, Administration and Leadership	500	25	75	100	3	1	0	4

Skill Enhancement Course

Total			-			500				20
--------------	--	--	---	--	--	------------	--	--	--	-----------

**Students, in groups, will conduct a five-day field visit to an identified rural or tribal site in Arunachal Pradesh to observe, experience, and understand the local education system, community life, and socio-cultural dynamics. Each student must submit a Field Report at the end of the semester for evaluation and grading.*

SEMESTER IV

Sl. No.	Course Code	Course Title	Course Level	Marks			Credit Distribution			Total
				IA	TE	Total	L	T	P	
1.	EDU/MJ/606	Population Education	500	25	75	100	3	1	0	4
2.	EDU/MJ/607	Environmental Education	500	25	75	100	3	1	0	4
3.	EDU/MJ/608	Human Rights, Value & Peace Education	500	25	75	100	3	1	0	4
4.	EDU/MJ/609	Practicum (Psychological Tests, Experiments and ICT)	500	25	75	100	0	1	3	4
5.	EDU/MJ/610	Teacher Education	500	25	75	100	3	1	0	4

Skill Enhancement Course

Total			-			500				20
--------------	--	--	---	--	--	------------	--	--	--	-----------

M.A. in Education with Course work on completion of courses equal to a minimum of 80 credits

Fee structure for Master of Arts in Education

Sl.No.	Heads	Amounts (in ₹)			
		Sem. I	Sem. II	Sem. III	Sem. IV
1.	Admission Fee (Annual)	1,000		1,000	
2.	Registration Fee	400			
3.	Tuition Fee (Every Semester)	2,000	2,000	2,000	2,000
4.	Development Fee (Annual)	1,000		1,000	
5.	Identity Card Fee (Annual)	100		100	
6.	Students' Union Fee (Annual)	400		400	
7.	Games And Sports Fee (Annual)	400		400	
8.	Youth Welfare Fee (Annual)	300		300	
9.	Magazine Fee (Annual)	200		200	
10.	Continuation Fee		100		100
11.	Transportation (Bus Service) Fee	300		300	
12.	Field work Fee			1,000	
Total for Each Semester (in ₹)		6,100	2,100	6,700	2,100
13.	Caution Money (<i>to be paid one-time during the admission to First Semester</i>)*	1,000			
Grand Total (in ₹)		7,100	2,100	6,700	2,100
Total Course Fees (in ₹)		18,000/-			

*Refundable at the end of the PG Diploma/Programme.

Department of English

Preamble:

The NEP 2020, with its objective of giving a new shape and dimension to the existing educational scenario in the country by incorporating indigenous, national and international features, paints a vibrant vision for higher education. With a focus on reducing the number of dropouts, and increasing employability and diverse skills, the NEP 2020 envisions a curriculum that is conducive to all types of learners. Thus, taking into account the various requirements, and the need for interdisciplinary learning, the Faculty Board of Studies of English, Dept of English

has designed the present Post Graduate Programme in English to meet the set objectives as mentioned in the NEP 2020.

English Studies is taking on an increasingly important role against the backdrop of the current global scenario. With the rise of Artificial Intelligence and a shift towards dependence on it, the ever-important questions of humanity, creativity, and critical enquiry have been brought to the forefront once again. Thus, the Post Graduate programme in English, 2025, has been designed with the aim to provide the students with both hard and soft skills to negotiate the ever-changing environment around them. While Literary studies will continue to function as the core component of the syllabus, it also includes the mandate of the National Education Policy 2020, advocating increasing vocationalisation of curricula and, accordingly, several skill-based courses have been designed to lend the learners a competitive edge when it comes to selection for employment and further research positions.

Introduction:

The Post Graduate Programme in English syllabus offers a plethora of intensive courses with Major and Research components. In keeping with the NEP 2020 mandate for encouraging interdisciplinary learning, the courses have been designed taking into account the relevance of several other fields to English Studies. The facility for choosing from various models and the option of an early exit after two semesters will provide the students with the necessary space to align their learning experiences.

The core elements of English Literary Studies have been retained over the first two semesters, in order to ensure that the learners acquire a comprehensive knowledge of the socio-political, aesthetic, historical and literary dimensions of literature from across the world. This has been augmented by the introduction of courses on literary theory and criticism, and other courses leaning on interdisciplinarity, to encourage the learners to critically engage with literary studies, and other aesthetic and social discourse around them. The introduction of research elements in two of the three models provided to the students offers an opportunity to put their learned skills to practice, and to contribute to knowledge production and critical discourse in their respective field of studies, and the larger society beyond that.

Programme Educational Objectives (PEOs):

The objectives of the M.A. in English Programme are as follows:

PEO-1: To develop a deeper and wider understanding of literatures in English and other languages from around the world

PEO-2: To develop literary sensibilities and different aesthetic forms in the study of literature

PEO-3: To equip the students with a broad understanding of critical social and aesthetic theory and their application to the analysis of literature

PEO-4: To facilitate the development of necessary creative, analytic, and technical skills in the students to equip them for a career in diverse fields related to language, literature, culture, and beyond.

Programme Outcomes (POs):

In keeping with the objectives of the course, the following are the areas in which the students will equip themselves:

PO1: Foundational Knowledge

They will develop a good grasp on the foundational knowledge of literature from around the world, with a focus on the technicalities of literary forms and sensibilities, alongside an understanding of Indian literature and its various forms and contexts.

PO2: Critical Thinking

They will be able to develop critical thinking abilities and have a broad understanding of the prior works of important thinkers.

PO3: Analytical Skills

They will have developed skills to analyse literary and cultural texts, and see the associations of these texts with their everyday reality.

PO4: Employability

The students will be equipped with the skills necessary for a career in academics and other related fields.

Programme Specific Outcomes (PSOs):

PSO 1: The students will develop an understanding of the major literary and cultural texts and their contexts.

PSO 2: The students will be able to develop critical thinking and analytical abilities to deconstruct literary texts.

PSO 3: The students will develop an understanding of literature and its relation to society and culture.

PSO 4: The students will develop varied skills related to language and literature.

PSO 5: The student will be able to demonstrate competencies required for employment in avenues related to the discipline.

Faculty Members:

Sl. No.	Name of Faculty	Designation
1.	Dr. Razzeko Delley (M.A., Ph.D.)	Associate Professor & HoD
2.	Dr. Karyir Riba (M.A., M.Phil., Ph.D.)	Assistant Professor

STRUCTURE OF POSTGRADUATE COURSES OF STUDY IN ENGLISH

The MA course carries 80 credits in total, distributed evenly across all Semesters (20 each).

Model-I
(COURSE STRUCTURE FOR 2-YEAR PG (COURSE WORK & RESEARCH))

SEMESTER I									
Course Code	Course Title	Course Level	Credit Distribution				Marks		
			L	T	P	Total	IA	TE	Total
ENG/MJ/501	European Fiction	400	3	1	0	4	25	75	100
ENG/MJ/502	World Literature	400	3	1	0	4	25	75	100
ENG/MJ/503	Indian Writing in English and Translation	400	3	1	0	4	25	75	100
ENG/MJ/504	Literary Theory and Criticism	500	3	1	0	4	25	75	100
ENG/MJ/505	Research Methodology in English and Publication Ethics	500	3	1	0	4	25	75	100

<i>Skill Enhancement Course (SEC)</i>									
Total			20				500		
SEMESTER II									
Course Code	Course Title	Course Level	Credit Distribution				Marks		
			L	T	P	Total	IA	TE	Total
ENG/MJ/506	Poetry I	400	3	1	0	4	25	75	100
ENG/MJ/507	Northeast Studies	400	3	1	0	4	25	75	100
ENG/MJ/508	Literature and Environment	500	3	1	0	4	25	75	100
ENG/MJ/509	Postcolonial and Decolonial Studies	400	3	1	0	4	25	75	100
ENG/MJ-E/510	American Literature	400	3	1	0	4	25	75	100
ENG/MJ-E/511	MOOCs through SWAYAM	400				4			100
<i>Skill Enhancement Course (SEC)</i>									
Total			20				500		
SEMESTER III									
Course Code	Course Title	Course Level	Credit Distribution				Marks		
			L	T	P	Total	IA	TE	Total
ENG/MJ/512	Poetry II	500	3	1	0	4	25	75	100
ENG/MJ/513	Gender and Literature	500	3	1	0	4	25	75	100
ENG/MJ/514	Drama	500	3	1	0	4	25	75	100
ENG/MJ-E/515	Arunachal Pradesh Literary and Cultural Studies	500	3	1	0	4	25	75	100
ENG/MJ-E/516	Introduction to Cultural Studies	500	3	1	0	4	25	75	100
ENG/MJ-E/517	Introduction to Digital Humanities	500	3	1	0	4	25	75	100
ENG/MJ-E/518	MOOCs through SWAYAM	500				4			100
<i>Skill Enhancement Course (SEC)</i>									
Total			20				500		
SEMESTER IV									
Course Code	Course Title	Course	Credit				Marks		

		Level	Distribution				IA	TE	Total
			L	T	P	Total			
ENG/MJ/519	Dissertation	500				20			

Scheme of Evaluation/ Examination:

All students shall be subjected to the process of continuous evaluation and assessment. Accordingly, a student shall have to attend and duly pass in at least two Internal Assessment tests out of three tests, and End Semester Examination. The structure of these Internal Assessment Tests and End Semester Examinations shall be as follows:

End Semester Examination	Internal Assessment Tests
75	25

Internal Assessment:

For the purpose of calculating the SGPA, the best two of the three Internal Assessment tests taken shall be considered. Attending two Internal Assessment tests out of three shall be compulsory.

1. Two of the three Internal Assessment tests shall be in written form (Sessional Tests)
2. One Internal Assessment test shall be assignments like a term paper, book review, group discussion, PowerPoint presentation or even another written test, and the format to apply shall be announced by the course teacher.

The minimum pass marks at the End Semester Examination shall be 40% in each paper and 40% in aggregate. The minimum pass marks at the internal assessment tests shall be 40% in each paper.

Fee structure for Master of Arts in English

Sl.No.	Heads	Amounts (in ₹)			
		Sem. I	Sem. II	Sem. III	Sem. IV
1.	Admission Fee (Annual)	1,000		1,000	
2.	Registration Fee	400			
3.	Tuition Fee (Every Semester)	2,000	2,000	2,000	2,000
4.	Development Fee (Annual)	1,000		1,000	

5.	Identity Card Fee (Annual)	100		100	
6.	Students' Union Fee (Annual)	400		400	
7.	Games And Sports Fee (Annual)	400		400	
8.	Youth Welfare Fee (Annual)	300		300	
9.	Magazine Fee (Annual)	200		200	
10.	Continuation Fee		100		100
11.	Transportation (Bus Service) Fee	300		300	
12.	Field work Fee				1,000
Total for Each Semester (in ₹)		6,100	2,100	5,700	3,100
13.	Caution Money (<i>to be paid one-time during the admission to First Semester</i>) *	1,000			
Grand Total (in ₹)		7,100	2,100	5,700	3,100
Total Course Fees (in ₹)		18,000/-			

*Refundable at the end of the PG Diploma/Programme.

Department of Hindi

The Department of Hindi is committed to fostering excellence in the study of Hindi language, literature and culture. Rooted in the rich literary traditions of India, the department seeks to create an engaging academic environment that promotes critical inquiry, creativity and intellectual growth among students.

Aligned with the vision of the National Education Policy (NEP 2020) and the Indian Knowledge System (IKS), the department emphasizes an interdisciplinary and holistic approach to learning. It integrates traditional knowledge with contemporary perspectives, enabling students to develop a deeper understanding of literary, cultural and social discourses.

The department currently offers a two-year postgraduate programme (M.A. in Hindi) and is set to introduce a Ph.D. programme from the academic session 2026. The curriculum is designed to cover diverse areas including classical and modern literature, literary theory and criticism, language studies and research methodology.

In addition to classroom teaching, the department actively organizes seminars, workshops, literary events, talks and extension activities to enhance students' academic exposure and research skills. It encourages participation in co-curricular and community-oriented programmes, thereby nurturing socially aware and culturally grounded individuals. With a focus on academic thoroughness and cultural sensitivity, the Department of Hindi aspires to produce skilled scholars, effective communicators and responsible citizens who can contribute meaningfully to academia and society.

हिन्दी विभाग:

हिंदी विभाग की स्थापना अगस्त, 2025 में हुई। इसके बाद 8 सितंबर, 2025 से स्नातकोत्तर कक्षाओं का विधिवत आरंभ किया गया, जिसमें 20 विद्यार्थियों ने प्रवेश लिया। हिंदी विभाग हिंदी भाषा, साहित्य एवं संस्कृति के अध्ययन में उत्कृष्टता को बढ़ावा देने हेतु प्रतिबद्ध है। भारतीय साहित्यिक परंपराओं की समृद्ध विरासत में निहित यह विभाग विद्यार्थियों के लिए एक सशक्त शैक्षिक वातावरण निर्मित करने का प्रयास करता है, जो उनमें समालोचनात्मक चिंतन, सृजनात्मकता एवं बौद्धिक विकास को प्रोत्साहित करता है।

राष्ट्रीय शिक्षा नीति (NEP 2020) एवं भारतीय ज्ञान प्रणाली (IKS) की दृष्टि के अनुरूप, विभाग शिक्षण में अंतःविषयक एवं समग्र दृष्टिकोण को अपनाता है। यह पारंपरिक ज्ञान को समकालीन परिप्रेक्ष्यों के साथ समन्वित करते हुए विद्यार्थियों को साहित्यिक, सांस्कृतिक एवं सामाजिक विमर्शों की गहन समझ विकसित करने में सहायक बनाता है।

विभाग वर्तमान में दो वर्षीय स्नातकोत्तर कार्यक्रम (एम.ए. हिंदी) संचालित कर रहा है तथा शैक्षणिक सत्र 2026 से पी-एच.डी. कार्यक्रम प्रारंभ करने की योजना है। पाठ्यक्रम में प्राचीन एवं आधुनिक साहित्य, साहित्य सिद्धांत एवं समालोचना, भाषा अध्ययन तथा शोध पद्धति जैसे विविध विषयों को समाहित किया गया है।

कक्षा शिक्षण के अतिरिक्त, विभाग विद्यार्थियों के शैक्षणिक अनुभव एवं शोध कौशल को समृद्ध करने हेतु सेमिनार, कार्यशालाओं, साहित्यिक गतिविधियों तथा विस्तार कार्यक्रमों का नियमित आयोजन करता है। साथ ही, सह-पाठ्यक्रम एवं सामुदायिक गतिविधियों में सहभागिता को प्रोत्साहित करते हुए सामाजिक रूप से जागरूक एवं सांस्कृतिक रूप से संवेदनशील व्यक्तित्व के विकास पर बल देता है।

शैक्षणिक उत्कृष्टता एवं सांस्कृतिक संवेदनशीलता को केंद्र में रखते हुए, हिंदी विभाग का उद्देश्य ऐसे दक्ष विद्वानों, प्रभावी संप्रेषकों एवं जिम्मेदार नागरिकों का निर्माण करना है, जो अकादमिक जगत एवं समाज में सार्थक योगदान दे सकें।

Faculty Details:

Sl. No.	Name of Faculty	Designation
1.	Dr. Ing Perme (M.A., BE.d, PhD.)	Associate Professor & Head
2.	Dr. Linu Ronya (M.A., Ph.D.)	Assistant Professor

पाठ्यक्रम संरचना (COURSE STRUCTURE)

मॉडल – 1

दो वर्षीय परास्नातक (शोध) के लिए पाठ्यक्रम संरचना

इस मॉडल के अंतर्गत परास्नातक पाठ्यक्रम में प्रवेश प्राप्त करने वाले छात्र प्रथम एवं द्वितीय सत्र की पढ़ाई के पश्चात 40 क्रेडिट प्राप्त कर यदि पाठ्यक्रम को छोड़ देते हैं तो ऐसे छात्रों को परास्नातक में डिप्लोमा की उपाधि दी जाएगी। शेष छात्र तृतीय एवं चतुर्थ सत्रों में कुल 40 क्रेडिट की शोध परियोजना पूर्ण करेंगे। ऐसे छात्रों को शोध सहित परास्नातक की उपाधि प्रदान की जाएगी।

प्रथम सत्र								
पाठ्यक्रम कोड	पाठ्यक्रम विषय	क्रेडिट्स वितरण				अंक		
		L	T	P	कुल	आंतरिक परीक्षा	सत्रांत परीक्षा	कुल
HIN/MJ/501	हिन्दी साहित्य का इतिहास (आरंभ से रीतिकाल तक)	3	1	0	4	25	75	100
HIN/MJ/502	आदिकालीन काव्य एवं निर्गुण भक्ति काव्य	3	1	0	4	25	75	100
HIN/MJ/503	भारतीय काव्यशास्त्र	3	1	0	4	25	75	100
HIN/MJ/504	हिन्दी कथा साहित्य	3	1	0	4	25	75	100
HIN/MN/505	शोध प्रविधि	3	1	0	4	25	75	100

कुल		20				500		
द्वितीय सत्र								
पाठ्यक्रम कोड	पाठ्यक्रम विषय	क्रेडिट्स वितरण				अंक		
		L	T	P	कुल	आंतरिक परीक्षा	सत्रांत परीक्षा	कुल
HIN/MJ/521	हिन्दी साहित्य का इतिहास – 2 (आधुनिककाल)	3	1	0	4	25	75	100
HIN/MJ/522	सगुण एवं रीतिकाली काव्य	3	1	0	4	25	75	100
HIN/MJ/523	पाश्चात्य काव्यशास्त्र	3	1	0	4	25	75	100
HIN/MJ/524	आधुनिक काव्य	3	1	0	4	25	75	100
HIN/MJ/525	शोध एवं प्रकाशन नैतिकता	3	1	0	4	25	75	100
कुल		20				500		
<p>इस मॉडल के अंतर्गत परास्नातक पाठ्यक्रम में प्रवेश प्राप्त करने वाले विद्यार्थी प्रथम एवं द्वितीय सत्र की पढ़ाई के पश्चात 40 क्रेडिट प्राप्त कर यदि पाठ्यक्रम छोड़ देते हैं तो ऐसे छात्रों को परास्नातक में डिप्लोमा की उपाधि दी जाएगी। शेष छात्र तृतीय एवं चतुर्थ सत्र में कुल 40 क्रेडिट की शोध परियोजना पूर्ण करेंगे। ऐसे छात्र जो कुल 80 क्रेडिट अर्जित करेंगे, उन्हें शोध सहित परास्नातक की उपाधि प्रदान की जाएगी।</p>								
तृतीय सत्र								
पाठ्यक्रम कोड	पाठ्यक्रम विषय	क्रेडिट्स वितरण				अंक		
HIN/RP/659	शोध परियोजना	20				500		
चतुर्थ सत्र								
पाठ्यक्रम कोड	पाठ्यक्रम विषय	क्रेडिट्स वितरण				अंक		
	शोध परियोजना	20				500		
कुल						500		

मॉडल – 2

दो वर्षीय परास्नातक (विषय विशेष के साथ शोध) के लिए पाठ्यक्रम संरचना

इस मॉडल के अंतर्गत परास्नातक पाठ्यक्रम में प्रवेश प्राप्त करने वाले छात्र प्रथम एवं द्वितीय सत्र की पढ़ाई के पश्चात 40 क्रेडिट प्राप्त कर यदि पाठ्यक्रम को छोड़ देते हैं तो ऐसे छात्रों को परास्नातक में डिप्लोमा की उपाधि दी जाएगी। शेष छात्र तृतीय सत्र में कुल 20 क्रेडिट का विषय केंद्रित पत्र पढ़ेंगे एवं चतुर्थ सत्र में कुल 20 क्रेडिट की शोध परियोजना पूर्ण करेंगे। ऐसे छात्रों को परास्नातक की उपाधि (विषय विशेष तथा शोध) प्रदान की जाएगी।

प्रथम सत्र			
		क्रेडिट्स वितरण	अंक

पाठ्यक्रम कोड	पाठ्यक्रम विषय	L	T	P	कुल	आंतरिक परीक्षा	सत्रांत परीक्षा	कुल
HIN/MJ/501	हिन्दी साहित्य का इतिहास (आरंभ से रीतिकाल तक)	3	1	0	4	25	75	100
HIN/MJ/502	आदिकालीन काव्य एवं निर्गुण भक्ति काव्य	3	1	0	4	25	75	100
HIN/MJ/503	भारतीय काव्यशास्त्र	3	1	0	4	25	75	100
HIN/MJ/504	हिन्दी कथा साहित्य	3	1	0	4	25	75	100
HIN/MN/505	शोध प्रविधि	3	1	0	4	25	75	100

कुल

20

500

द्वितीय सत्र

पाठ्यक्रम कोड	पाठ्यक्रम विषय	क्रेडिट्स वितरण				अंक		
		L	T	P	कुल	आंतरिक परीक्षा	सत्रांत परीक्षा	कुल
HIN/MJ/521	हिन्दी साहित्य का इतिहास – 2 (आधुनिककाल)	3	1	0	4	25	75	100
HIN/MJ/522	सगुण एवं रीतिकाली काव्य	3	1	0	4	25	75	100
HIN/MJ/523	पाश्चात्य काव्यशास्त्र	3	1	0	4	25	75	100
HIN/MJ/524	आधुनिक काव्य	3	1	0	4	25	75	100
HIN/MJ/525	शोध एवं प्रकाशन नैतिकता	3	1	0	4	25	75	100
कुल		20				500		

इस मॉडल के अंतर्गत परास्नातक पाठ्यक्रम में प्रवेश प्राप्त करने वाले विद्यार्थी प्रथम एवं द्वितीय सत्र की पढाई के पश्चात 40 क्रेडिट प्राप्त कर यदि पाठ्यक्रम को छोड़ देते हैं तो ऐसे विद्यार्थियों को परास्नातक में डिप्लोमा की उपाधि दी जाएगी। शेष छात्र तृतीय सत्र में 20 क्रेडिट का विषय अध्ययन और चतुर्थ सत्र में 20 क्रेडिट की शोध परियोजना पूर्ण करेंगे। ऐसे छात्र जो कुल 80 क्रेडिट अर्जित करेंगे, उन्हें परास्नातक की उपाधि (विषय और शोध) प्रधान की जाएगी।

तृतीय सत्र

पाठ्यक्रम कोड	पाठ्यक्रम विषय	क्रेडिट्स वितरण				अंक		
		L	T	P	कुल	आंतरिक परीक्षा	सत्रांत परीक्षा	कुल
HIN/MJ/601	हिन्दी साहित्य का इतिहास – 3 (गद्य साहित्य एवं पत्रकारिता)	3	1	0	4	25	75	100
HIN/MJ/602	प्रयोजनमूलक हिंदी	3	1	0	4	25	75	100
HIN/MJ/603	समकालीन काव्य	3	1	0	4	25	75	100
HIN/MJ/604	हिन्दी नाटक एवं एकांकी	3	1	0	4	25	75	100
HIN/MJ/605	हिन्दी आलोचना एवं आलोचक	3	1	0	4	25	75	100
कुल		20				500		

चतुर्थ सत्र			
पाठ्यक्रम कोड	पाठ्यक्रम विषय	क्रेडिट्स वितरण	अंक
HIN/RP/669	शोध परियोजना	20	500
कुल			500

मॉडल – 3

दो वर्षीय परास्नातक (विषय विशेष) के लिए पाठ्यक्रम संरचना

प्रथम सत्र								
पाठ्यक्रम कोड	पाठ्यक्रम विषय	क्रेडिट्स वितरण				अंक		
		L	T	P	कुल	आंतरिक परीक्षा	सत्रांत परीक्षा	कुल
HIN/MJ/501	हिन्दी साहित्य का इतिहास (आरंभ से रीतिकाल तक)	3	1	0	4	25	75	100
HIN/MJ/502	आदिकालीन काव्य एवं निर्गुण भक्ति काव्य	3	1	0	4	25	75	100
HIN/MJ/503	भारतीय काव्यशास्त्र	3	1	0	4	25	75	100
HIN/MJ/504	हिन्दी कथा साहित्य	3	1	0	4	25	75	100
HIN/MN/505	शोध प्रविधि	3	1	0	4	25	75	100
कुल		20				500		

द्वितीय सत्र

पाठ्यक्रम कोड	पाठ्यक्रम विषय	क्रेडिट्स वितरण				अंक		
		L	T	P	कुल	आंतरिक परीक्षा	सत्रांत परीक्षा	कुल
HIN/MJ/521	हिन्दी साहित्य का इतिहास – 2 (आधुनिककाल)	3	1	0	4	25	75	100
HIN/MJ/522	सगुण एवं रीतिकाली काव्य	3	1	0	4	25	75	100
HIN/MJ/523	पाश्चात्य काव्यशास्त्र	3	1	0	4	25	75	100
HIN/MJ/524	आधुनिक काव्य	3	1	0	4	25	75	100
HIN/MJ/525	शोध एवं प्रकाशन नैतिकता	3	1	0	4	25	75	100
कुल		20				500		

इस मॉडल के अंतर्गत परास्नातक पाठ्यक्रम में प्रवेश प्राप्त करने वाले विद्यार्थी प्रथम एवं द्वितीय सत्र की पढ़ाई के पश्चात 40 क्रेडिट प्राप्त कर यदि पाठ्यक्रम छोड़ देते हैं तो ऐसे विद्यार्थी को परास्नातक में डिप्लोमा की उपाधि दी जाएगी। शेष छात्र तृतीय एवं चतुर्थ सत्र में 20-20 क्रेडिट के विषय केंद्रित पाठ्यक्रम का अध्ययन करेंगे। ऐसे छात्र जो कुल 80 क्रेडिट अर्जित करेंगे, उन्हें परास्नातक की उपाधि (विषय विशेष में) प्रदान की जाएगी।

तृतीय सत्र

पाठ्यक्रम कोड	पाठ्यक्रम विषय	क्रेडिट्स वितरण				अंक		
		L	T	P	कुल	आंतरिक परीक्षा	सत्रांत परीक्षा	कुल
HIN/MJ/601	हिन्दी साहित्य का इतिहास – 3 (गद्य साहित्य एवं पत्रकारिता)	3	1	0	4	25	75	100
HIN/MJ/602	प्रयोजनमूलक हिंदी	3	1	0	4	25	75	100
HIN/MJ/603	समकालीन काव्य	3	1	0	4	25	75	100
HIN/MJ/604	हिन्दी नाटक एवं एकांकी	3	1	0	4	25	75	100
HIN/MJ/605	हिन्दी आलोचना एवं आलोचक	3	1	0	4	25	75	100
कुल		20				500		
चतुर्थ सत्र								
पाठ्यक्रम कोड	पाठ्यक्रम विषय	क्रेडिट्स वितरण				अंक		
		L	T	P	कुल	आंतरिक परीक्षा	सत्रांत परीक्षा	कुल
HIN/MJ/621	हिन्दी निबंध एवं आत्मकथा	3	1	0	4	25	75	100
HIN/MJ/622	भाषा विज्ञान एवं हिंदी भाषा	3	1	0	4	25	75	100
HIN/MJ/623	अरुणाचली लोक साहित्य	3	1	0	4	25	75	100
HIN/MJ/624	तुलसीदास के साहित्य का अध्ययन	3	1	0	4	25	75	100
HIN/MJ/625	भारतीय साहित्य	3	1	0	4	25	75	100
कुल		20				500		

Fee structure for Master of Arts in Hindi

Sl.No.	Heads	Amounts (in ₹)			
		Sem. I	Sem. II	Sem. III	Sem. IV
1.	Admission Fee (Annual)	1,000		1,000	
2.	Registration Fee	400			
3.	Tuition Fee (Every Semester)	2,000	2,000	2,000	2,000
4.	Development Fee (Annual)	1,000		1,000	
5.	Identity Card Fee (Annual)	100		100	
6.	Students' Union Fee (Annual)	400		400	
7.	Games And Sports Fee (Annual)	400		400	

8.	Youth Welfare Fee (Annual)	300		300	
9.	Magazine Fee (Annual)	200		200	
10.	Continuation Fee		100		100
11.	Transportation (Bus Service) Fee	300		300	
12.	Field work Fee				1,000
Total for Each Semester (in ₹)		6,100	2,100	5,700	3,100
13.	Caution Money (<i>to be paid one-time during the admission to First Semester</i>) *	1,000			
Grand Total (in ₹)		7,100	2,100	5,700	3,100
Total Course Fees (in ₹)		18,000/-			

*Refundable at the end of the PG Diploma/Programme.

Department of Mass Communication

The Department of Mass Communication & Journalism was established at Arunachal Pradesh University, Pasighat, in August 2025, with the mandate to pioneer professional media education as a constituent unit of the lone state government university in Arunachal Pradesh. The department serves as a vital academic hub, bridging foundational communication theories with the evolving demands of the global media economy. Situated in the historic town of Pasighat, the department provides an intellectually stimulating environment for students to examine the intersection of media, society, and development. By encouraging a scholarly approach to journalism and media production, the department aims to empower the youth of the region to engage effectively with national media discourse and professional industries.

Vision of the Department

To be a centre of excellence in media education that produces professionally competent and ethically responsible communicators who contribute to national development, democratic values, and the advancement of the global information society.

Mission of the Department

- To serve as a premier center for media education, producing professional human resources equipped to serve the state and the nation.
- To provide quality postgraduate and doctoral programs that balance academic rigor with the technical skills required for the evolving communication landscape.
- To build a culture of research and industry collaboration that promotes ethical practices and the documentation of regional heritage.

About the Course

The Master of Arts (M.A.) in Mass Communication & Journalism is an advanced postgraduate program designed to provide students with a deep understanding of media history, communication laws, and professional production techniques. The course offers a systematic study of communication models, editorial management, and the socio-economic impact of media on society. The program balances academic study with practical skill-building, ensuring that classroom learning is reinforced through field-based training and hands-on projects. The curriculum is structured to produce versatile professionals capable of working across Print, Broadcast, and Digital platforms, with a specific focus on Development Communication as a catalyst for social change.

Eligibility

To be eligible for admission, an applicant must hold a Bachelor's degree in any discipline from a UGC-recognized university with a minimum aggregate of 40% marks (or equivalent CGPA). (Relaxation for SC/ST/OBC candidates as per University and State Government norms).

No. of Seats, Semester and Time Duration

- **Intake Capacity:** At present, the department has an intake capacity of 20 students; however, this number is subject to revision as per the decisions of the University and State Government policies.
- **Time Duration:** The program is a full-time course of two academic years.
- **Semester Structure:** The program is divided into four semesters, following the Learning Outcome-based Curriculum Framework (LOCF).
- **Exit Option:** In accordance with the National Education Policy (NEP) 2020, students have the option to exit after successful completion of the first year (two semesters). Such students will be awarded a Postgraduate Diploma in Mass Communication & Journalism.

Mode of Transaction

The department employs a range of instructional methods to ensure academic rigour and professional readiness:

- **Academic Lectures:** Systematic classroom instruction focusing on theoretical foundations and media history.
- **Field Research & Visits:** Organized studies within communities and local media units to understand grassroots communication.

- Industry Expert Lectures: Periodic sessions with senior journalists and media practitioners to provide insights into industry trends.
- Technical Laboratory Work: Supervised practical training in news writing, digital editing, and photography.
- Outreach Programmes: Field-based initiatives where students directly engage with rural or local communities to apply communication strategies for social change and submit comprehensive field reports.
- Institutional Visits & Media Tours: Educational tours to major media houses and academic centres across India for national exposure.
- Professional Internships: Mandatory placements in established media organisations to facilitate the transition to the workforce.

Program Objectives

Objective 1: Impart fundamental knowledge of communication theories, history, law, and ethics.

Objective 2: Develop learners' skills in production management, news writing, reporting, editing, filmmaking, and content creation across all media platforms.

Objective 3: Introduce students to the business of media, including management practices, organizational structures, and the economics of the Indian media industry.

Objective 4: Facilitate hands-on training in research methods, photography, AI applications, and specialized writing for media genres.

Objective 5: Prepare socially responsible media academicians, researchers, and professionals with both a regional focus and a global vision.

Objective 6: Ensure students understand the critical role of media in development communication, particularly concerning the needs of Arunachal Pradesh.

Graduate Attributes (GA)

GA1: The ability to apply communication theories and conduct systematic research to address professional and societal problems.

GA2: The capacity to analyze information objectively and evaluate the broader social impact of media narratives.

GA3: Skill in using modern media tools and production technologies to create and manage high-quality professional content.

GA4: A commitment to professional integrity, democratic values, and the ethical use of media for national development.

GA5: The ability to lead teams and express complex ideas effectively across diverse professional and cultural platforms.

Program Outcomes (PO)

PO1: Demonstrate a comprehensive understanding of communication theories, media laws, and the historical evolution of global and Indian media systems.

PO2: Apply analytical skills to evaluate media content objectively, identify misinformation, and understand the socio-political impact of information on society.

PO3: Exhibit proficiency in multi-platform content creation, including print, broadcast, and digital production using industry-standard tools.

PO4: Design and execute independent research projects using qualitative and quantitative methodologies to solve communication-related challenges.

PO5: Leverage ICT and emerging technologies, such as Generative AI and digital media forensics, for data verification and innovative storytelling.

PO6: Practice journalism and communication with a deep commitment to ethical standards, constitutional values, and social responsibility.

PO7: Lead creative teams and manage media organizational workflows with professional integrity and cultural sensitivity.

PO8: Maintain self-directed learning and adaptive skills to navigate the rapidly changing global media and information economy.

Program Specific Outcomes (PSO)

PSO1: Produce professional-grade content for Print, Broadcast, and Digital media by integrating advanced reporting, editing, and visual design skills.

PSO2: Design participatory communication strategies and outreach programs that address grassroots issues, public health, and ecological sustainability within the region.

PSO3: Execute integrated advertising and public relations campaigns based on consumer behavior insights and modern brand management strategies.

PSO4: Utilize specialized digital tools for information verification and investigative storytelling, ensuring the accuracy and credibility of media output.

Faculty Details

Sl. No.	Name of Faculty	Designation
1.	Dr. Prem Taba (MA., MPhil., Ph. D)	Assistant Professor & HoD (i/c)
2.	Dr. Kombong Darang (MA., MPhil., Ph. D)	Assistant Professor

PROGRAM STRUCTURE

SEMESTER I										
Course Code	Course Title	Credits	Weekly Hours				Scheme of Evaluation			
			L	T	P	TH	IE	PW	ESE	Total
MMC/MJ/501	Introduction to Communication	4	4	0	0	4	25	0	75	100
MMC/MJ/502	History and Development of Media	4	4	0	0	4	25	0	75	100
MMC/MJ/503	Basics of Journalism	4	3	1	0	4	25	0	75	100
MMC/MJ/504	Media Laws and Ethics	4	4	0	0	4	25	0	75	100
MMC/MJ/505	Fundamentals of Photography	2	2	0	4	6	25	20	75	100
MMC/MJ/E/506*	Writing for Media* (OR)	2	3	1	0	4	25		75	100
MMC/MJ/E/507*	AI Applications in Media and Communication*									
	Total	20	20	2	4	26				

PW= Project Work, L= Lecture, T= Tutorial, P= Practical, TH - Total Hours, IE = Internal Exam, ESE= End Semester Exam

*Students must choose one from the two Discipline Specific Elective (DSE) courses.

Note: In courses with a practical component, 20 marks shall be awarded on the basis of the project work assigned by the faculty.

SEMESTER II										
Course Code	Course Title	Credits	Weekly Hours				Scheme of Evaluation			
			L	T	P	TH	IE	PW	ESE	Total
MMC/MJ/551	Advertising and Public Relation Practices	4	3	1	0	4	25	0	75	100
MMC/MJ/552	Development Communication	4	4	0	0	4	25	0	75	100
MMC/MJ/553**	Media Production and Management	4	2	0	4	6	25	20	75	100
MMC/MJ/554	Communication Research	4	3	1	0	4	25	0	75	100
MMC/MJ/E/555*	Health and Environment Communication* (OR)	4	3	1	0	4	25	0	75	100
MMC/MJ/E/556*	Media Entrepreneurship*							0		
Total		20	15	3	4	22				

Exit option with PG Diploma after the first year or two semesters with completion of courses equivalent to 40 credits.

PW= Project Work, L= Lecture, T= Tutorial, P= Practical, TH - Total Hours, IE = Internal Exam, ESE= End Semester Exam

*Students must choose one from the two Discipline Specific Elective (DSE) courses.

** Includes Industrial Visit and Media Exposure Tour

Note: In courses with a practical component, 20 marks shall be awarded on the basis of the project work assigned by the faculty.

SEMESTER III				
Course Code	Course Title	Credits	Weekly Hours	Scheme of Evaluation

			L	T	P	TH	IE	PW	ESE	Total
MMC/MJ/601	Film Studies	4	2	0	4	6	25	20	55	100
MMC/MJ/602	Media, Culture and Society	4	4	0	0	4	25	0	75	100
MMC/MJ/603	Political Communication	4	4	0	0	4	25	0	75	100
MMC/MJ/604	Research and Media Project Proposal	4	2	0	4	6	35	65	0	100
MMC/MJ/I/605	Internship	4	Internship Report: 70 Presentation: 30							100
	Total	20	12	0	8	20				

L= Lecture, T= Tutorial, P= Practical, TH - Total Hours, IE = Internal Exam, ESE= End Semester Exam

*Students must choose one from the two Discipline Specific Elective (DSE) courses.

Note: In courses with a practical component, 20 marks shall be awarded on the basis of the project work assigned by the faculty.

SEMESTER IV									
Course Code	Course Title	Credits	Weekly Hours				Scheme of Evaluation		
			L	T	P	TH	Dissertation/ Media Production	Viva- Voce	Total
MMC/MJ/DP/700	Dissertation and Media Project	20			6	6	70	30	100
	Total	20			6	6			

Fee structure for Master of Arts in Mass Communication

Sl.No.	Heads	Amounts (in ₹)			
		Sem. I	Sem. II	Sem. III	Sem. IV
1.	Admission Fee (Annual)	1,000		1,000	
2.	Registration Fee	400			
3.	Tuition Fee (Every Semester)	3,000	3,000	3,000	3,000
4.	Development Fee (Annual)	1,000		1,000	
5.	Identity Card Fee (Annual)	100		100	
6.	Students' Union Fee (Annual)	400		400	
7.	Games And Sports Fee (Annual)	400		400	
8.	Youth Welfare Fee (Annual)	300		300	
9.	Magazine Fee (Annual)	200		200	
10.	Continuation Fee		4000		4000
11.	Transportation (Bus Service) Fee	300		300	
12.	Laboratory/Studio fee		2000	2000	2000
13.	Field work Fee				
14.	Media Exposure Tour (To be paid one time during admission to the first Semester)	5000			
Total for Each Semester (in ₹)		12,100	9,000	8,700	9,000
15.	Caution Money (to be paid one-time during the admission to First Semester) *	1,000			
Grand Total (in ₹)		13,100	9,000	8,700	9,000
Total Course Fees (in ₹)		39,800/-			

*Refundable at the end of the PG Diploma/Programme.

Department of Mathematics

The Department of Mathematics aims to provide a strong foundation in mathematical concepts, logical reasoning, and analytical skills. The curriculum covers core areas of pure and applied mathematics, with emphasis on problem-solving, theoretical understanding, and practical applications, preparing students for higher studies, research, and competitive examinations

Vision and Mission of Mathematics Department:

Vision

The Mathematics Department aims to be a center of excellence in education and research, fostering analytical thinking, problem-solving skills, and innovative applications of mathematics.

Mission

- To provide strong foundational and advanced mathematical knowledge through quality teaching and learning practices.
- To develop analytical, critical and creative thinking skills among students.
- To promote the use of mathematics in science, technology, engineering and real-world applications.
- To encourage research, exploration and continuous learning in mathematical sciences.
- To foster a supportive and inclusive learning environment that builds confidence and intellectual curiosity.

About the Course

The Master of Science (M.Sc.) in Mathematics is an advanced two-year postgraduate programme designed to provide students with advanced knowledge in pure and applied mathematics, promote analytical and logical thinking, and prepare learners for research, teaching, higher studies (Ph.D.), and careers in academics, industry, and allied fields.

The curriculum is structured to be credit-based, outcome-oriented, and flexible, integrating core mathematical concepts, electives, and research/project components as recommended under NEP 2020.

Eligibility

A candidate seeking admission to the M.Sc. Mathematics programme must fulfil the following requirements:

- Must have passed a Bachelor's Degree from a recognized university with Mathematics as a major/core subject.
- The candidate should have obtained a minimum of 45–50% marks in the qualifying examination (relaxation for reserved categories as per University/State Government norms)

No. of Seats, Semester and Time Duration

- Intake Capacity: At present, the Department has an intake capacity of 20 students; however, this number is subject to revision as per the decision of the University Academic Council and State Government Policies.
- Time Duration: The program is a full-time course of two academic year
- Semester Structure: The program is divided into four semesters, following the learning Outcome-based Curriculum Framework (LOCF).

Faculty Members:

Sl. No.	Name of Faculty	Designation
1.	Dr. Rinchin Drema (M.Sc, Ph.D , B.Ed)	Assistant Professor & HoD (i/c)
2.	Ms. Adam Paksok (M.Sc, B.Ed)	Assistant Professor

COURSE STRUCTURE

Course Structure for Postgraduate Diploma Programme, One- Year/Two Year Postgraduate Programme (with Research), One- Year/Two Year Postgraduate Programme (with coursework and Research), One- Year/Two Year Postgraduate Programme (with coursework) in Department of Mathematics.

MODULE-I

Postgraduate Diploma Programme, One-Year M.Sc. in Mathematical Science (with Research)/ Two- Year M.Sc. in Mathematical Science (with Research)

SEMESTER I								
Course Code	Course Title	Credit Distribution				Marks		
		L	T	P	Total	IA	TE	Total
MAT/MJ/501	Number Theory	3	1	0	4	25	75	100
MAT/MJ/502	Advanced Real Analysis	3	1	0	4	25	75	100

MAT/MJ/503	Abstract Algebra	3	1	0	4	25	75	100
MAT/MJ/504	Differential Equations	3	1	0	4	25	75	100
MAT/MJ/505	Research Methodology & Proposal Writing	3	1	0	4	25	75	100
Skill Enhancement Course (SEC)								
Total					20		500	
SEMESTER II								
Course Code	Course Title	Credit Distribution				Marks		
		L	T	P	Total	IA	TE	Total
MAT/MJ/551	Complex Analysis	3	1	0	4	25	75	100
MAT/MJ/552	Linear Algebra	3	1	0	4	25	75	100
MAT/MJ-E/553	Numerical Analysis	3	1	0	4	25	75	100
MAT/MJ-E /554	Mechanics	3	1	0	4	25	75	100
MAT/MJ-E /555	Tensor Calculus	3	1	0	4	25	75	100
MAT/MJ-E /556	Stochastic Process	3	1	0	4	25	75	100
MAT/MJ-E /557	Python	0	0	4	4	25	75	100
MAT/MJ-E /558	Biomechanics	3	1	0	4	25	75	100
MAT/MJ-E/559	Space Dynamics	3	1	0	4	25	75	100
MAT/MJ/560	Research & Publication Ethics	3	1	0	4	25	75	100
Skill Enhancement Course (SEC)								
Total					20		500	
NOTE: A student has to choose any 2 elective paper from MAT/MJ-E/553-559.								
Exit option with PG Diploma after the first year of two semester with the completion of courses equivalent to 40 credits OR Entry to One-Year M.Sc in Mathematical Sciences with Research.								
SEMESTER III								
Course Code	Course Title	Credit			Marks			
MAT/RP/601	Research Project & Dissertation	20			500			
Skill Enhancement Course (SEC)								
SEMESTER IV								
Course Code	Course Title	Credit			Marks			

		Distribution	
MAT/RP/611	Research Project & Dissertation	20	500
<i>Skill Enhancement Course (SEC)</i>			
Total Credit (Aggregate)		80	500
<i>M.Sc in Mathematical Science with Research on completion of courses equal to a minimum of 80 credits</i>			

Note: L: Lecture; T: Tutorial; P: Practical; IA: Internal Assessment; TE: Term End/Terminal Examination

**At the end of the semester student must present an individual dissertation of at least 20,000 words based on their chosen research topic, which will be evaluated by internal and external examiners.*

Module-II

Postgraduate Diploma Programme, One- Year M.Sc. in Mathematical Science (with Coursework and Research)/ Two- Year M.Sc. in Mathematical Science (with Coursework and Research)

SEMESTER I								
Course Code	Course Title	Credit Distribution				Marks		
		L	T	P	Total	IA	TE	Total
MAT/MJ/501	Number Theory	3	1	0	4	25	75	100
MAT/MJ/502	Advanced Real Analysis	3	1	0	4	25	75	100
MAT/MJ/503	Abstract Algebra	3	1	0	4	25	75	100
MAT/MJ/504	Differential Equations	3	1	0	4	25	75	100
MAT/MJ/505	Research Methodology & Proposal Writing	3	1	0	4	25	75	100
<i>Skill Enhancement Course (SEC)</i>								
Total		20				500		
SEMESTER II								
Course Code	Course Title	Credit Distribution				Marks		
		L	T	P	Total	IA	TE	Total
MAT/MJ/551	Complex Analysis	3	1	0	4	25	75	100
MAT/MJ/552	Linear Algebra	3	1	0	4	25	75	100
MAT/MJ-E/553	Numerical Analysis	3	1	0	4	25	75	100

MAT/MJ-E /554	Mechanics	3	1	0	4	25	75	100
MAT/MJ-E /555	Tensor Calculus	3	1	0	4	25	75	100
MAT/MJ-E /556	Stochastic Process	3	1	0	4	25	75	100
MAT/MJ-E /557	Python	0	0	4	4	25	75	100
MAT/MJ-E /558	Biomechanics	3	1	0	4	25	75	100
MAT/MJ-E/559	Space Dynamics	3	1	0	4	25	75	100
MAT/MJ/560	Research & Publication Ethics	3	1	0	4	25	75	100

Skill Enhancement Course (SEC)**Total****20****500****NOTE: A student has to choose any 2 elective paper from MAT/MJ/DE-553-559.****SEMESTER III**

Course Code	Course Title	Credit Distribution				Marks		
		L	T	P	Total	IA	TE	Total
MAT/MJ/ 601	Calculus of Variations and Integral Equations	3	1	0	4	25	75	100
MAT/MJ-E/602	Fluid Mechanics -I	3	1	0	4	25	75	100
MAT/MJ-E/603	Mathematical Programming	3	0	1	4	25	75	100
MAT/MJ-E/604	Topology	3	1	0	4	25	75	100
MAT/MJ-E/605	Functional Analysis	3	1	0	4	25	75	100
MAT/MJ-E/606	Rings and Modules	3	1	0	4	25	75	100
MAT/MJ-E/607	Mathematical Statistics	3	1	0	4	25	75	100
MAT/MJ-E/608	Continuum Mechanics	3	1	0	4	25	75	100
MAT/MJ-E/609	Measure Theory	3	1	0	4	25	75	100

Skill Enhancement Course (SEC)**Total****20****500****NOTE: A student has to choose any 3 elective papers from MAT/MJ-E/602-609.****SEMESTER IV**

Course Code	Course Title	Credit Distribution	Marks
MAT/RP/699*	Research Project & Dissertation	20	500

Module III
Postgraduate Diploma Programme, One- Year M.Sc. in Mathematical Science
(with Coursework)/ Two-Year M.Sc. in Mathematical Science (with
Coursework)

SEMESTER I								
Course Code	Course Title	Credit Distribution				Marks		
		L	T	P	Total	IA	TE	Total
MAT/MJ/501	Number Theory	3	1	0	4	25	75	100
MAT/MJ/502	Advanced Real Analysis	3	1	0	4	25	75	100
MAT/MJ/503	Abstract Algebra	3	1	0	4	25	75	100
MAT/MJ/504	Differential Equations	3	1	0	4	25	75	100
MAT/MJ/505	Research Methodology & Proposal Writing	3	1	0	4	25	75	100
<i>Skill Enhancement Course (SEC)</i>								
Total		20				500		
SEMESTER II								
Course Code	Course Title	Credit Distribution				Marks		
		L	T	P	Total	IA	TE	Total
MAT/MJ/551	Complex Analysis	3	1	0	4	25	75	100
MAT/MJ/552	Linear Algebra	3	1	0	4	25	75	100
MAT/MJ-E/553	Numerical Analysis	3	1	0	4	25	75	100
MAT/MJ-E/554	Mechanics	3	1	0	4	25	75	100
MAT/MJ-E/555	Tensor Calculus	3	1	0	4	25	75	100
MAT/MJ-E/556	Stochastic Process	3	1	0	4	25	75	100
MAT/MJ-E/557	Python	0	0	4	4	25	75	100
MAT/MJ-E/558	Biomechanics	3	1	0	4	25	75	100
MAT/MJ-E/559	Space Dynamics	3	1	0	4	25	75	100
MAT/MJ/560	Research & Publication Ethics	3	1	0	4	25	75	100

Skill Enhancement Course (SEC)								
Total				20			500	
<i>NOTE: A student has to choose any 2 elective paper from MAT/MJ-E/553-559.</i>								
SEMESTER III								
Course Code	Course Title	Credit Distribution				Marks		
		L	T	P	Total	IA	TE	Total
MAT/MJ/601	Calculus of Variations and Integral Equations	3	1	0	4	25	75	100
MAT/MJ/602	Fluid Mechanics -I	3	1	0	4	25	75	100
MAT/MJ-E/603	Mathematical Programming	3	0	1	4	25	75	100
MAT/MJ-E/604	Topology	3	1	0	4	25	75	100
MAT/MJ-E/605	Functional Analysis	3	1	0	4	25	75	100
MAT/MJ-E/606	Ring Theory	3	1	0	4	25	75	100
MAT/MJ-E/607	Mathematical Statistics	3	1	0	4	25	75	100
MAT/MJ-E/608	Continuum Mechanics	3	1	0	4	25	75	100
MAT/MJ-E/609	Measure Theory	3	1	0	4	25	75	100
Skill Enhancement Course (SEC)								
<i>NOTE: A student has to choose any 3 elective papers from MAT/MJ-E/603-609</i>								
Total				20			500	
SEMESTER IV								
Course Code	Course Title	Credit Distribution				Marks		
		L	T	P	Total	IA	TE	Total
MAT/MJ/611	Graph Theory	3	1	0	4	25	75	100
MAT/MJ/612	Fluid Mechanics-II	3	1	0	4	25	75	100
MAT/MJ-E/613	Fuzzy Set and Fuzzy Logic	3	1	0	4	25	75	100
MAT/MJ-E/614	Wavelets	3	0	1	4	25	75	100
MAT/MJ-E/615	Optimization Techniques	3	1	0	4	25	75	100
MAT/MJ-E/616	Advanced Functional Analysis	3	1	0	4	25	75	100
MAT/MJ-E/617	Differential Geometry	3	1	0	4	25	75	100

MAT/MJ-E/618	Theory of Distribution and Sobolev Spaces	3	1	0	4	25	75	100
MAT/MJ-E/619	Computational Fluid Dynamics	3	1	0	4	25	75	100
Skill Enhancement Course (SEC)								
Total					20		500	
NOTE: A student has to choose any 3 elective papers from MAT/MJ-E/613-619.								

Fee structure for Master of Science in Mathematics

Sl.No.	Heads	Amounts (in ₹)			
		Sem. I	Sem. II	Sem. III	Sem. IV
1.	Admission Fee (Annual)	1,000		1,000	
2.	Registration Fee	400			
3.	Tuition Fee (Every Semester)	2,000	2,000	2,000	2,000
4.	Development Fee (Annual)	1,000		1,000	
5.	Identity Card Fee (Annual)	100		100	
6.	Students' Union Fee (Annual)	400		400	
7.	Games And Sports Fee (Annual)	400		400	
8.	Youth Welfare Fee (Annual)	300		300	
9.	Magazine Fee (Annual)	200		200	
10.	Continuation Fee		100		100
11.	Transportation (Bus Service) Fee	300		300	
12.	Lab Fee	1,500		1,000	
13.	Field work Fee				1,000
Total for Each Semester (in ₹)		7,600	2,100	6,700	3,100
14.	Caution Money (<i>to be paid one-time during the admission to First Semester</i>) *	1,000			
Grand Total (in ₹)		8,600	2,100	6,700	3,100
Total Course Fees (in ₹)		20,500/-			

Department of Social Work

The Department of Social Work is dedicated to prepare students for professional careers in social work, focusing on enhancing human well-being and addressing social issues. The department offers postgraduate programmes such as the Master of Arts in Social Work (MASW),

designed to equip students with the knowledge and skills required for effective intervention and contribute to diverse social contexts.

The curriculum encompasses core areas such as social work theory, human behaviour, social policy, community organization, and research methods. Emphasis is on practical training through fieldwork, internships, and community engagement projects, ensuring students gain hands-on experience in real-world settings.

A key aspect of the department's mission is community engagement. Students and faculty collaborate with local organizations, government agencies, and NGOs to address social issues and promote sustainable development. This engagement not only enriches the academic experience but also positively impacts the local community.

Faculty Members:

Sl. No.	Name of Faculty	Designation
1.	Dr. Menuka Kadu (MSW, Ph.D.)	Assistant Professor & HoD (i/c)
2.	Ms. Ngurang Mana (MSW)	Assistant Professor
3.	Ms. Yeshi Lhamu Naksang (MSW)	Assistant Professor

COURSE STRUCTURE

MODEL – I

(PG Diploma in Social Work/1-Year M.A. in Social Work with Research/2-Year M.A. in Social Work with Research)

SEMESTER I					
Sl.No	Course Code	Course Title	Course Level	Marks	Credits
1.	SW/MJ/501	Social Work-Education and Profession	400	100	3
2.	SW/MJ/502	Working with Individuals	400	100	3
3.	SW/MJ/503	Working with Groups	400	100	3
4.	SW/MJ/504	Working with Communities	400	100	3
5.	SW/FP/505	Field Practicum-I (FP)	500	200	8
Skill Enhancement Course (SEC)					
Total			-	600	20
SEMESTER II					

Sl.No .	Course Code	Course Title	Course Level	Marks	Credits
1.	SW/MJ/551	Social Policy, Development & Social Legislation	400	100	3
2.	SW/MJ/552	Social Work Research	400	100	3
3.	SW/MJ/553	Health, Psychology and Social Work	400	100	3
4.	SW/MJ/554	Social Welfare Administration & Social Action	400	100	3
5.	SW/FP/555	Field Practicum-II (FP)	500	200	8
Skill Enhancement Course (SEC)					
Total			-	600	20
<i>Exit option with PG Diploma after the first year or two semesters with completion of courses equivalent to 40 credits.</i>					
SEMESTER III					
Sl.No .	Course Code	Course Title	Course Level	Marks	Credits
1.	SW/FP/601	Field Practicum-III (FP)	500	200	8
2.	SW/DW/699	Dissertation Work (DW)	500	400	12
Skill Enhancement Course (SEC)					
Total			-	600	20
SEMESTER IV					
Sl.No .	Course Code	Course Title	Course Level	Marks	Credits
1.	SW/FP/651	Field Practicum-IV (FP)	500	200	8
2.	SW/FP/652	Internship for Four Weeks	Non-Credit		
3.	SW/DW/700	Dissertation Work (DW)	500	400	12
Skill Enhancement Course (SEC)					
Total			-	600	20

MODEL – II

(PG Diploma in Social Work/1-Year M.A. in Social Work with Coursework and Research/2-Year M.A. in Social Work with Coursework and Research)

SEMESTER I					
Sl.No.	Course Code	Course Title	Course Level	Marks	Credits
1.	SW/MJ/501	Social Work-Education and Profession	400	100	3
2.	SW/MJ/502	Working with Individuals	400	100	3
3.	SW/MJ/503	Working with Groups	400	100	3
4.	SW/MJ/504	Working with Communities	400	100	3
5.	SW/FP/505	Field Practicum-I (FP)	500	200	8
Skill Enhancement Course (SEC)					
Total			-	600	20
SEMESTER II					

Sl.No.	Course Code	Course Title	Course Level	Marks	Credits
1.	SW/MJ/551	Social Policy, Development & Social Legislation	400	100	3
2.	SW/MJ/552	Community Health and Counselling	400	100	3
3.	SW/MJ/553	Health, Psychology and Social Work	400	100	3
4.	SW/MJ/554	Social Welfare Administration & Social Action	400	100	3
5.	SW/FP/555	Field Practicum-II (FP)	500	200	8
Skill Enhancement Course (SEC)					
Total			-	600	20
<i>Exit option with PG Diploma after the first year or two semesters with completion of courses equivalent to 40 credits.</i>					
SEMESTER III					
Sl.No.	Course Code	Course Title	Course Level	Marks	Credits
1.	SW/MJ/601	Social Work Research	500	100	3
2.	SW/MJ/602	Social Work & Tribal Development	500	100	3
3.	SW/MJ/603	Human Resource & Project Management	500	100	3
4.	SW/MJ/604	Rural & Urban Community Development	500	100	3
5.	SW/MJ/605	Green Social Work & Disaster Management	500	100	3
6.	SW/MJ/606	Social Work with Youth	500	100	3
7.	SW/MJ/607	Gender & Development	500	100	3
8.	SW/FP/608	Field Practicum-III (FP)	500	200	8
Skill Enhancement Course (SEC)					
Total			-	600	20
<i>A student has to opt for any four papers from SW/MJ/601 to SW/MJ/607</i>					
SEMESTER IV					
Sl.No.	Course Code	Course Title	Course Level	Marks	Credits
1.	SW/FP/651	Field Practicum-IV (FP)	500	200	8
2.	SW/DW/699	Dissertation Work (DW)	500	400	12
Skill Enhancement Course (SEC)					
Total			-	600	20

MODEL – III**(PG Diploma in Social Work/1-Year M.A. in Social Work with Coursework/2-Year M.A. in Social Work with Coursework)**

SEMESTER I					
Sl.No.	Course Code	Course Title	Course Level	Marks	Credits
1.	SW/MJ/501	Social Work-Education and Profession	400	100	3
2.	SW/MJ/502	Working with Individuals	400	100	3
3.	SW/MJ/503	Working with Groups	400	100	3
4.	SW/MJ/504	Working with Communities	400	100	3
5.	SW/FP/505	Field Practicum-I (FP)	500	200	8
Identification of a Skill Enhancement Course (SEC)					
Total			-	600	20
SEMESTER II					
Sl.No.	Course Code	Course Title	Course Level	Marks	Credits
1.	SW/MJ/551	Social Policy, Development & Social Legislation	400	100	3
2.	SW/MJ/552	Community Health and Counselling	400	100	3
3.	SW/MJ/553	Health, Psychology and Social Work	400	100	3
4.	SW/MJ/554	Social Welfare Administration & Social Action	400	100	3
5.	SW/FP/555	Field Practicum-II (FP)	500	200	8
Skill Enhancement Course (SEC)					
Total			-	600	20
<i>Exit option with PG Diploma after the first year or two semesters with completion of courses equivalent to 40 credits.</i>					
SEMESTER III					
Sl.No.	Course Code	Course Title	Course Level	Marks	Credits
1.	SW/MJ/601	Social Work Research	500	100	3
2.	SW/MJ/602	Social Work & Tribal Development	500	100	3
3.	SW/MJ/603	Human Resource & Project Management	500	100	3
4.	SW/MJ/604	Rural & Urban Community Development	500	100	3
5.	SW/MJ/605	Green Social Work & Disaster Management	500	100	3
6.	SW/MJ/606	Social Work with Youth	500	100	3
7.	SW/MJ/607	Gender & Development	500	100	3

8.	SW/FP/608	Field Practicum-III (FP)	500	200	8
Skill Enhancement Course (SEC)					
Total			-	600	20
<i>A student has to opt for any four papers from SW/MJ/601 to SW/MJ/607</i>					
SEMESTER IV					
Sl.No.	Course Code	Course Title	Course Level	Marks	Credits
1.	SW/MJ/651	Community Health and Social Work	500	100	3
2.	SW/MJ/652	Family-Centred Social Work	500	100	3
3.	SW/MJ/653	Child Rights and Child Protection	500	100	3
4.	SW/MJ/654	Substance Abuse and HIV AIDS	500	100	3
5.	SW/MJ/655	Social Work with Older Persons	500	100	3
6.	SW/MJ/656	Industrial Relations and Labour Welfare	500	100	3
7.	SW/MJ/657	Disability Studies	500	100	3
8.	SW/FP/699	Field Practicum-IV (FP)	500	200	8
9.	SW/FP/700	Internship for Four weeks	Non-Credit		
Skill Enhancement Course (SEC)					
Total			-	600	20
<i>A student has to opt for any four papers from SW/MJ/651 to SW/MJ/657</i>					

Fee structure for Master of Arts in Social Work

Sl.No.	Heads	Amounts (in ₹)			
		Sem. I	Sem. II	Sem. III	Sem. IV
1.	Admission Fee (Annual)	1,000		1,000	
2.	Registration Fee	400			
3.	Tuition Fee (Every Semester)	2,000	2,000	2,000	2,000
4.	Development Fee (Annual)	1,000		1,000	
5.	Identity Card Fee (Annual)	100		100	
6.	Students' Union Fee (Annual)	400		400	
7.	Games And Sports Fee (Annual)	400		400	
8.	Youth Welfare Fee (Annual)	300		300	
9.	Magazine Fee (Annual)	200		200	
10.	Continuation Fee		100		100

11.	Transportation (Bus Service) Fee	300		300	
12.	Field work Fee		8,000	12,000	
Total for Each Semester (in ₹)		6,100	10,100	17,700	2,100
13.	Caution Money (to be paid one-time during the admission to First Semester)*	1,000			
Grand Total (in ₹)		7,100	10,100	17,700	2,100
Total Course Fees (in ₹)		37,000/-			

*Refundable at the end of the PG Diploma/Programme.

Fees for Fieldwork Practicum (Exclusively for MSW): Expenses related to fieldwork practicum such as Concurrent Engagement, Rural Immersion Camp, Block Placement, Study Tour, Internship, etc., if any, will have to be met by the students themselves at the time of the activity.

Department of Sociology

The Postgraduate Programme in Sociology at Arunachal Pradesh University, Pasighat aims to nurture socially conscious scholars equipped with scientific knowledge, analytical skills, and research competencies.

The curriculum fosters deep understanding of sociological theories, methods, and regional challenges, particularly in Northeast India and Arunachal Pradesh, blending classical foundations with interdisciplinary and applied perspectives. Through student-centered pedagogy emphasising critical thinking, personality development, equality, flexibility, and employability, the department prepares graduates to address contemporary social issues and contribute to visionary research. Rigorous teaching integrates thematic, theoretical, and methodological training, promoting independent learning and holistic work ethic for real-world problem solving.

Faculty Members:

Sr. No.	Name of Faculty	Designation
1	Dr. Terbi Loyi (M.A., MSHCW, Ph.D.)	Assistant Professor & HoD (i/c)

COURSE STRUCTURE**MODEL - I**

(1-Year PG Diploma in Sociology/1-Year M.A. in Sociology with Research/2-Year M.A. in Sociology with Research)

SEMESTER I								
NCrF – 6.0								
Course Code	Course Title	Credit Distribution				Marks		
		L	T	P	Total	IA	TE	Total
SOC/MJ/501	Classical Sociological Thinkers	3	1	0	4	25	75	100
SOC/MJ/502	Sociology of India	3	1	0	4	25	75	100
SOC/MJ/503	Sociology of Social Stratification	3	1	0	4	25	75	100
SOC/MJ/504	Sociology of Education	3	1	0	4	25	75	100
SOC/RM/505	Methodology of Social Research	3	1	0	4	25	75	100
Total Credit (First Semester)					20			
SEMESTER II								
NCrF – 6.0								
Course Code	Course Title	Credit Distribution				Marks		
		L	T	P	Total	IA	TE	Total
SOC/MJ/551	Sociological Theories	3	1	0	4	25	75	100
SOC/MJ/552	Political Sociology	3	1	0	4	25	75	100
SOC/MJ-E/553	Social Demography	3	1	0	4	25	75	100
SOC/MJ-E/554	Sociology of Culture and Media	3	1	0	4	25	75	100
SOC/MJ-E/555	Sociology of Family and Kinship	3	1	0	4	25	75	100
SOC/MJ-E/556	Sociology of Social Movements	3	1	0	4	25	75	100
SOC/RM/557	Writing Research and Ethics	3	1	0	4	25	75	100
Total Credit (Second Semester)					20			
Total Credit in First Year					40			
<i>Note: Student has to choose any two elective papers from SOC/MJ-E/553 to SOC/MJ-E/556.</i>								

Exit option with PG Diploma in Sociology after the first year or two semesters with the completion of courses equivalent to 40 credits OR Entry to 1-Year M.A. in Sociology with Research

SEMESTER III and IV

NCrF – 6.5

Course Code	Course Title	Credit Distribution				Marks
		L	T	P	Total	
SOC/RP/601	Research Project & Dissertation	0	0	40	40	500
Total Credit in Second year					40	
Total Credit (Aggregate)					80	

M.A. in Sociology with Research on completion of courses equal to a minimum of 80 credits

L: Lecture; T: Tutorial; P: Practical; IA: Internal Assessment; TE: Term-End/Terminal Examination

*At the end of the semester, students must present an individual dissertation of at least 20,000 words based on their chosen research topic, which will be evaluated by internal and external examiners.

Model-II

(1-Year PG Diploma in Sociology/2-Year M.A. in Sociology with Coursework and Research)

SEMESTER I

NCrF – 6.0

Course Code	Course Title	Credit Distribution				Marks		
		L	T	P	Total	IA	TE	Total
SOC/MJ/501	Classical Sociological Thinkers	3	1	0	4	25	75	100
SOC/MJ/502	Sociology of India	3	1	0	4	25	75	100
SOC/MJ/503	Sociology of Social Stratification	3	1	0	4	25	75	100
SOC/MJ/504	Sociology of Education	3	1	0	4	25	75	100
SOC/RM/505	Methodology of Social Research	3	1	0	4	25	75	100
Total Credit (First Semester)					20			

SEMESTER II

NCrF – 6.0

Course Code	Course Title	Credit Distribution				Marks		
		L	T	P	Total	IA	TE	Total
SOC/MJ/551	Sociological Theories	3	1	0	4	25	75	100
SOC/MJ/552	Political Sociology	3	1	0	4	25	75	100
SOC/MJ-E/553	Social Demography	3	1	0	4	25	75	100
SOC/MJ-E/554	Sociology of Culture and Media	3	1	0	4	25	75	100
SOC/MJ-E/555	Sociology of Family and Kinship	3	1	0	4	25	75	100
SOC/MJ-E/556	Sociology of Social Movements	3	1	0	4	25	75	100
SOC/RM/557	Writing Research and Ethics	3	1	0	4	25	75	100
Total Credit (Second Semester)		20						
Total Credit in First Year		40						
<i>Note: Student has to choose any two elective papers from SOC/MJ-E/553 to SOC/MJ-E/556.</i>								
<i>Exit option with PG Diploma in Sociology after the first year or two semesters with the completion of courses equivalent to 40 credits OR Entry to 1-Year M.A. in Sociology with Research</i>								
SEMESTER III								
NCrF – 6.5								
Course Code	Course Title	Credit Distribution				Marks		
		L	T	P	Total	IA	TE	Total
SOC/MJ/601	Contemporary Social Theories	3	1	0	4	25	75	100
SOC/MJ/602	Sociology of Development	3	1	0	4	25	75	100
SOC/MJ/603	Sociology of Northeast India	3	1	0	4	25	75	100
SOC/MJ/604	Urban Sociology	3	1	0	4	25	75	100
SOC/MJ/605	Sociology of Health and Illness	3	1	0	4	25	75	100
Total Credit (Third Semester)		20						
SEMESTER IV								
NCrF – 6.5								
Course Code	Course Title	Credit Distribution				Marks		

		L	T	P	Total	
SOC/RP/611	Research Project & Dissertation	0	0	20	20	500
Total Credit (Fourth Semester)					20	
Total Credit in Second Year					40	
Total Credit (Aggregate)					80	
<i>M.A. in Sociology with Research on completion of courses equal to a minimum of 80 credits</i>						

L: Lecture; T: Tutorial; P: Practical; IA: Internal Assessment; TE: Term-End/Terminal Examination

*At the end of the semester, students must present an individual dissertation of at least 20,000 words based on their chosen research topic, which will be evaluated by internal and external examiners.

MODEL-III

(1-Year PG Diploma in Sociology/2-Year M.A. in Sociology with Coursework)

SEMESTER I								
NCrF – 6.0								
Course Code	Course Title	Credit Distribution				Marks		
		L	T	P	Total	IA	TE	Total
SOC/MJ/501	Classical Sociological Thinkers	3	1	0	4	25	75	100
SOC/MJ/502	Sociology of India	3	1	0	4	25	75	100
SOC/MJ/503	Sociology of Social Stratification	3	1	0	4	25	75	100
SOC/MJ/504	Sociology of Education	3	1	0	4	25	75	100
SOC/RM/505	Methodology of Social Research	3	1	0	4	25	75	100
Total					20			
SEMESTER II								
NCrF – 6.0								
Course Code	Course Title	Credit Distribution				Marks		
		L	T	P	Total	IA	TE	Total
SOC/MJ/551	Sociological Theories	3	1	0	4	25	75	100

SOC/MJ/552	Political Sociology	3	1	0	4	25	75	100
SOC/MJ-E/553	Social Demography	3	1	0	4	25	75	100
SOC/MJ-E/554	Sociology of Culture and Media	3	1	0	4	25	75	100
SOC/MJ-E/555	Sociology of Family and Kinship	3	1	0	4	25	75	100
SOC/MJ-E/556	Sociology of Social Movements	3	1	0	4	25	75	100
SOC/RM/557	Writing Research and Ethics	3	1	0	4	25	75	100
Total					20			
Total Credit in First Year					40			
<i>Note: Student has to choose any two elective papers from SOC/MJ-E/553 to SOC/MJ-E/556.</i>								
<i>Exit option with PG Diploma in Sociology after the first year or two semesters with the completion of courses equivalent to 40 credits OR Entry to 1-Year M.A. in Sociology with Research</i>								
SEMESTER III								
NCrF – 6.5								
Course Code	Course Title	Credit Distribution				Marks		
		L	T	P	Total	IA	TE	Total
SOC/MJ/601	Contemporary Social Theories	3	1	0	4	25	75	100
SOC/MJ/602	Sociology of Development	3	1	0	4	25	75	100
SOC/MJ/603	Sociology of Northeast India	3	1	0	4	25	75	100
SOC/MJ/604	Urban Sociology	3	1	0	4	25	75	100
SOC/MJ/605	Sociology of Health and Illness	3	1	0	4	25	75	100
Total Credit (Third Semester)					20			
SEMESTER IV								
NCrF – 6.5								
Course Code	Course Title	Credit Distribution				Marks		
		L	T	P	Total	IA	TE	Total
SOC/MJ/651	Decolonial Theories	3	1	0	4	25	75	100
SOC/MJ/652	Sociology of Globalisation	3	1	0	4	25	75	100
SOC/MJ/653	Sociology of Gender	3	1	0	4	25	75	100

SOC/MJ/654	Sociology of Religion	3	1	0	4	25	75	100
SOC/MJ/655	Sociology of Crime	3	1	0	4	25	75	100
Total Credit (Fourth Semester)		20						
Total Credit in Second Year		40						
Total Credit (Aggregate)		80						
<i>M.A. in Sociology with Coursework on completion of courses equal to a minimum of 80 credits</i>								

L: Lecture; T: Tutorial; P: Practical; IA: Internal Assessment; TE: Term-End/Terminal Examination

*At the end of the semester, students must present an individual dissertation of at least 20,000 words based on their chosen research topic, which will be evaluated by internal and external examiners.

Fee structure for Master of Arts in Sociology

Sl.No.	Heads	Amounts (in ₹)			
		Sem. I	Sem. II	Sem. III	Sem. IV
1.	Admission Fee (Annual)	1,000		1,000	
2.	Registration Fee	400			
3.	Tuition Fee (Every Semester)	2,000	2,000	2,000	2,000
4.	Development Fee (Annual)	1,000		1,000	
5.	Identity Card Fee (Annual)	100		100	
6.	Students' Union Fee (Annual)	400		400	
7.	Games And Sports Fee (Annual)	400		400	
8.	Youth Welfare Fee (Annual)	300		300	
9.	Magazine Fee (Annual)	200		200	
10.	Continuation Fee		100		100
11.	Transportation (Bus Service) Fee	300		300	
12.	Field work Fee				1,000
Total for Each Semester (in ₹)		6,100	2,100	5,700	3,100
13.	Caution Money (to be paid one-time during the admission to First Semester) *	1,000			
Grand Total (in ₹)		7,100	2,100	5,700	3,100
Total Course Fees (in ₹)		18,000/-			

*Refundable at the end of the PG Diploma/Programme.

Department of Tribal Studies

The Department of Tribal Studies focuses on the rich cultural heritage, history, and socio-economic aspects of various tribal communities. Through research, teaching, and community engagement, the department aims to preserve and promote the diverse tribal traditions, languages, and practices prevalent in the tribal communities. The department currently offers postgraduate programmes such as the Master of Arts (M.A.) in Tribal Studies.

The curriculum covers a wide range of topics, including Indigenous Knowledge Systems, Tribal Languages and Literature, Indigenous Rights, Natural Resource Management, Traditional Governance Structures, Cultural Heritage Preservation, and other topics relevant to tribal studies. Students are trained to conduct ethnographic research, analyse tribal issues, and develop strategies for sustainable development.

A core mission of the department is to engage with local tribal communities. Through outreach programmes, collaborative projects, and cultural exchanges, the department works to document and preserve tribal traditions while addressing contemporary issues faced by these communities.

Faculty Members:

Sl. No.	Name of Faculty	Designation
1.	Dr. Eli Doye (M.A., Ph.D.)	Associate Professor & HoD
2.	Dr. Tarh Ramya (M.A., M.Phil., Ph.D.)	Assistant Professor
3.	Ms. Isha Basar (M.A, M.Phil)	Assistant Professor

Course Structure Post-Graduate Programme in Tribal Studies (Exit Option after First Year of Two Semesters with 40 credits)

Model-I (PG Diploma in Tribal Studies/1-Year M.A. in Tribal Studies with Research/2-Year M.A. in Tribal Studies with Research)

SEMESTER I								
Course Code	Course Title	Credit Distribution				Marks		
		L	T	P	Total	IA	TE	Total
TS/MJ/501	Foundations of Tribal Studies	3	1	0	4	25	75	100
TS/MJ/502	Tribal Society and Culture	3	1	0	4	25	75	100
TS/MJ/503	Tribal Languages in India	3	1	0	4	25	75	100
TS/MJ/504	Tribal Customs and Legal Traditions	3	1	0	4	25	75	100
TS/MJ/505	Research Methods and Techniques in Tribal Studies	3	1	0	4	25	75	100
<i>Skill Enhancement Course (SEC)</i>								
Total		20				500		
SEMESTER II								
Course Code	Course Title	Credit Distribution				Marks		
		L	T	P	Total	IA	TE	Total
TS/MJ/551	Theoretical Frameworks in Tribal Studies	3	1	0	4	25	75	100
TS/MJ-E/552	Tribal Societies and Cultures of Arunachal Pradesh	3	1	0	4	25	75	100
TS/MJ-E/553	Tribal Health and Healthcare Practices	3	1	0	4	25	75	100
TS/MJ-E/554	Gender Dynamics in Tribal Societies	3	1	0	4	25	75	100
TS/MJ-E/555	Tribes and Ecology	3	1	0	4	25	75	100
TS/MJ-E/556	Tribal Literature in Northeast India and Arunachal Pradesh	3	1	0	4	25	75	100
TS/MJ-E/557	Tribes, Cultural Tourism, and Entrepreneurship	3	1	0	4	25	75	100
TS/MJ/558*	Fieldwork and Community Engagement	1	0	3	4	25	75	100
<i>Skill Enhancement Course (SEC)</i>								
Total		20				500		
<p>Note: A student has to choose any three elective papers from TS/MJ-E/552 to TS/MJ-E/557.</p> <p>*Students in groups will conduct a two-week cultural immersion fieldwork in an identified field site in Arunachal Pradesh to observe, experience, and learn about unique tribal life and culture. Each student is required to submit a Field Report at the end of the semester for evaluation and grading.</p> <p>Exit option with PG Diploma in Tribal Studies after the first year or two semesters with the completion of courses equivalent to 40 credits OR Entry to 1-Year M.A. in Tribal Studies with Research.</p>								
SEMESTER III								

Course Code	Course Title	Credit	Marks
TS/RP/600*	Research Project & Dissertation	20	500
Skill Enhancement Course (SEC)			
Total		20	500
FOURTH SEMESTER (SEMESTER IV)			
Course Code	Course Title	Credit	Marks
TS/RP/699*	Research Project & Dissertation	20	500
Skill Enhancement Course (SEC)			
Total		20	500
M.A. in Tribal Studies with Research on completion of courses equivalent to 80 credits			

L: Lecture; T: Tutorial; P: Practical; IA: Internal Assessment; TE: Term-End/Terminal Examination

*At the end of the semester, students must present an individual dissertation of at least 20,000 words based on their chosen research topic, which will be evaluated by internal and external examiners.

Model-II

(PG Diploma in Tribal Studies/1-Year M.A. in Tribal Studies with Coursework and Research/2-Year M.A. in Tribal Studies with Coursework and Research)

SEMESTER I								
Course Code	Course Title	Credit Distribution				Marks		
		L	T	P	Total	IA	TE	Total
TS/MJ/501	Foundations of Tribal Studies	3	1	0	4	25	75	100
TS/MJ/502	Tribal Society and Culture	3	1	0	4	25	75	100
TS/MJ/503	Tribal Languages in India	3	1	0	4	25	75	100
TS/MJ/504	Tribal Customs and Legal Traditions	3	1	0	4	25	75	100
TS/MJ/505	Research Methods and Techniques in Tribal Studies	3	1	0	4	25	75	100
Skill Enhancement Course (SEC)								
Total					20	500		
SEMESTER II								
Course Code	Course Title	Credit Distribution				Marks		
		L	T	P	Total	IA	TE	Total
TS/MJ/551	Theoretical Frameworks in Tribal Studies	3	1	0	4	25	75	100
TS/MJ-E/552	Tribal Societies and Cultures of Arunachal Pradesh	3	1	0	4	25	75	100

TS/MJ-E/553	Tribal Health and Healthcare Practices	3	1	0	4	25	75	100
TS/MJ-E/554	Gender Dynamics in Tribal Societies	3	1	0	4	25	75	100
TS/MJ-E/555	Tribes and Ecology	3	1	0	4	25	75	100
TS/MJ-E/556	Tribal Literature in Northeast India and Arunachal Pradesh	3	1	0	4	25	75	100
TS/MJ-E/557	Tribes, Cultural Tourism, and Entrepreneurship	3	1	0	4	25	75	100
TS/MJ/558*	Fieldwork and Community Engagement	1	0	3	4	25	75	100

Skill Enhancement Course (SEC)

Total	20	500
--------------	-----------	------------

Note: A student has to choose any three elective papers from TS/MJ-E/552 to TS/MJ-E/557.

***Students in groups will conduct a two-week cultural immersion fieldwork in an identified field site in Arunachal Pradesh to observe, experience, and learn about unique tribal life and culture. Each student is required to submit a Field Report at the end of the semester for evaluation and grading.**

Exit option with PG Diploma in Tribal Studies after the first year or two semesters with the completion of courses equivalent to 40 credits OR Entry to 1-Year M.A. in Tribal Studies with Coursework and Research.

SEMESTER III

Course Code	Course Title	Credit Distribution				Marks		
		L	T	P	Total	IA	TE	Total
TS/MJ/601	Tribal Religion and Belief Systems	3	1	0	4	25	75	100
TS/MJ/602	Tribal Economy and Livelihood Patterns	3	1	0	4	25	75	100
TS/MJ/603	Tribal Development Approaches and Administration in India	3	1	0	4	25	75	100
TS/MJ/604	Tribal Folklore and Cultural Expressions	3	1	0	4	25	75	100
TS/MJ/605	Tribes and Cultural Resource Management	3	1	0	4	25	75	100

Skill Enhancement Course (SEC)

Total	20	500
--------------	-----------	------------

SEMESTER IV

Course Code	Course Title	Credit	Marks
TS/RP/699*	Research Project & Dissertation	20	500

Skill Enhancement Course (SEC)

Total	20	500
--------------	-----------	------------

M.A. in Tribal Studies with Coursework and Research on completion of courses equivalent to 80 credits

L: Lecture; T: Tutorial; P: Practical; IA: Internal Assessment; TE: Term-End/Terminal Examination

**At the end of the semester, students must present an individual dissertation of at least 20,000 words based on their chosen research topic, which will be evaluated by internal and external examiners.*

Model-III
(PG Diploma in Tribal Studies/1-Year M.A. in Tribal Studies with Coursework/2-Year M.A. in Tribal Studies with Coursework)

SEMESTER I								
Course Code	Course Title	Credit Distribution				Marks		
		L	T	P	Total	IA	TE	Total
TS/MJ/501	Foundations of Tribal Studies	3	1	0	4	25	75	100
TS/MJ/502	Tribal Society and Culture	3	1	0	4	25	75	100
TS/MJ/503	Tribal Languages in India	3	1	0	4	25	75	100
TS/MJ/504	Tribal Customs and Legal Traditions	3	1	0	4	25	75	100
TS/MJ/505	Research Methods and Techniques in Tribal Studies	3	1	0	4	25	75	100
<i>Skill Enhancement Course (SEC)</i>								
Total		20				500		
SEMESTER II								
Course Code	Course Title	Credit Distribution				Marks		
		L	T	P	Total	IA	TE	Total
TS/MJ/551	Theoretical Frameworks in Tribal Studies	3	1	0	4	25	75	100
TS/MJ-E/552	Tribal Societies and Cultures of Arunachal Pradesh	3	1	0	4	25	75	100
TS/MJ-E/553	Tribal Health and Healthcare Practices	3	1	0	4	25	75	100
TS/MJ-E/554	Gender Dynamics in Tribal Societies	3	1	0	4	25	75	100
TS/MJ-E/555	Tribes and Ecology	3	1	0	4	25	75	100
TS/MJ-E/556	Tribal Literature in Northeast India and Arunachal Pradesh	3	1	0	4	25	75	100
TS/MJ-E/557	Tribes, Cultural Tourism, and Entrepreneurship	3	1	0	4	25	75	100
TS/MJ/558*	Fieldwork and Community Engagement	1	0	3	4	25	75	100

Skill Enhancement Course (SEC)								
Total				20			500	
<i>Note: A student has to choose any three elective papers from TS/MJ-E/552 to TS/MJ-E/557.</i>								
<i>*Students in groups will conduct a two-week cultural immersion fieldwork in an identified field site in Arunachal Pradesh to observe, experience, and learn about unique tribal life and culture. Each student is required to submit a Field Report at the end of the semester for evaluation and grading.</i>								
Exit option with PG Diploma in Tribal Studies after the first year or two semesters with the completion of courses equivalent to 40 credits OR Entry to 1-Year M.A. in Tribal Studies with Coursework.								
SEMESTER III								
Course Code	Course Title	Credit Distribution				Marks		
		L	T	P	Total	IA	TE	Total
TS/MJ/601	Tribal Religion and Belief Systems	3	1	0	4	25	75	100
TS/MJ/602	Tribal Economy and Livelihood Patterns	3	1	0	4	25	75	100
TS/MJ/603	Tribal Development Approaches and Administration in India	3	1	0	4	25	75	100
TS/MJ/604	Tribal Folklore and Cultural Expressions	3	1	0	4	25	75	100
TS/MJ/605	Tribes and Cultural Resource Management	3	1	0	4	25	75	100
Skill Enhancement Course (SEC)								
Total				20			500	
SEMESTER IV								
Course Code	Course Title	Credit Distribution				Marks		
		L	T	P	Total	IA	TE	Total
TS/MJ/651	Tribal Situation in Northeast India	3	1	0	4	25	75	100
TS/MJ/652	Tribal Entrepreneurship	3	1	0	4	25	75	100
TS/MJ/653	Tribal Arts and Aesthetics	3	1	0	4	25	75	100
TS/MJ/654	Indigenous Knowledge Systems	3	1	0	4	25	75	100
TS/MJ/655	Tribal Movements in India	3	1	0	4	25	75	100
Skill Enhancement Course (SEC)								
Total				20			500	
M.A. in Tribal Studies with Coursework on completion of courses equivalent to 80 credits								

L: Lecture; T: Tutorial; P: Practical; IA: Internal Assessment; TE: Term-End/Terminal Examination* The students should submit an individual Dissertation of at least 20,000 words based on the research topic chosen by them at the end of the semester and the same will be evaluated by internal and external examiners.

Fee structure for Master of Arts in Tribal Studies

Sl.No.	Heads	Amounts (in ₹)			
		Sem. I	Sem. II	Sem. III	Sem. IV
1.	Admission Fee (Annual)	1,000		1,000	
2.	Registration Fee	400			
3.	Tuition Fee (Every Semester)	2,000	2,000	2,000	2,000
4.	Development Fee (Annual)	1,000		1,000	
5.	Identity Card Fee (Annual)	100		100	
6.	Students' Union Fee (Annual)	400		400	
7.	Games And Sports Fee (Annual)	400		400	
8.	Youth Welfare Fee (Annual)	300		300	
9.	Magazine Fee (Annual)	200		200	
10.	Continuation Fee		100		100
11.	Transportation (Bus Service) Fee	300		300	
12.	Field work Fee		2000		
Total for Each Semester (in ₹)		6,100	4,100	5,700	2,100
13.	Cautions Money (to be paid one-time during the admission to First Semester)*	1,000			
Grand Total (in ₹)		7,100	4,100	5,700	2,100
Total Course Fees (in ₹)		19,000/-			

*Refundable at the end of the PG Diploma/Programme.

Other Fees common to all the Postgraduate departments (as and when applicable):

1. Examination Fee without Practical/Viva Voce	: ₹750.00
2. Examination Fee with Practical/Viva Voce	: ₹1,250.00
3. Marksheet Fee (to be collected with examination fee)	: ₹200.00
4. Duplicate Marksheet	: ₹200.00
5. Duplicate Identity Card	: ₹200.00
6. Provisional Certificate	: ₹200.00
7. Library Card	: ₹200.00
8. Back Paper (BP) Per Paper/Subject	: ₹250.00

***Fees for Field Study/Fieldwork:** Fees for Field Study/Fieldwork shall be decided by concerned departments as per the duration of the fieldwork and distance.

Admission to Various Academic Courses:

The University shall admit eligible students to various postgraduate programmes through a Written Test & Viva-Voce to be conducted by the University.

The Issue and submission of application for admission to the various PG programmes will be through online mode. The candidates seeking admission need to visit the university website www.apupsg.ac.in

Eligibility Criteria to Take Admission in Different Courses:

Programme	Intake Capacity	Eligibility Criteria/ Minimum Qualification for Admission
Master of Commerce (M.Com.)		Bachelor's degree in Commerce from a UGC-recognised institute and secured a CGPA of 4.0 or 40% marks.
Master of Arts (M.A.) in Economics		Bachelor's degree in Economics from a UGC-recognised institute and secured a CGPA of 4.0 or 40% marks.

Master of Arts (M.A.) in Education		Bachelor's degree in Education as an honour subject or as a pass/major subject or bachelor's degree along with B.Ed./B.Ed.(spl.) from a UGC-recognised institute and secured a CGPA of 4.0 or 40% marks.
Master of Arts in Social Work (MASW)		Bachelor's degree in Social Work/any discipline from a UGC-recognised institute and secured a CGPA of 4.0 or 40% marks.
Master of Arts (M.A.) in Tribal Studies		Bachelor's degree in any discipline from a UGC-recognised institute and secured a CGPA of 4.0 or 40% marks.
Master of Arts (M.A.) in English		Bachelor's degree in English from a UGC-recognised institute and secured a CGPA of 4.0 or 40% marks.
Master of Arts (M.A.) in Hindi		Bachelor's degree in Hindi from a UGC-recognised institute and secured a CGPA of 4.0 or 40% marks.
Master of Science in Mathematics		Bachelor's degree in Mathematics from a UGC-recognised institute and secured a CGPA of 4.0 or 40% marks.
Master of Computer Applications		Bachelor's degree in any discipline with at least one paper/courses in Mathematics/ Statistics/ Computer Science at the 10 + 2 or undergraduate level from a UGC-recognised institute and secured a CGPA of 4.0 or 40% marks.
Master of Arts (M.A.) in Mass Communication		Bachelor's degree in any discipline from a UGC-recognised institute and secured a CGPA of 4.0 or 40% marks.
Master of Arts (M.A.) in Sociology		Bachelor's degree in Sociology from a UGC-recognised institute and secured a CGPA of 4.0 or 40% marks.

Mode of Selection:

There shall be dual mode of selection for admission in various PG Programmes. Candidates seeking admission to M.A/M.Sc/M.C.A/MSW/MCOM shall apply through CUET PG conducted by NTA or through Arunachal Pradesh University Common Entrance Test (APUCET) held in the month of July. As per decision taken by the Academic Council of the University, 20% of Seats shall be reserved for admission through CUET PG and 80% shall be filled through APUCET*. The candidates seeking admission through CUET PG mode may apply through submission of necessary form as given in the University website.

The candidates seeking admission through University entrance shall apply through University website. The APUCET is a two-stage written process comprising of the 1st stage Written Test and the 2nd stage Personal Interview. All the eligible candidates are required to

appear for the written test. A shortlisting of candidates for personal interview shall be done based on the result of the written test. The maximum no. of candidates shortlisted for personal interview shall be in the ratio of 3:1 of the total number of available seats in each department. There may be another stage of Group Discussion for programmes such as M.A. in Social Work (MSW) and M.A. in Mass Communication for selected candidates. The eligibility for admission shall be solely based on the merit in the APUCET.

*The detailed information may be found in the **SOP for implementation of dual mode of CUET PG and APUCET** given in the University website

Note: The detailed information is given in the SOP for implementation of CUET PG and APUCET and shall be found in the University website.

Reservation:

The reservation shall be as per the prevailing 80:20 Reservation Policy of the Government of Arunachal Pradesh (i.e., 80% for the APST Category and 20% for the Open Category). A merit list for the Open Category will be prepared based on the marks obtained by all qualified students in the entrance test.

Relaxation:

Special additional weightage, over and above the marks secured in the entrance test, shall be given to Sportspersons (5% for international, 3% for National, and 2% for Regional), NSS Volunteers (3% for participation of 120 hours and above), and NCC Cadets (3% for attaining 'C' Certificate and 2% for attaining 'B' Certificate).

Documents to be Submitted for Admission:

- i. The Head of Department shall admit the provisionally short-listed/selected students on submission of a filled-up admission form with the following documents, which shall be verified at the time of Admission.
 - a. Class X pass certificate and Marksheet
 - b. Class XII pass certificate and Marksheet
 - c. Undergraduate pass certificate and Marksheet
 - d. Category Certificate (APST)
 - e. Sports/NSS/NCC Certificate, if any
 - f. College Leaving Certificate

- g. Migration certificate for registration (Before examination)
 - h. Receipt of admission fees deposited (to be submitted after admission)
 - i. Two passport-size photos (to be used in the admission form and identity card)
 - j. Academic Bank of Credits (ABC) ID card
- ii. The Overall Merit List, Selection List, and Waiting List shall be posted on the University Notice Board and University website www.apupsg.ac.in.
 - iii. Students awaiting their results shall also be eligible to apply. However, they shall have to produce the mark sheet/degree certificate on or before the last date of admission, failing which any provisional selection shall stand cancelled.
 - iv. A student, who has not been registered before the First End Semester Examination, shall be provisionally allowed to sit in the End Semester Examination; but the result of such students shall be kept withheld till he/she is registered. No such withheld result shall be declared after completion of 45 days from the date of notification of the Semester result.
 - v. **Admission granted shall be cancelled at any time** if it is found that the information furnished by the student is false or incorrect, or if, at a later stage, it is found that the student does not fulfil the eligibility criteria prescribed for the programme.

Verification of Students' Academic and Personal Testimonials:

- i. No department shall insist upon a student to submit the original academic and personal certificates and testimonials, except the College Leaving Certificate and Migration Certificate, at the time of submitting the admission form.
- ii. In line with instructions issued by the Ministry of Personnel, Public Grievances & Pension, Department of Administrative Reforms, PG & Pension, the University shall allow self-attestation of documents such as marksheets, birth certificates, etc. by the applicant as a system of verification of the original certificates and testimonials at any stage before the finalisation of the process of admission.
- iii. The department shall physically verify the originals at the time of admission of the student in his/her presence and return them immediately after satisfying themselves about their authenticity and veracity, keeping the attested copies for their record.
- iv. The self-attested testimonials of students shall be held valid and authentic by the University for all purposes and administrative requirements. There shall be physical verification at any time

during the course. Such verification shall be undertaken in the presence of the student and certificates and testimonials thus verified in original shall be returned immediately to the student.

- v. Taking the certificates and testimonials into institutional custody under any circumstances or pretexts shall be strictly prohibited to avoid misuse for blackmailing students who wish to withdraw admission from the department for better prospects or other compulsions.
- vi. In case of any suspicion over the authenticity or genuineness of the testimonials, the reference shall be made to the University or the Board which issued certificate(s) to the student and the admission be subjected to the authentication, but original certificates shall not be retained under any circumstances.

Remittance and Refund of Fees:

- i. The University shall charge fees in advance only for the semester/year in which a student is to engage in academic activities; not for the entire Programme, so that it does not become an impediment to the student's inter institutional mobility.
- ii. If a student wants to withdraw admission, the process of refund of fees shall be as follows:

Category	Percentage of Refund of Fees*	Point of Time When Notice of Withdrawal of Admission is Received in the University
(1)	100%	15 days or more before the formally notified last date of admission.
(2)	90%	Less than 15 days before the formally notified last date of admission.
(3)	80%	15 days or less after the formally notified last date of admission.
(4)	50%	30 days or less, but more than 15 days after formally notified of the last date of admission.
(5)	0%	More than 30 days after being formally notified last date of admission.
<i>*Inclusive of Programme fees and non-tuition fees but exclusive of caution money and security deposit.</i>		

- iii. Fees shall be refunded by the University to an eligible student within fifteen days from the date of receiving a written application from him/her in this regard.

Eligibility for Admission to Examinations:

- i. There shall be at least 180 teaching days along with 40 days for Admissions, Examinations, and preparation for Examinations in each academic year (for 5 working days per week).
- ii. To be eligible for appearing in the End Semester Examination, a student must have a minimum of 75% of attendance. Monthly attendance shall be displayed on the notice board of every department. A copy of monthly attendance shall be sent to the office of the Vice Chancellor for reference.
- iii. Attending two Internal Assessments is a must. The average mark of the two best Internal Assessments shall be the qualifying mark for admission to the examination. Failure in the Internal Assessment will lead to disqualification from admission to the examination.

If a student fails to obtain the stipulated attendance (75%), he/she shall apply through the Head of the Department to the concerned Dean for consideration of shortage in attendance with genuine reasons. Judging the genuineness of the case, the concerned Dean shall grant relaxation in attendance to the tune of a maximum of 5% and the Vice Chancellor shall condone another 5% of attendance, on the recommendation of the concerned Dean.

Examination & Evaluation (NEP)

Scheme of Continuous Internal/External Evaluation (NEP)

All credit courses are evaluated for 100 marks. Internal Assessment component is for 25 marks of which internal assessment is 20 marks and marks of attendance is 05 marks. The end semester University examination is for 75 marks. In case of Practicals, project works, etc. it is 50:50 marks for Internal and End Semester Exams.

Break up of Internal Assessment Marks:

Sl. No.	Scheme of Assessment	Marks	Total Marks
1.	Mid-Semester Exam (Internal Exams)	20 Marks	25 Marks
2.	Percentage of Attendance	5 Marks	

Incentive marks for attendance

As approved in the First Academic Council meeting held on 11/04/2025, there shall be grant of incentive marks for attendance at the end of the semester. NEP encourages such practice and is practiced to reward students having good attendance. However, it is to note that such incentive

marks would be nullified in case of a student securing maximum marks. The following incentive marking shall be granted at the end of the semester for students having attendance: -

1. 95% or more - 5 marks
2. 90% to 94% - 4 marks
3. 85% to 89% - 3 marks
4. 80% to 84% - 2 marks
5. 75% to 79% - 1 mark

Continuous Evaluation and Internal Assessment:

- i. All the students shall be subjected to the process of continuous evaluation and assessment. Accordingly, a student shall have to attend and duly pass in at least two Internal Assessment Tests out of three tests, and End Semester Examination. The structure of these Internal Assessment Tests and End-Semester Examinations shall be 20:80.
- ii. To calculate the Semester Grade Point Average (SGPA), the best two of the three Internal Assessment Tests shall be taken. Attending two Internal Assessment Tests out of three is compulsory.
- iii. The following shall be applicable:
 - a. One of the Internal Assessment Tests shall be in the form of an assignment with a PowerPoint Presentation.
 - b. Internal Assessment Tests for all practical papers shall always be of a practical nature.

In case of exigencies and emergencies such as pandemics, natural disasters, etc., the above criteria for conducting Internal Assessment Tests shall be modified by the Head of the Department with due approval from the concerned/competent authority.

The Minimum Pass Mark/Back Paper and Improvement:

The minimum pass mark in internal assessment, practical, and the End Semester Examination shall be 40% in each paper and 45% in aggregate. The inability to secure the minimum prescribed pass mark in a practical paper/component will result in the student failing that paper.

- i. The marks from the Internal Assessment Test, once submitted, shall be considered final. No supplementary/modification of marks will be accepted after the declaration of the results.
- ii. A student who fails the First Semester Examination shall be out of the programme.

- iii. A student shall not be promoted to the next semester unless he or she passes at least 45% of the total papers in an End-Semester Examination. He or she shall be eligible to take the back-paper examination for the failed papers in the subsequent relevant semester examination(s).
- iv. The question papers of the End Semester Examination shall be of 75 marks to be attempted within a duration of three hours.
- v. The **maximum number of allotted semesters** to complete the PG Programme and clear the course for the award of the degree shall be 8 semesters (4 years).
- vi. The University shall issue a consolidated marks sheet after a student has passed the course showing the Semester Grade Point Average (SGPA) and latest Cumulative Grade Point Average (CGPA) status of the student.
- vii. A student seeking to improve his/her result shall do so by duly applying for the same on payment of the prescribed fee in the next relevant semester examination and this improvement chance shall be availed only once in a course paper to the condition that the result of such an **improvement examination** and back paper shall not be counted towards award of rank and medal.
 - a. A student shall be allowed to seek 'improvement' in not more than two papers per semester provided he/she has secured a passing grade in all the papers that appeared, in the corresponding End-Semester Examination, but is not satisfied with his/her score.
 - b. The student shall not however be required to join the relevant semester for attending classes and to appear in all the internal assessments/practical tests in the concerned paper(s).
- viii. In order to **repeat a paper(s)**, in case of back paper(s), a student shall apply to the office of the CoE through HoD; and if permitted to appear, shall be required to pay the prescribed fee within the stipulated period before commencement of the examination.
- ix. Towards ensuring confidentiality, answer scripts of the End Semester Examinations shall be coded prior to handing them over to the evaluators.
- x. **The End-Semester Practical Examination(s)** shall be conducted by an examination board comprising an External and two Internal Examiners appointed by the Vice Chancellor from a panel of examiners (6 internal and 3 external) recommended by the Head of the Department.
- xi. A candidate who has **failed the 1st Semester Examination shall be out of the programme.** However, such candidates can re-appear in the subsequent 1st Semester End Examination in all

papers as Late candidate. The chance to re-appear in such cases will be limited to one single chance/time.

- xii. All other matters related to assessment, attendance, examination, etc. shall be governed by the ordinances of the University.

Letter Grades and Grade Points Computation for Semester Grade Point Average (SGPA) and Cumulative Grade Point Average (CGPA):

Under the absolute grading system adopted by the University, the marks shall be converted to grades based on pre-determined class intervals. The grading system with the following letter grades shall be adopted in awarding the grades and CGPA under the credit-based semester system.

Grading System

Letter Grade	Grade Point	Percentage (%) of Marks	Class/Division
O (Outstanding)	10	90–100	First
A+ (Excellent)	9	80 or more but less than 90	
A (Very Good)	8	70 or more but less than 80	
B+ (Good)	7	60 or more but less than 70	
B (Above Average)	6	55 or more but less than 60	Second
C (Average)	5	50 or more but less than 55	
P (Pass)	4	40 or more but less than 50	Pass
F (Fail)	0	Below 40	Fail
AB (Absent)	0		

- i. For non-credit courses ‘Satisfactory’ or ‘Unsatisfactory’ shall be indicated instead of the letter grade and this shall not be counted for the computation of SGPA/CGPA.
- ii. The University shall decide on the grade or percentage of marks required to pass in a course and also the CGPA required to qualify for a degree taking into consideration the recommendations of the SRAs such as UGC, AICTE, MCI, BCI, NCTE, etc.
- iii. **Computation of SGPA and CGPA:** The computation of the Semester Grade Point Average (SGPA) and Cumulative Grade Point Average (CGPA) shall be done as follows:

- a. The SGPA is the ratio of the sum of the product of the number of credits with the grade points scored by a student in all the courses taken by a student and the sum of the number of credits in all the courses undergone by a student, i.e., $SGPA (S_i) = \frac{\sum(C_i \times G_i)}{\sum C_i}$; where C_i is the number of credits of the i th course and G_i is the grade point scored by the student in the i th course.
- b. The CGPA is also calculated in the same manner taking into account all the courses undergone by a student over all the semesters of a Programme i.e., $CGPA = \frac{\sum(C_i \times S_i)}{\sum C_i}$; where S_i is the SGPA of the i th semester and C_i is the total number of credits in that semester.
- c. The SGPA and CGPA shall be rounded off to 2 decimal points and reported in the transcripts.
- d. Transcript (Format): The Format for Transcripts shall be:

Course	Credit	Grade Letter	Grade Point	Credit Point (Credit X Grade)	SGPA (Credit Point/Credit)
First Semester (Semester-I)					
Paper-11	04	A	8	32	7.40
Paper-12	04	B	6	24	
Paper-13	04	A	8	32	
Paper-14	04	B+	7	28	
Paper-15	04/06	A	8	32	
Total	20			148	
Second Semester (Semester-II)					
Paper-21	04	A+	9	36	7.20
Paper-22	04	B+	7	28	
Paper-23	04	B+	7	28	
Paper-24	04	B	6	24	
Paper-25	04/06	B+	7	28	
Total	20			144	
Third Semester (Semester-III)					
Paper-31	04	B	6	24	7.00

Course	Credit	Grade Letter	Grade Point	Credit Point (Credit X Grade)	SGPA (Credit Point/Credit)
Paper-32	04	A	8	32	
Paper-33	04	B	6	24	
Paper-34	04	A	8	32	
Paper-35	04/06	B+	7	28	
Total	20			140	
Fourth Semester (Semester-IV)					
Paper-41	04	B+	7	28	7.40
Paper-42	04	A+	9	36	
Paper-43	04	A	8	32	
Paper-44	04	B	6	24	
Paper-45	04/06	B	6	24	
Total	20			144	
Grand Total	80	***	***	576	7.20
Semester I	Semester II	Semester III	Semester IV	CGPA = 7.20	
Credit: 20; SGPA: 7.40	Credit: 20; SGPA: 7.20	Credit: 20; SGPA: 7.00	Credit: 20; SGPA: 7.40	PASS	

- e. The formula of conversion from Grade Point to Percentage of Marks shall be: **Percentage of Marks = Grade Point X 9.50**. Each Mark foil shall mention the formula of conversion from Grade Point to Percentage of Marks; Table of Interval of % of Marks, Letter Grades and Grade Points, on its front page.
- f. Rank holders and **Gold Medallists**, as per the criterion developed by the competent authority, shall be decided from the list of examinees who clear all the semesters in the first attempt.

Medium of Instruction in the Examinations:

English shall be the medium of instruction and examination in the study programme of the University. However, teaching and examination in Language and Literature Course shall be in their respective language(s).

General Rules for Admission to the Examinations:

- i. Applications for admission to examinations shall be accompanied by a duly signed admission form by the Competent Authority with the following documents with prescribed fees:
 - a. A certificate to the effect that the student is eligible to appear in the examinations under the Ordinance/Regulations prescribed for the examination concerned.
 - b. The application for admission to the examination shall be accompanied by two copies of the student's latest photograph indicating his/her name and a self-attested copy of mark sheets of previous examination(s). The photograph in the admission form shall be authenticated by the Head of the Department.
- ii. Any student who has submitted his/her examination form, beyond the prescribed date as notified by the University for filling up of forms, shall **pay a late fee** along with the prescribed examination fees as notified from time to time, till the third day after the last date of such notification.
- iii. To calculate the late fee, the date of remittance of money by the student from the Bank/online deposit shall be taken as the date of receipt thereof by the University.
- iv. **Repeaters and students opting for improvement** in any papers, as per rules, shall fill in the examination form along with the regular students on dates notified in the prospectus or fixed by the University from time to time.
- v. **Cancellation of Admission/Examination:** The University shall cancel the Admission to Examination of a student if it is found that he/she is not eligible to appear in the examination but has obtained admission through misrepresentation, concealment, or a misstatement of facts.
- vi. The marks obtained by a student in Practical Courses/Dissertation/Internal Assessment in a semester shall be **carried over as such** in case he/she clears the examination partially. There shall be **no provision for improvement in Practical Courses/Dissertation/Internal Assessment Tests**. However, students failing to qualify in practical examinations in the fourth

semester shall be allowed to appear in subsequent End Semester Examination to clear the backlog.

- vii. A student who fails to appear for an examination or appears in an examination provisionally and is subsequently declared ineligible according to rules and regulations shall **not be entitled to a refund of fees once paid** to the University.
- viii. Similarly, a student shall not be entitled to a refund of the examination fees paid to the University:
 - a. If permission accorded to him to take an examination is subsequently cancelled as a result of misstatement of facts or suppression of facts or for want of relevant information in examination admission form; and
 - b. If he/she tries to obtain admission to an examination by making a false statement/Concealment of facts in his admission form.

Disqualification from Appearing in Examinations:

- i. The Academic Council shall exclude any student from an examination permanently or for a specific period for reasons to be recorded if it is satisfied that such student is not a fit and proper person to be admitted to the examination.
- ii. If a student after admission to an examination commits an immoral act or is discovered to have committed an immoral act, the academic council shall:
 - a. Cancel his/her candidature for that examination and order that his result be not declared;
 - b. Disqualify him/her permanently or for a specific period.
- iii. If a student, subsequent to the issue of Roll No. or after the appearance in an examination, is found to be ineligible to take the examination, his/her candidature shall be cancelled by the Controller of Examinations.
- iv. If a student, before issue of Roll No. or before appearance in an examination, is found to be ineligible to the examination his/her candidature shall be cancelled by the Controller of Examinations.
- v. A student seeking admission to a course/examination who:
 - a. Has been disqualified by this University or any other University/Board, shall not be eligible to appear in any University examination during the period of disqualification; and
 - b. Wilfully suppressed to disclose information pertaining to a previous disqualification incurred by him/her shall be disqualified for another period of two years.

Special Arrangements for Sick Examinees:

If a student falls ill or is suffering from a contagious disease, special arrangements shall be made by the Coordinator/Superintendent at the request of the student, subject to the production of

evidence/duly certified by the Medical Superintendent/Head of a Government Hospital/University Hospital, provided that for such special arrangement(s), the student shall pay an additional fee per paper fixed by the University from time to time.

Special Arrangement for Amanuensis (Writer/Scribe):

- i. A student shall be allowed the help of an amanuensis (writer/scribe) if he/she is:
 - a. Permanently blind or disabled from writing with his own hands, or
 - b. Blinded by an accident before the examination, or
 - c. Temporarily disabled from writing, on account of fracture of the arms, forearms or dislocation of the shoulders or wrists, etc.The student shall produce a certificate from the Chief Medical Officer/District Medical Officer of the district concerned to the effect that the student is unable to write his or her answer book because of the temporary disablement, or production of disability card issued by the Govt. of India.
- ii. The Controller of Examinations shall arrange for an amanuensis and inform the Coordinator/Superintendent of the centre concerned.
- iii. The amanuensis shall be a person having a lower level of education (at least 1 year) than the student.
- iv. The Superintendent shall arrange a suitable room for the disabled student and appoint an invigilator for him/her. The invigilator shall be changed every examination day.
- v. The student without a permanent disability shall pay the applicable fees for hiring the amanuensis (Writer/Scribe).
- vi. A student for whom an amanuensis has been engaged shall be given half an hour of extra time.

Restriction on Two Regular Programmes:

No student shall be permitted to pursue two regular programmes simultaneously in one academic year till the regular course is completed and issued an Institution Leaving Certificate.

Registration and Renewal of Registration:

The registration of the student(s) to University for all programmes shall be completed within 45 days from the last date of admission.

If a student fails to complete his/her course within the maximum specified duration; OR rejoins a course after a gap of three years from his/her last examination from this University, shall have to renew the registration on payment of fee, as notified by the University from time to time.

Punishment for Unlawful Acts During Examinations:

Punishment for Unlawful Acts during Examination shall be as per the Examination Ordinance of the Arunachal Pradesh University.

Ph.D. Programmes

The Arunachal Pradesh University offers Ph.D. programmes in various disciplines. The University shall advertise PhD admission notification in advance on its website and through advertisement in at least one (1) local/state newspaper specifying the number of seats for admission, subject/discipline-wise distribution of available seats, criteria for admission, the procedure for admission, and all other relevant information for the candidates.

The Issue and submission of application for admission to the various Ph.D. programmes will be through online mode. The candidates seeking admission need to visit the university website www.apupsg.ac.in.

The university offers Ph.D. programmes in the following departments

- | | | |
|----------------|-------------------|------------------------|
| 1. Commerce | 5. Tribal Studies | 9. Computer Science |
| 2. Economics | 6. English | 10. Mass Communication |
| 3. Education | 7. Hindi | 11. Sociology |
| 4. Social Work | 8. Mathematics | |

Some Important points for Ph.D. admissions

- Candidates seeking admission to the PhD programme listed above must have a Master's degree in the relevant subject with a minimum of 55% marks (50% for SC/ST/OBC/PwD candidates) or its equivalent grade in the UGC 10-point scale. For Tribal Studies, candidates must have a Master's degree in any social science discipline with a minimum of 55% marks (50% for SC/ST/OBC/PwD candidates) or its equivalent grade in the UGC 10-point scale.
- **Ph.D. in Education:** Applicants must hold a Master's degree in Education (M.A. Education/M.Ed.) with the minimum (55%) percentage or grade as stipulated by the University Grants Commission (UGC) and the respective university norms, along with meeting any additional criteria such as entrance tests or interviews as required. (Relaxation of marks in admission for different reserved categories as per the state govt.'s norms)
- The University will conduct Arunachal Pradesh University Ph.D. Entrance Test (APUPET). It will be conducted through a 2-stage process, i.e. Written Entrance Test and Viva-voce. The Entrance Test syllabus shall consist of 50% of research methodology, and

50% shall be subject-specific. Students who have secured 50% marks in the entrance test are eligible to be called for the interview.

- A relaxation of 05% marks will be allowed in the entrance examination for the candidates belonging to SC/ST/OBC/Differently-Abled Category, Economically Weaker Section (EWS), and other categories of candidates as per the decision of the UGC from time to time.
- Based on the UGC Public Notice No.F.4-1(UGC-NET Review Committee)/2024 (NET)/140648 dated 27.03.2024; Applicants who have qualified UGC-NET examinations post June 2024 are exempted from the Written Test of APUPET-2025 and can be called for Viva-voce.
- Those students who have cleared NET prior to 2024 will have to appear for APUPET-2025 Written Test.
- The University may decide the number of eligible students to be called for an interview based on the number of Ph.D. seats available.
- The dates to the Ph.D. entrances, admission and other such information has been tentatively provided in the academic calendar given in the early section of this brochure. The dates may subject to change and in that case, it will be notified in the university website www.apupsg.ac.in

Fee structure for PhD programme (Non-Lab Oriented)

Fee Component	Amount (₹)
Admission Fee	7,400/- (to be paid one-time at the time of admission)
Odd Semester Fee	
1. Semester continuation fee	1,000/- (per semester)
2. Development fee	1,000/-
3. Students' Union Fee	400/-
4. Games & Sports Fee	400/-
5. Youth Welfare Fee	300/-
6. Magazine Fee	200/-
7. Transportation Fee	300/-
TOTAL	3,600/-
Even Semester Continuation Fee	1,000/-
Synopsis Fee	1,000/- (to be paid during synopsis submission)
Registration Fee	6,500/- (to be paid after the approval of synopsis)
Extension Fee	3,000/- (to be paid after the approval of the extension)
Re-registration Fee	8,500/- (to be paid after the approval of the re-

	registration)
Library Fee	2,000/- per annum
Caution Money (Refundable)	2,000/- (to be paid one-time at the time of admission)
Thesis Submission & Evaluation Fee	8,000/- (to be paid at the time of thesis submission)
Total Amount (to be paid at the time of admission)	14,000/-

Anti-Ragging Declaration and Mandatory Online Registration

At Arunachal Pradesh University, we are committed to fostering a safe, inclusive, and respectful environment for all students. In accordance with the guidelines of the University Grants Commission (UGC), every student is required to submit an **online anti-ragging undertaking** at the beginning of each academic year. This initiative is part of our zero-tolerance policy toward ragging and ensures that students and their guardians are aware of the consequences of such behavior.

Steps to Register:

1. Visit www.antiragging.in
2. Select “University” as your institution type
3. Fill in the details of the student and parent/guardian
4. Provide information about the university, course, and contact details
5. **Submit the Form** after reviewing all details, click **Submit**. You will receive a **Reference Number** and a **PDF copy** of the affidavit via email.
6. **Forward the Affidavit** Email the PDF to the university’s anti-ragging cell at antiraggingcell@apupsg.ac.in

Complaint Registration-

1. University-Level Reporting

- In Person: Approach the Anti-Ragging Committee
- Email: Send a detailed complaint to [\[antiraggingcell@apupsg.ac.in\]](mailto:antiraggingcell@apupsg.ac.in)
- Online Portal: Submit a report via the university’s grievance redressal system in the University website.
- Anonymous Drop Box: Use the physical complaint box located in academic block.

2. National Anti-Ragging Helpline

- Toll-Free Number: 1800-180-5522 (24x7)
- Email: helpline@antiragging.in
- Online Complaint Form: www.antiragging.in/complaint_register_form.html

- Mobile App: Download the UGC Anti-Ragging App from Google Play Store

All complaints will be treated with strict confidentiality and addressed in accordance with UGC regulations and institutional procedures.

Anti-Tobacco Policy

Arunachal Pradesh University is firmly committed to upholding the health, safety, and well-being of its academic community. In accordance with the Cigarettes and Other Tobacco Products Act (COTPA), 2003, and national public health directives, the university has instituted a dedicated **Anti-Tobacco Cell** to implement and monitor a **zero-tolerance policy** on the use, possession, and distribution of tobacco products within campus premises. Use, possession, or distribution of tobacco products—including cigarettes, e-cigarettes, gutka, and related substances—is strictly prohibited on all university premises.

Violations of this policy will attract strict disciplinary action, including monetary fines, suspension of campus privileges, or other penalties as outlined in the university’s code of conduct. Repeat offenses may lead to more severe consequences, including suspension or expulsion.

By fostering a tobacco-free environment, Arunachal Pradesh University aims to cultivate a culture of responsibility, respect, and wellness. All members of the university community are expected to comply with this policy and contribute to maintaining a clean, safe, and healthy campus.

This policy applies to all students, staff, faculty, and visitors.

Complaint Registration

To report violations of the tobacco policy:

- Email: Submit a written complaint to the Anti-Tobacco Cell at **antitobaccocell.apu.psg**
- In Person: Visit the Anti-Tobacco Cell office during working hours.
- Anonymous Reporting: Use the university’s grievance drop box or online portal
- National Helpline: For cessation support or to report public violations, call the National Quit line at 1800-11-2356 or give a missed call to 011-22901701

All complaints will be treated with confidentiality and addressed in accordance with institutional procedures.

Non-Teaching Staff of the University

SL NO	NAME OF BRANCH	STAFF ASSIGNED	NATURE OF DUTY
1	VICE CHANCELLOR SECRETARIAT	<ol style="list-style-type: none"> 1. Shri Joseph Moyong, PA 2. Ms. Mary Perme, MTS 3. Mr. Rinchin Tsering, Driver 4. Mr. Anang Saroh, Contingency 	All duties/activities under the Office of the Hon'ble VC
2	REGISTRAR OFFICE	<ol style="list-style-type: none"> 1. Mr. Konga Yongam, LDC 2. Mr. Bijing Saroh, Driver 3. Mr. Keken Burang, Contingency 4. Ms. Yater Jamoh, Contingency 	All duties/activities under the Office of the Registrar
3	CONTROLLER OF EXAMINATIONS OFFICE	<ol style="list-style-type: none"> 1. Mr. Thomas Jamoh, Lab Asstt. 2. Mr. Roman Gamnoh, Driver 3. Ms. Oyimang Yirang, Contingency 	All duties/activities under the Office of the CoE
4.	ASSISTANT REGISTRAR (Administration, Establishment, Finance/Accounts, Audit, Estate, Vehicle, RTI, PR)	<ol style="list-style-type: none"> 1. Mr. Anil Nangkar Assistant Registrar 2. Mr. Bapu Tarang, UDC 3. Ms. Yamem Jamoh, MTS 4. Ms. Minam Yirang, Contingency 	All duties/activities under the Office of the Registrar and AR (Finance and Accounts)
5	ASSISTANT REGISTRAR (PIO, Academic, Examinations, Research Projects, Registration, UGC, IQAC, Meetings, Conferences, Outreach Programmes, Library, IT Cell)	<ol style="list-style-type: none"> 1. Mr. Likha Rinchin, Assistant Registrar 2. Ms Ringku Ratan, MTS <p style="text-align: center;"><u>ACADEMIC</u></p> <ol style="list-style-type: none"> 3. Ms. Chigo Basar, UDC 4. Ms. Tumgam Riba, Contingency <p style="text-align: center;"><u>EXAMINATIONS</u></p> <ol style="list-style-type: none"> 5. Ms Hukter Basar, UDC 6. Mr. Kadum Komut, LDC 7. Mr. Gemin Apum, MTS 	<p>All duties/activities under the Office of the CoE and AR (Academic and Examinations)</p> <p>All duties/activities under the Office of the CoE and AR (Academic and Examinations)</p>

6	ESTABLISHMENT BRANCH	1. Mr. Marto Ronya, UDC 2. Mr. Rajesh Tamang, MTS 3. Ms Mileng Medo, Contingency	All duties/activities under the Office of the Registrar and AR (Establishment)
7	COMPUTER CENTRE/UNIVERSITY WEBSITE, IT	1. Mr. Tumto Bagra, System Analyst 2. Mr. Miding Ering, MTS	All duties/activities under the System Analyst
8	STORE	1. Mr. Buk Mitkong, LDC 2. Mr. Olik Tamut, MTS 3. Mr. Kani Perme, Contingency	All duties/activities under the Office of the Registrar and AR (Finance and Accounts)
9	LIBRARY	Ms. Minam Ngukir, MTS	Duty as assigned in the Library
10	COMMERCE & HINDI DEPARTMENT	Ms. Tana Yaya, MTS	Duty as assigned by HoD of the department
11	TRIBAL STUDIES DEPARTMENT	Mr. Lenjing Panyang, MTS	Duty as assigned by HoD of the department
12	ECONOMICS DEPARTMENT	Mr. Solomom Taki, MTS	Duty as assigned by HoD of the department
13	SOCIAL WORK DEPARTMENT	Mr. Jumkar Nada, MTS	Duty as assigned by HoD of the department
14	EDUCATION & ENGLISH DEPT.	Mr. Tayin Tatin, MTS	Duty as assigned by HoD of the department
15	COMPUTER SCIENCE & MATHEMATICS DEPARTMENT	1. Mr. Tenzing W. Salingpa, Lab Asstt. 2. Mr. Bada Moyong, MTS	Duty as assigned by HoD of the department
16	SOCIOLOGY AND MASS COMMUNICATION	Ms. Milonty Perme, MTS	Duty as assigned by HoD of the department
17	BUS SERVICE	1. Mr. Tingham Loham, Driver 2. Mr. Gumin Apum, MTS	Driver and Bus Assistant
18	RECEPTION	Ms. Lijum Geyi, MTS	
19	GATEKEEPER	1. Mr. Dunyo Libang, MTS 2. Mr. Miding Perme, Contingency	

20	INNOVATION CENTRE	<ol style="list-style-type: none"> 1. Ms. Tungam Riba, Contingency 2. Ms. Yater Jamoh, Contingency 	Duty as assigned by VC
----	-------------------	--	------------------------

LIST OF GAZETTED HOLIDAYS FOR THE YEAR 2026

Sl. No.	Date & Month	Day	Gazetted Holiday
1	1st January 2026	THURSDAY	New Year's Day
2	14th January 2026	WEDNESDAY	Makar Sankranti
3	26th January 2026	MONDAY	Republic Day
4	20th February 2026	FRIDAY	Statehood Day
5	4th March 2026	WEDNESDAY	Holi
6	21st March 2026	SATURDAY	Id-ul-Fitr
7	3rd April 2026	FRIDAY	Good Friday
8	15th April 2026	WEDNESDAY	Bohag Bihu
9	1st May 2026	FRIDAY	Buddha Purnima
10	15th August 2026	SATURDAY	Independence Day
11	2nd October 2026	FRIDAY	Mahatma Gandhi's Birthday
12	19th October 2026	MONDAY	Dussehra (Mahanavami)
13	20th October 2026	TUESDAY	Dussehra
14	8 th November 2026	SUNDAY	Diwali (Deepavali)
15	24th November 2026	TUESDAY	Guru Nanak's Birthday
16	1st December 2026	TUESDAY	Indigenous faith day
17	25th December 2026	FRIDAY	Christmas Day



A student being conferred with the degree by Hon'ble Chancellor, Lt. Gen Kaiwalya Trivikram Parmaik at the convocation ceremony



Book release during APUFEST – 2026



Vice-Chancellor Prof. Tomo Riba with Chief Minister Pema Khandu



Hon'ble Chancellor, Commissioner Education, DC (East Siang) along with VC and members of APU Family



National Press Day celebration at APU with media fraternity and administrative officers of East Siang



Outreach Program



Village Adoption Program



In respect of victims of Pahalgam Terror Attack



Departmental seminar of Department of Commerce



Theatre workshop conducted by Department of Hindi



Social Service at Giidi Notko



DR DELEGATION FROM DEPARTMENT OF MASS COMMUNICATION, ARUNACHAL PRADESH UNIVERSITY INTERACT WITH HON'BLE IPRP&S MINISTER PU B. LALCHHANZOVA